

INSTALLATION GUIDELINES

INSTALLATION OF STANDING SEAM ROOFING SHEETS

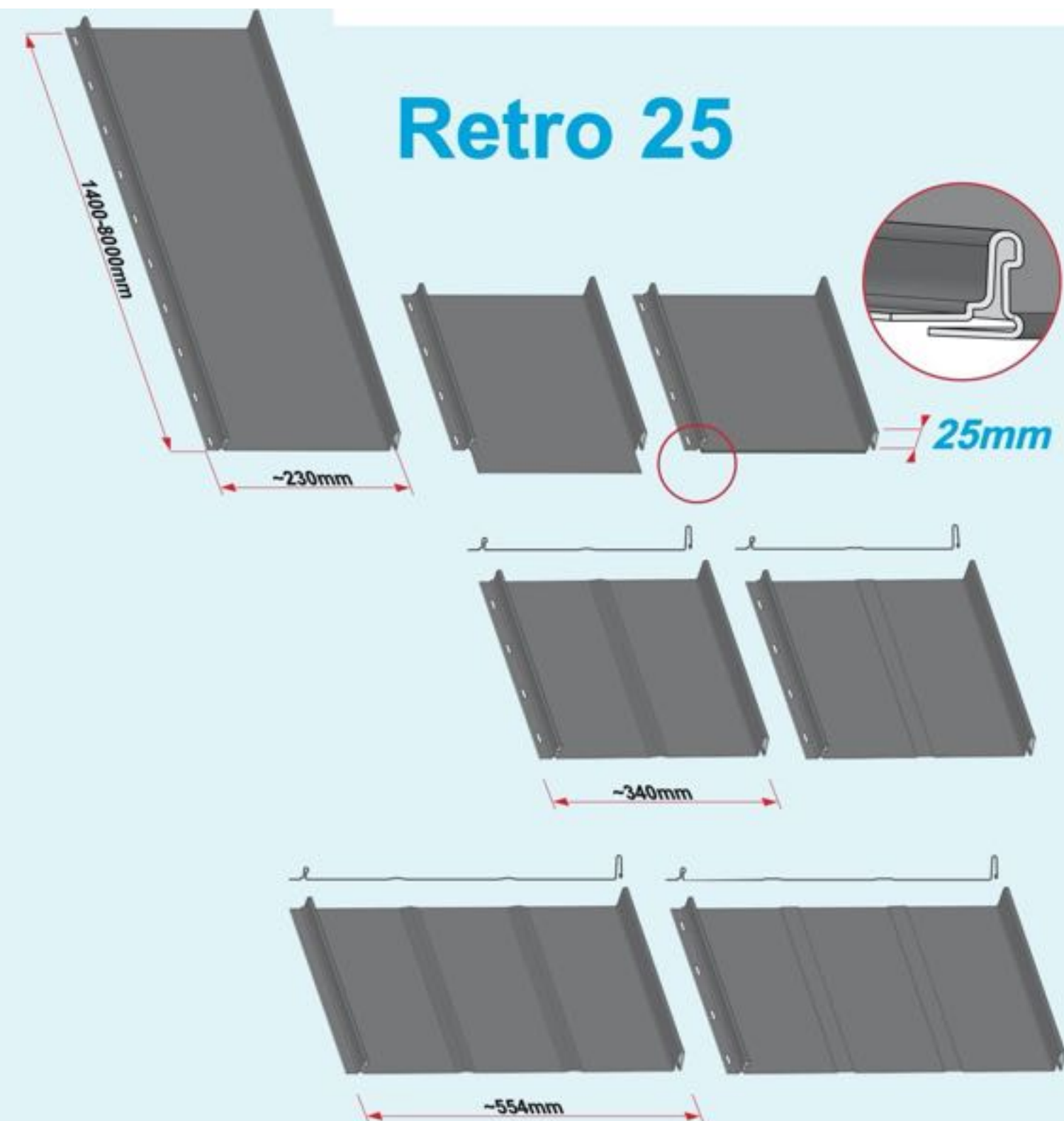

Retro 38

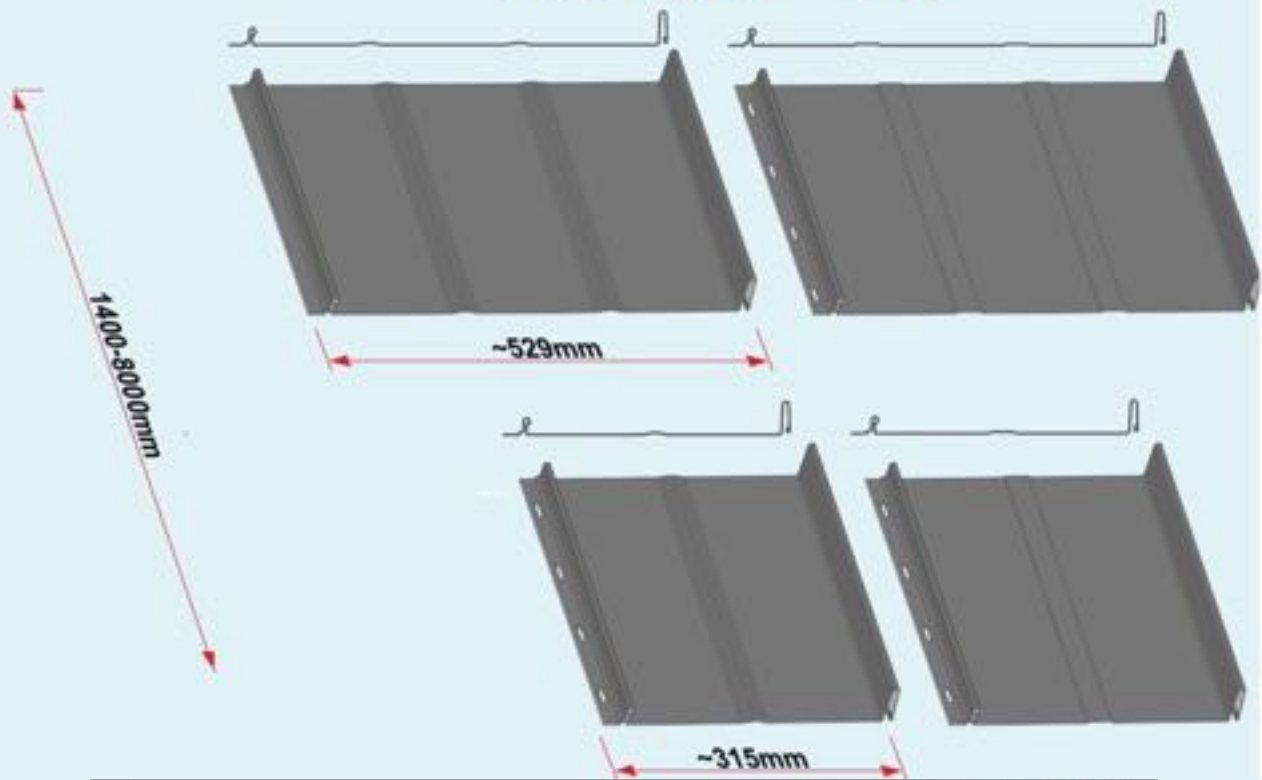

HIGH-TECH

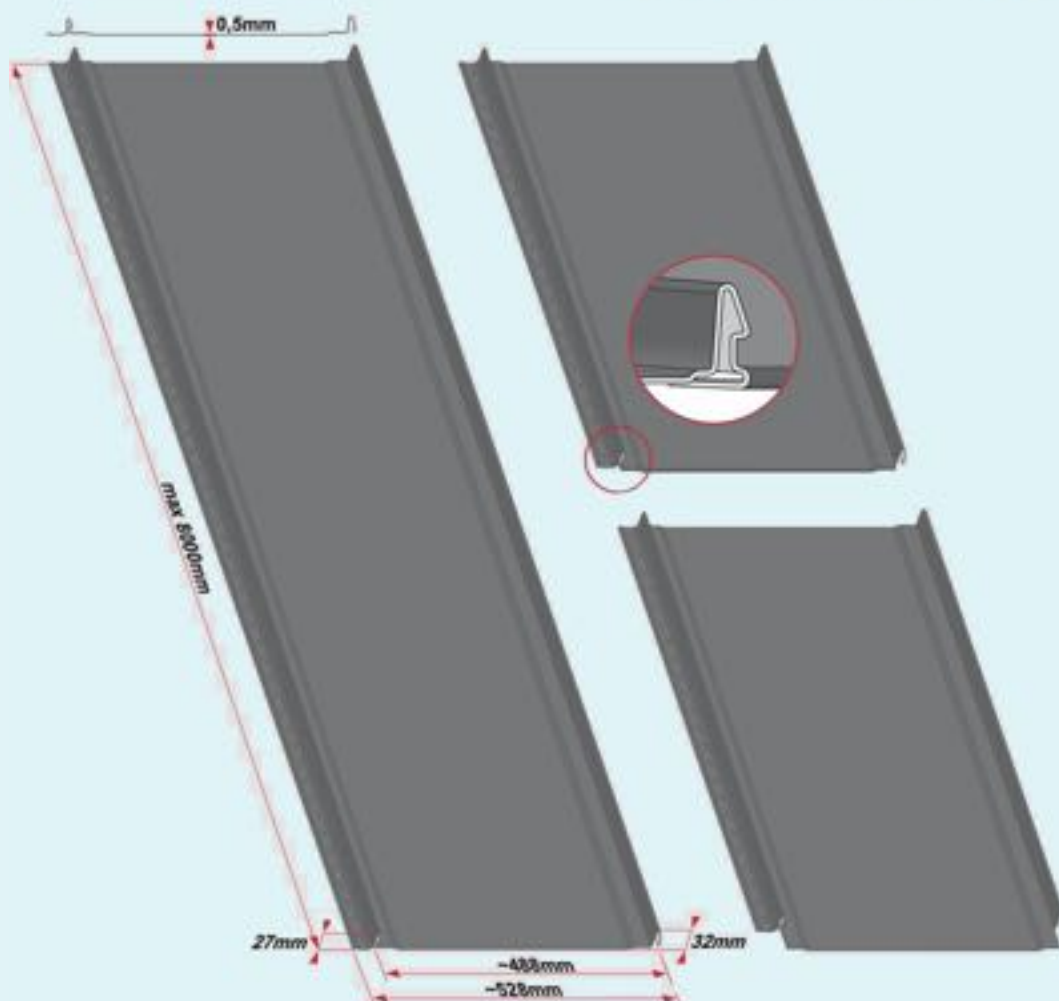

USE cold cutting methods !



RECOMMENDED TOOLS:

- TIN SNIPS
- NIBBLER or METAL CUTTING JIGSAW
- Turn-Up Tool
- Clinching Pliers
- Rubber Hammer

1. INSTALLATION STEP BY STEP

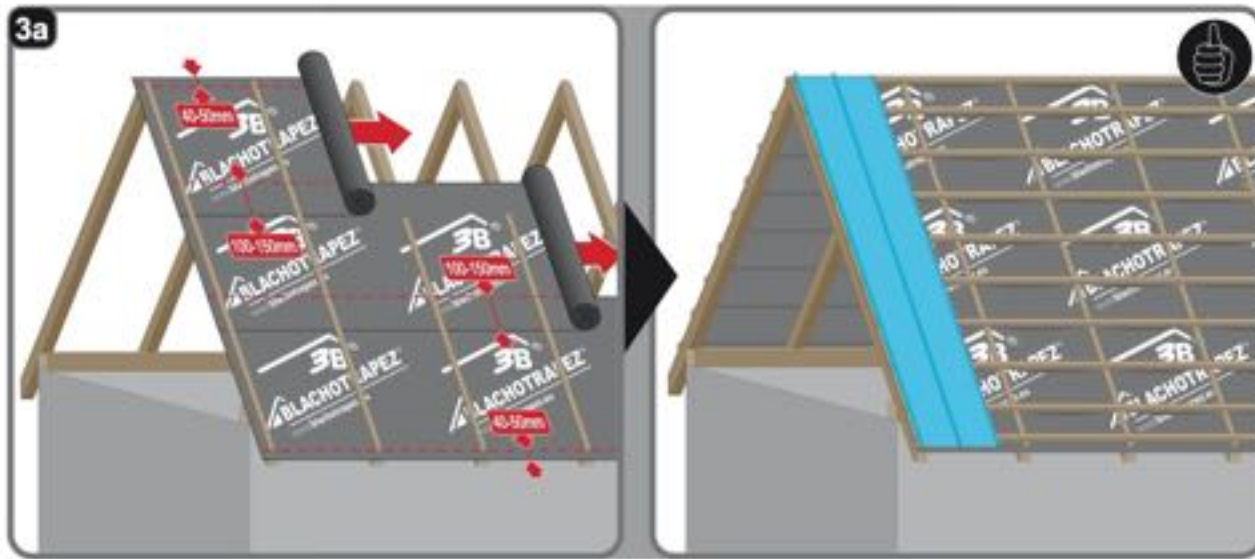

MEMBRANE
WITH
BATTENS

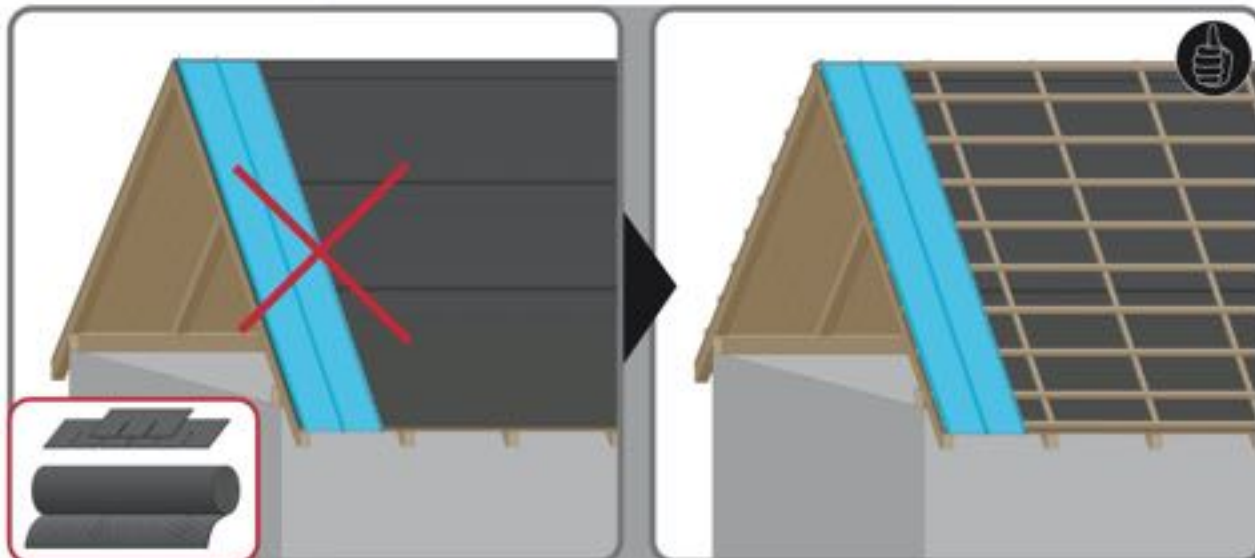

NOT TO BE
INSTALLED
DIRECTLY
ONTO
BOARDS
AND OR
REGULAR
MEMBRANE/
FELT

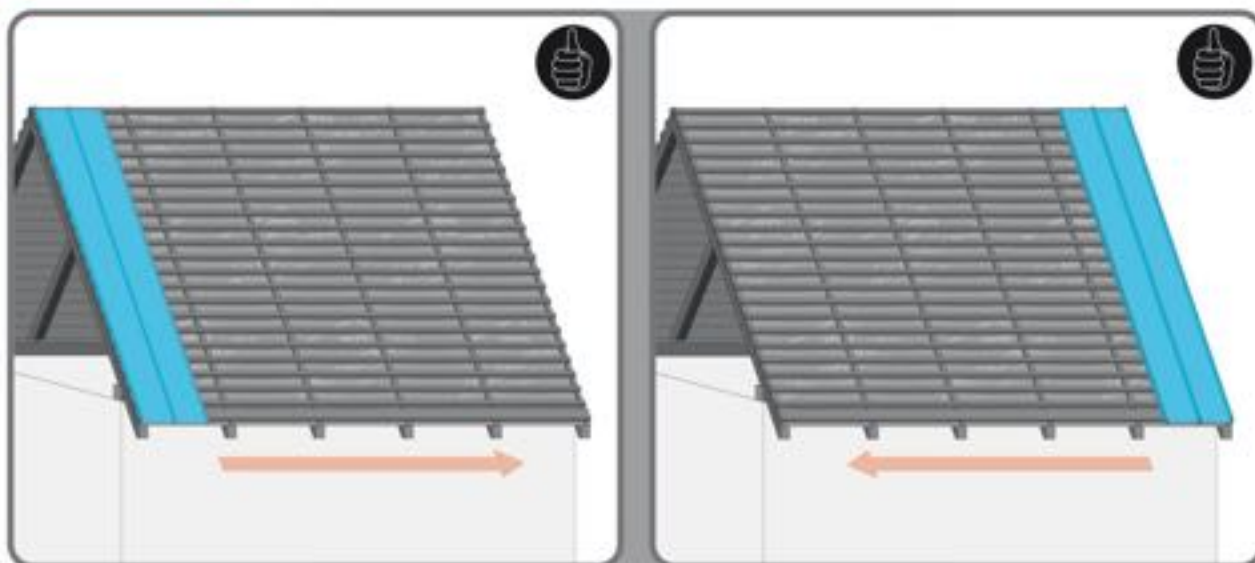

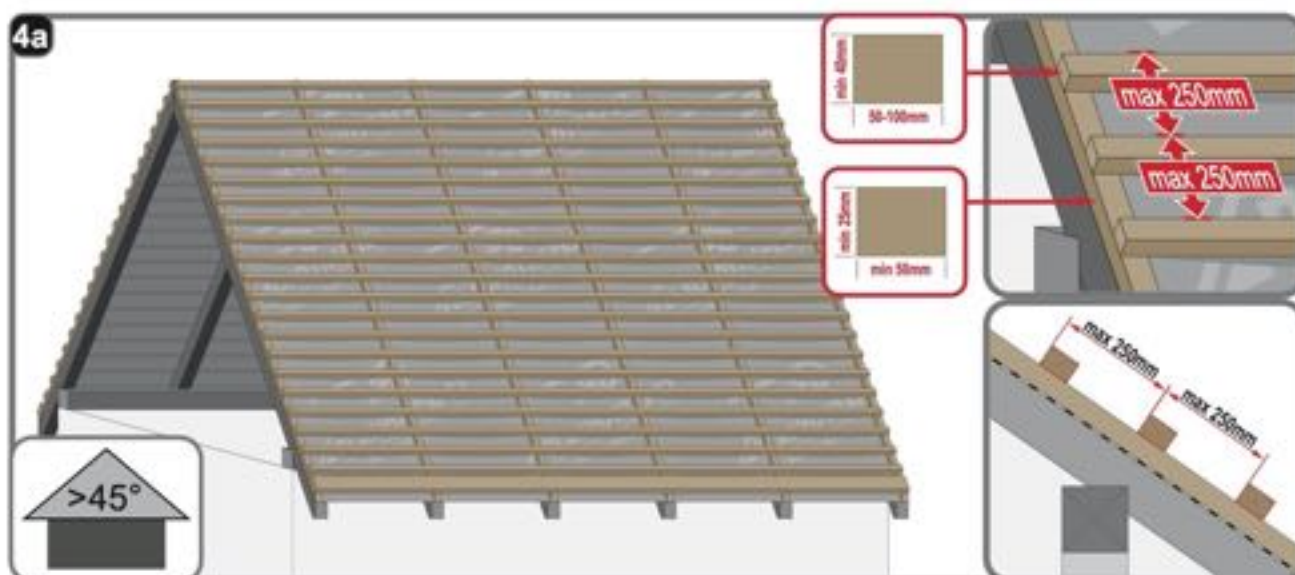

Counter
Battens on top
of membrane

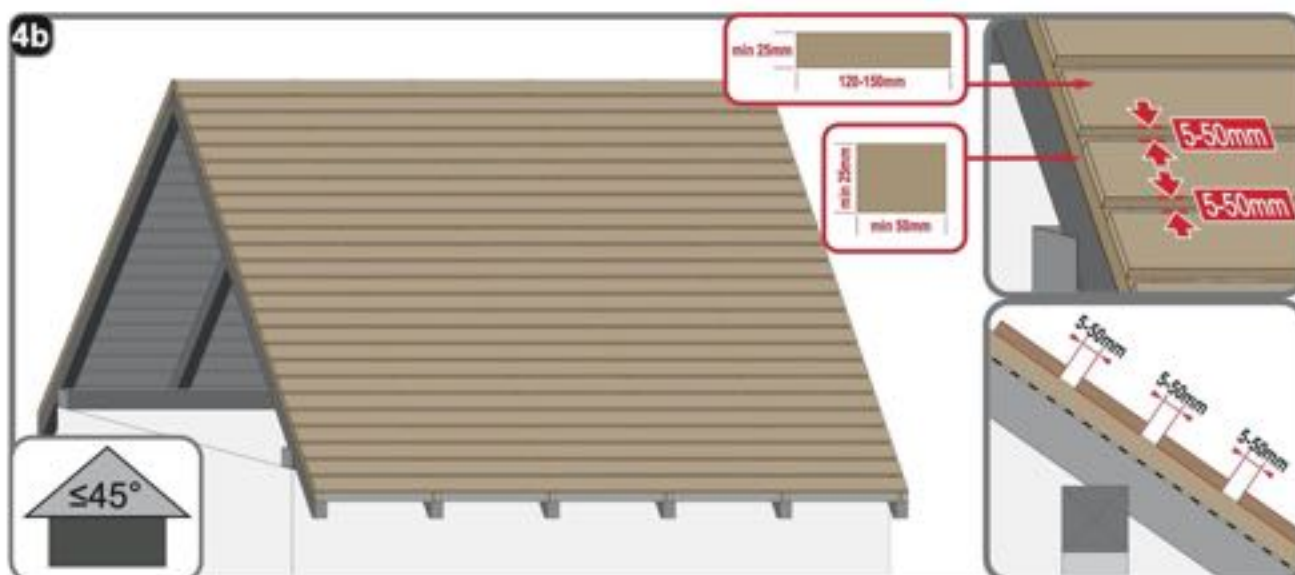

Sarking boards
on top of
membrane

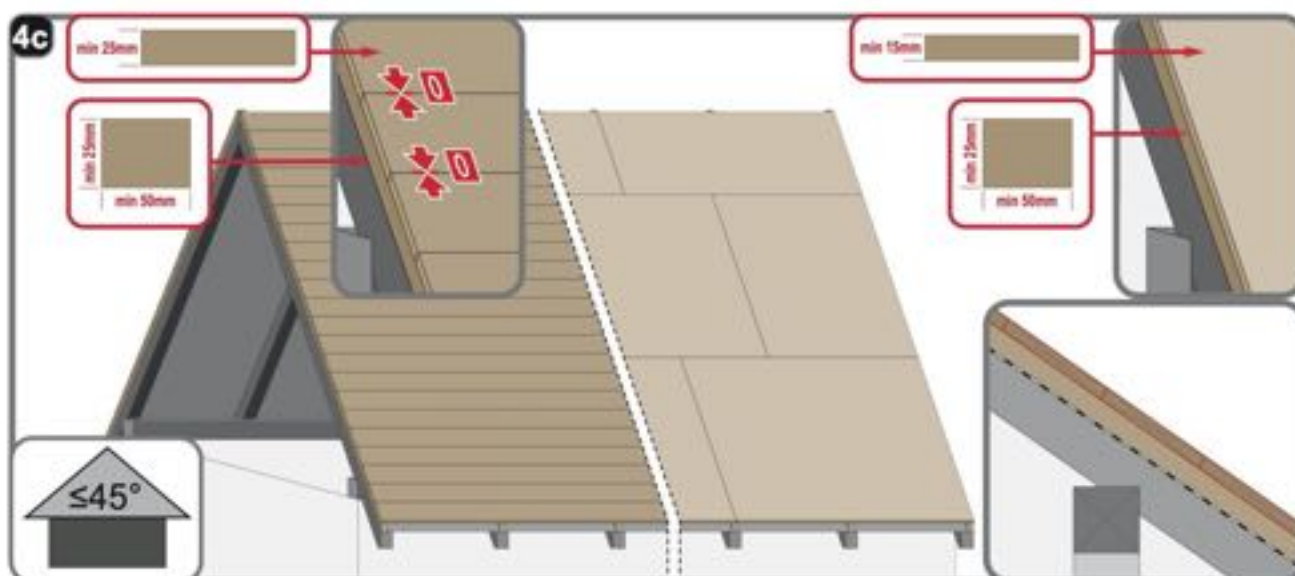

Boards (e.g.
OSB3, Ply...)

3 OPTIONS

STANDING SEAM INSTALLATION GUIDE

5a

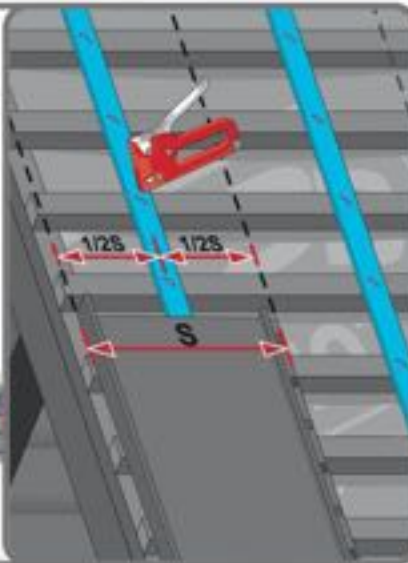

INSTALLATION ON TOP OF BATTENS
(silencing strips optional)

5b

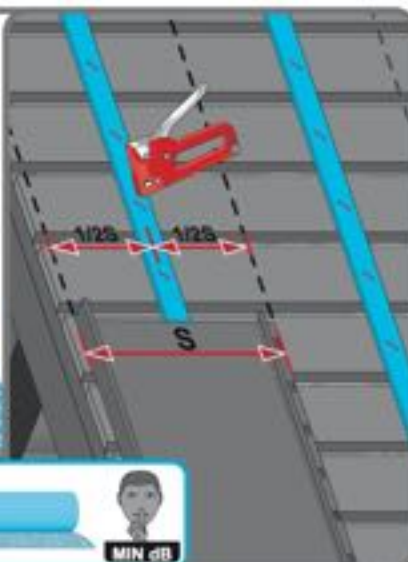
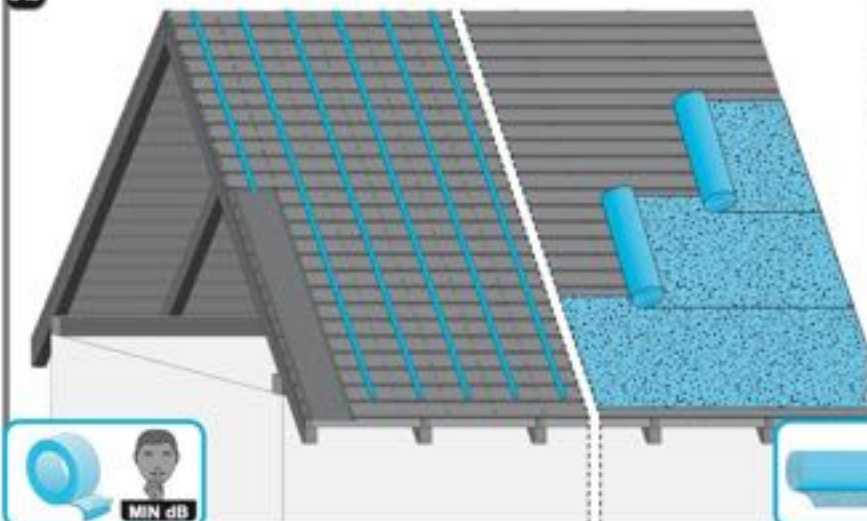

INSTALLATION ON TOP OF SARKING BOARDS
(silencing strips and metal roof membrane optional)

5c

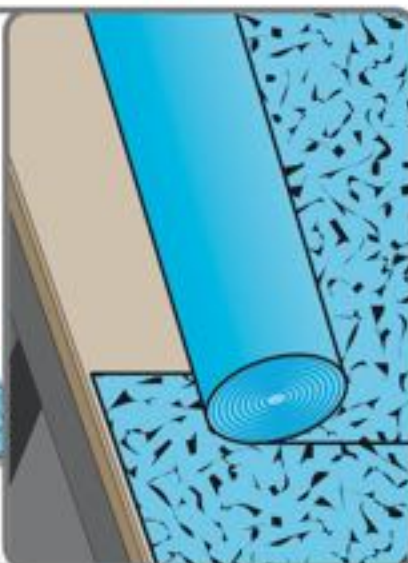
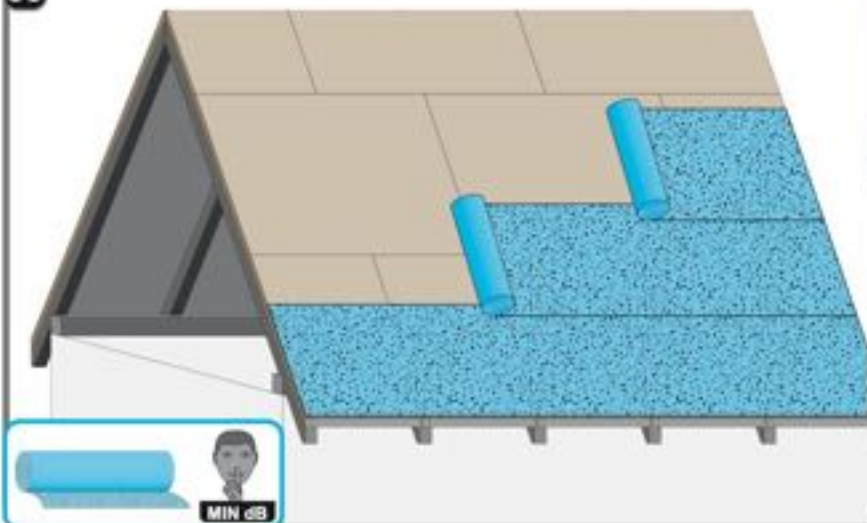

INSTALLATION ON TOP OF BOARDS
(metal roof membrane as a condensation barrier recommended)

PREPARING

1ST SHEET
FOR
INSTALLATI
ON

7b

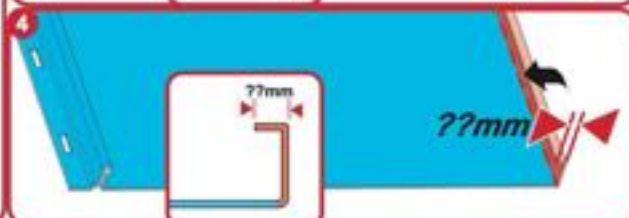
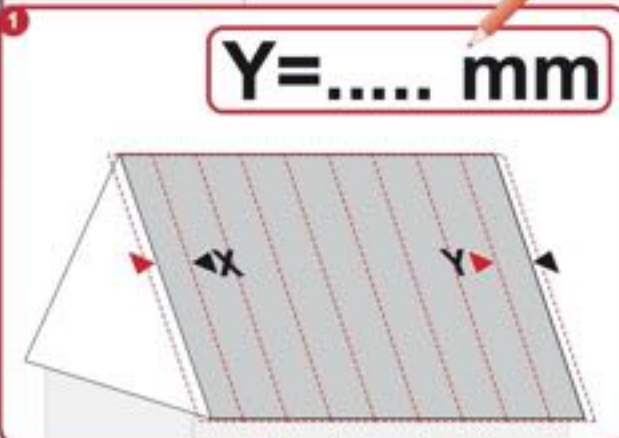
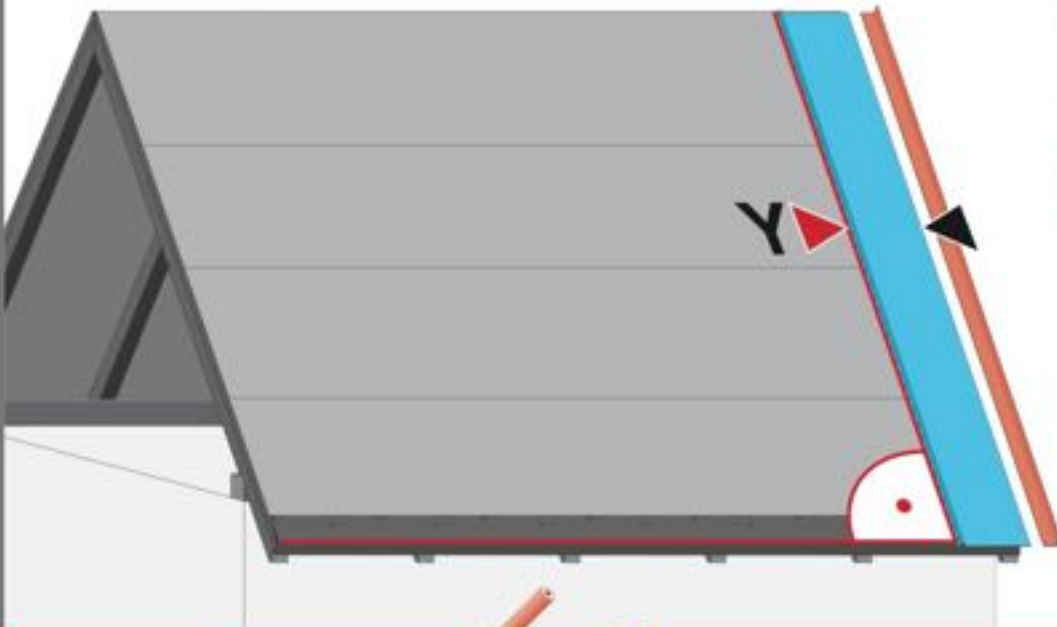

STEP 4 optional
depending on
BARGE BOARD
FLASHING KIT

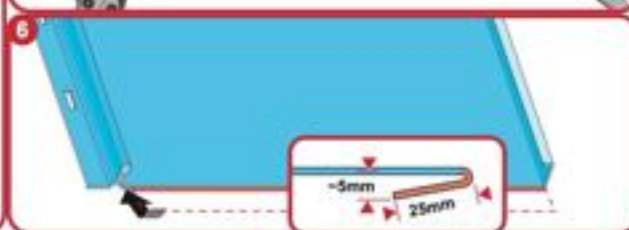
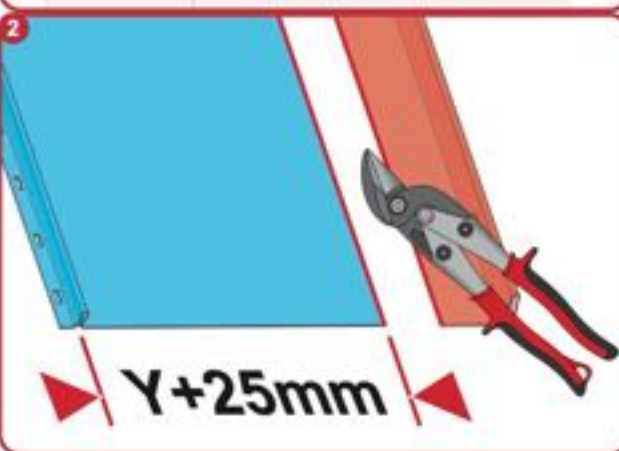

2. FLASHING (DRIP EDGE)

6

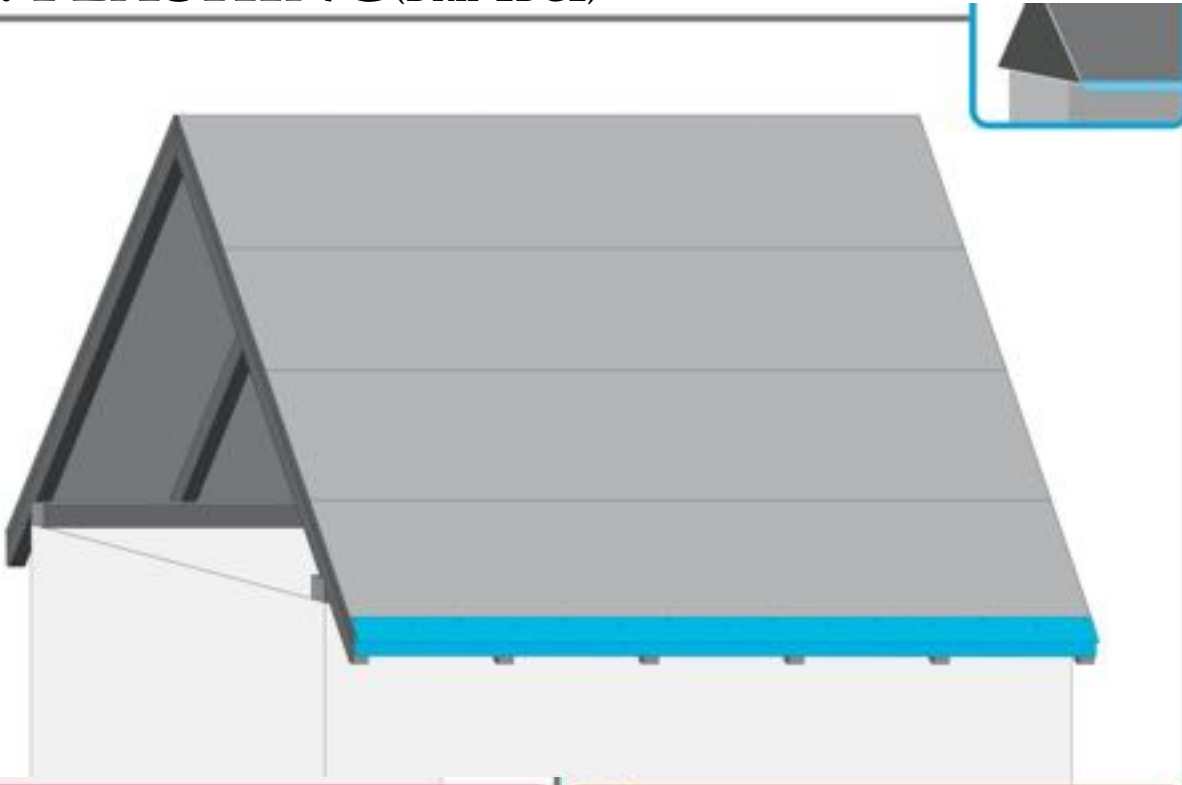

EAVES
DRIP
EDGE
STARTER

(various options
available)

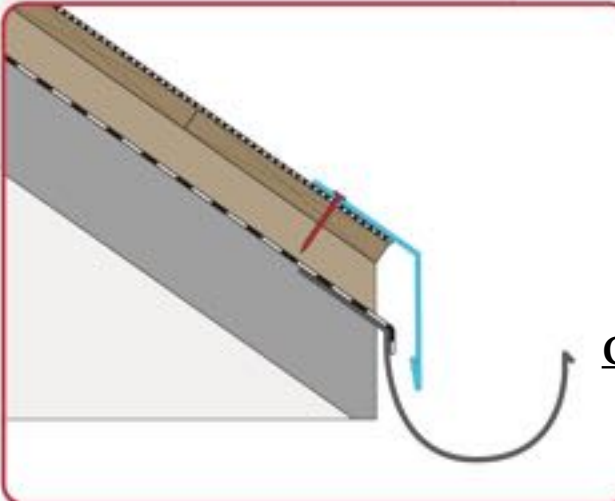

OR

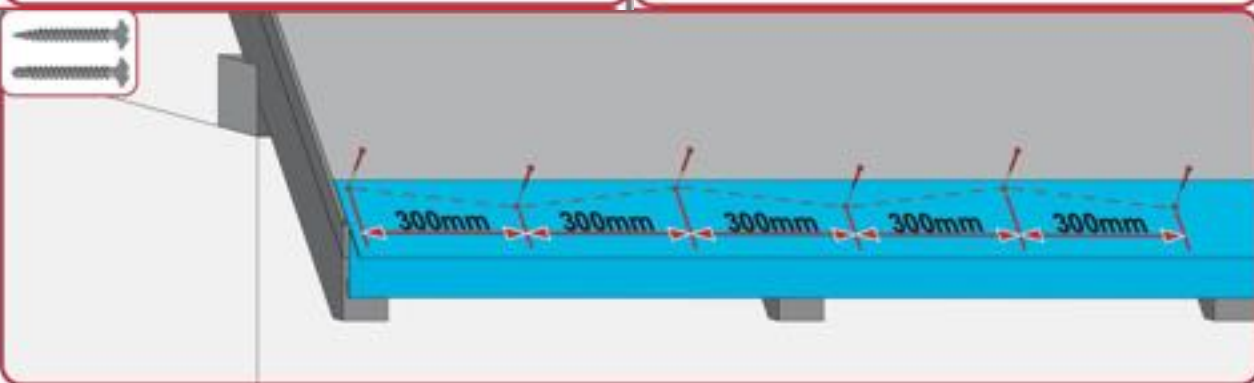
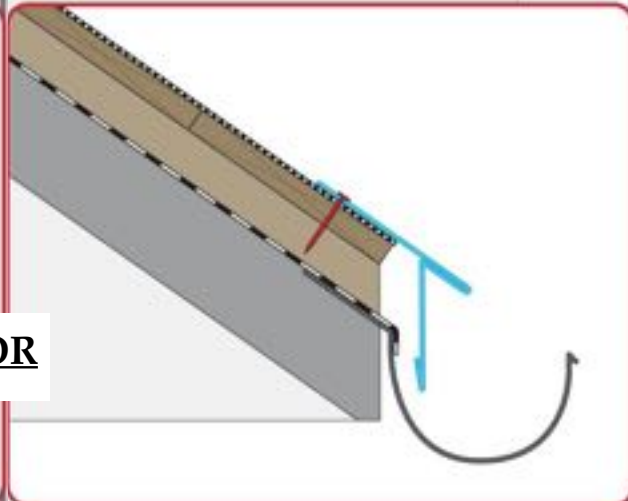

3. LAYING OF SHEETS (straigh roof)

7a



FITTING
1st SHEET

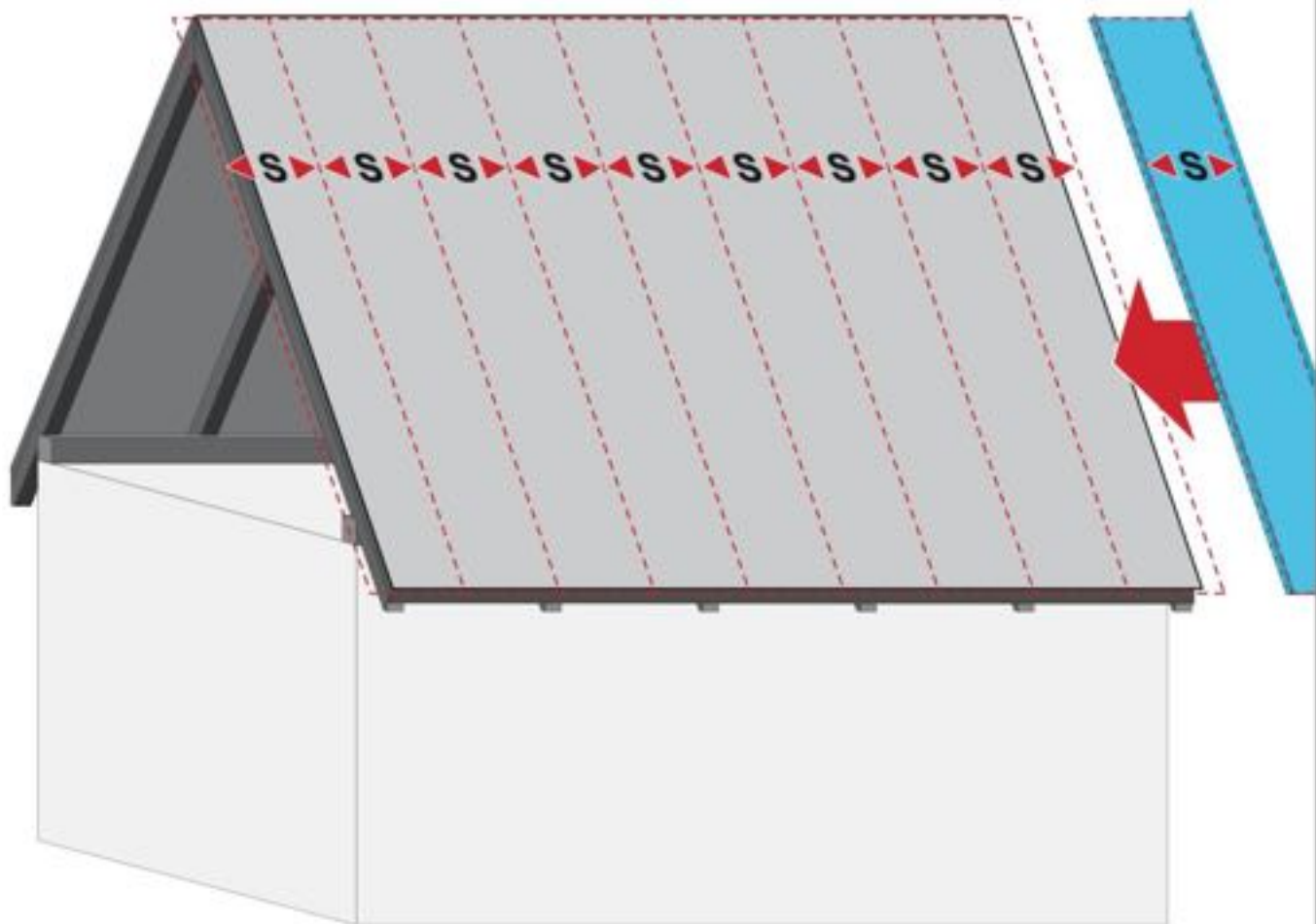

$X=Y$

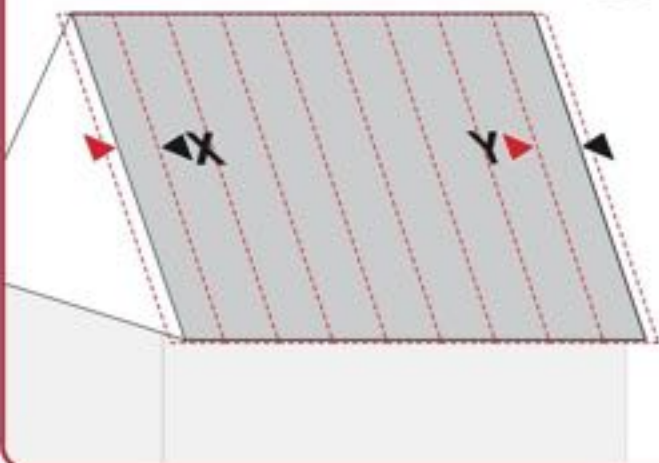

$X \neq Y$

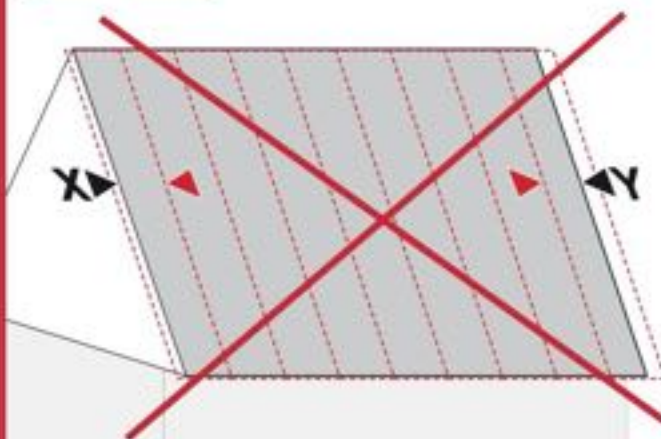

7c

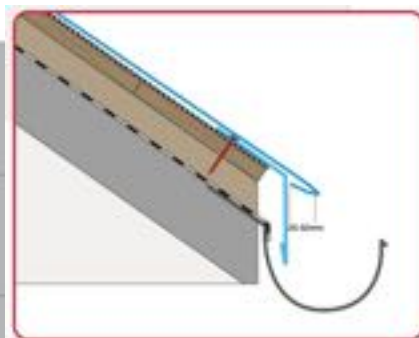

OR

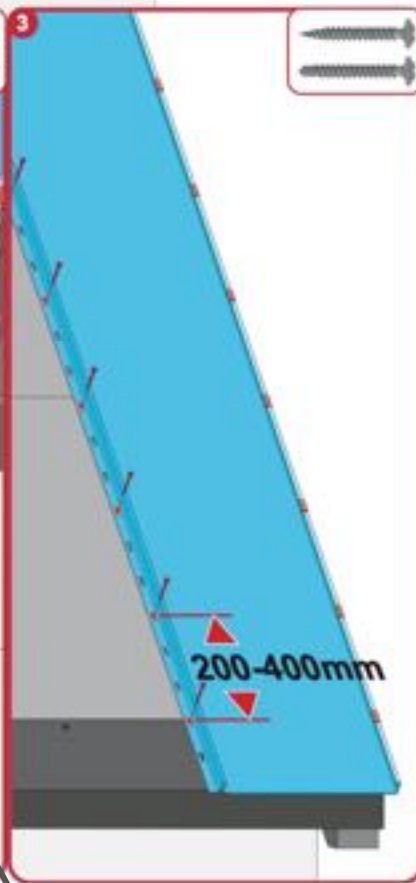
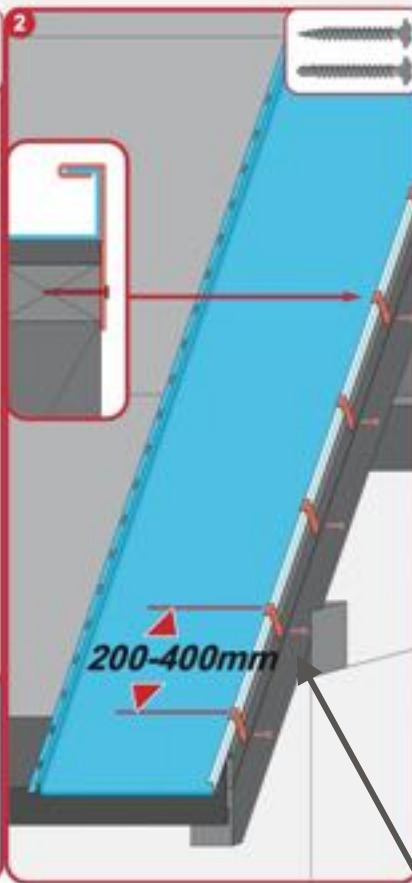
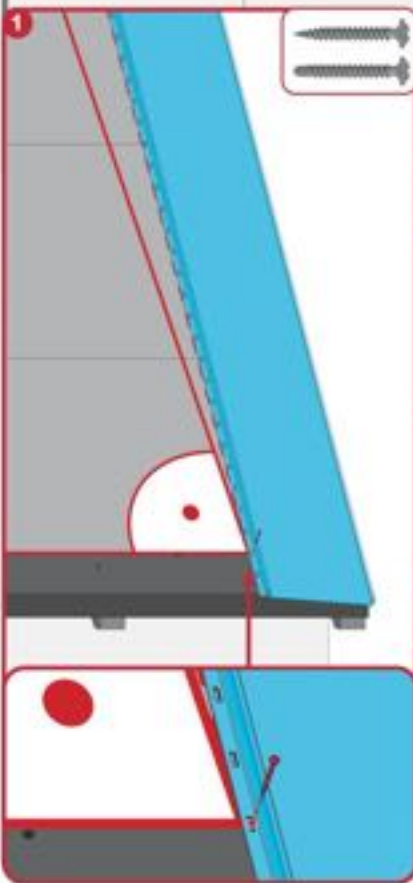
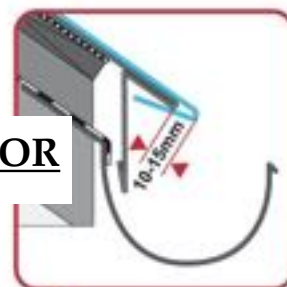

1st SHEET fixings
made from offcuts or
Coiled Strap(e.g.
SIMPSON STRONG-TIE)

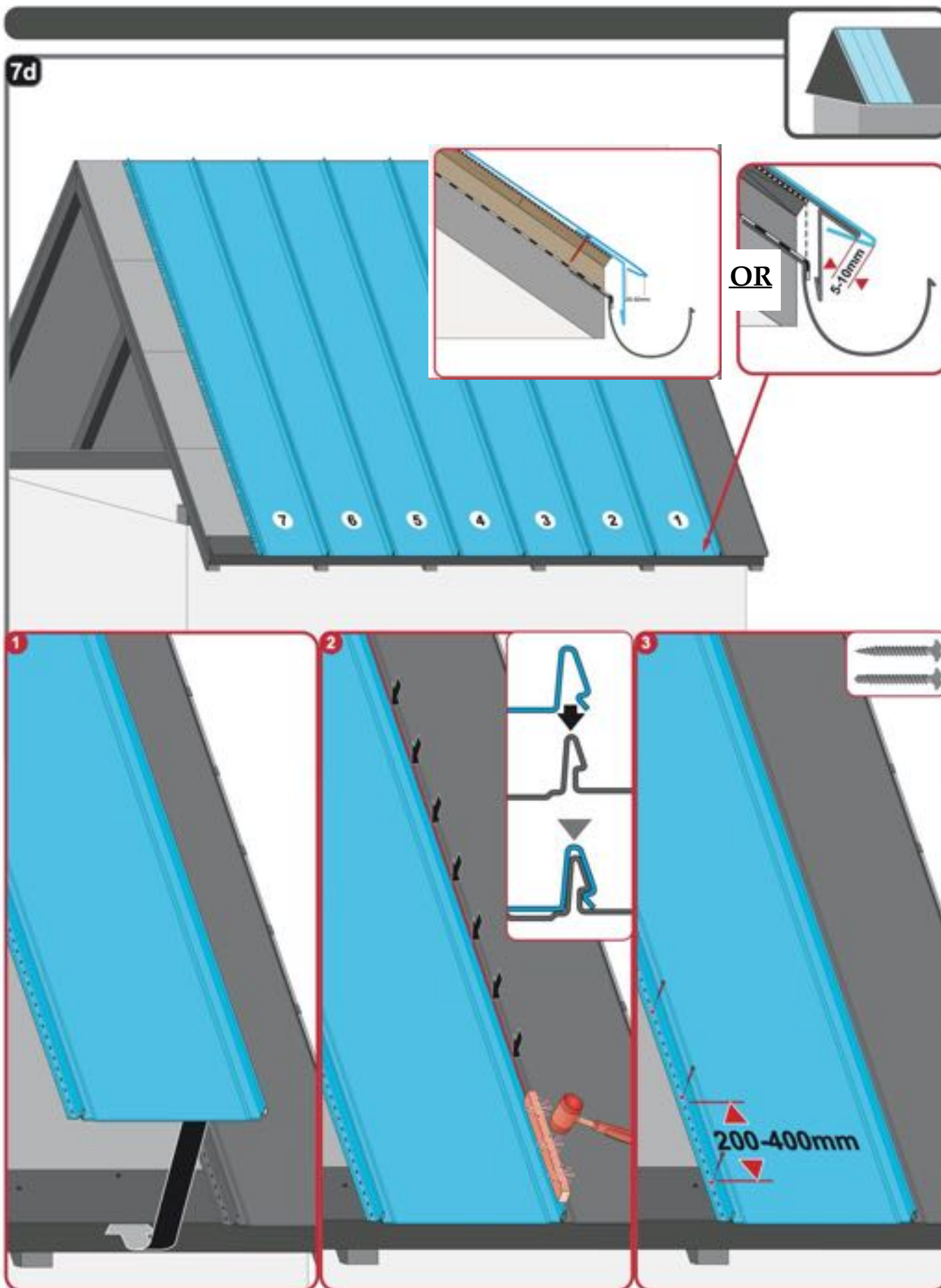

**FITTING
all sheets**

7e

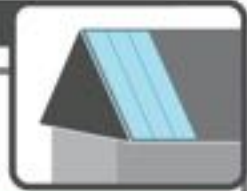

FITTING
last sheet

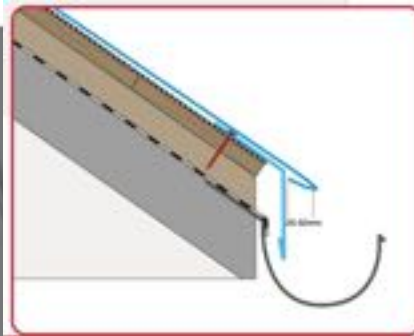

OR

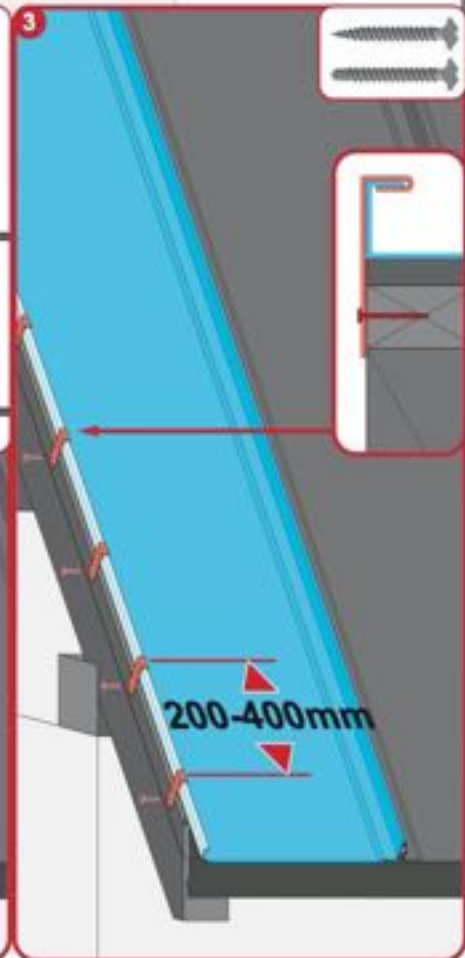
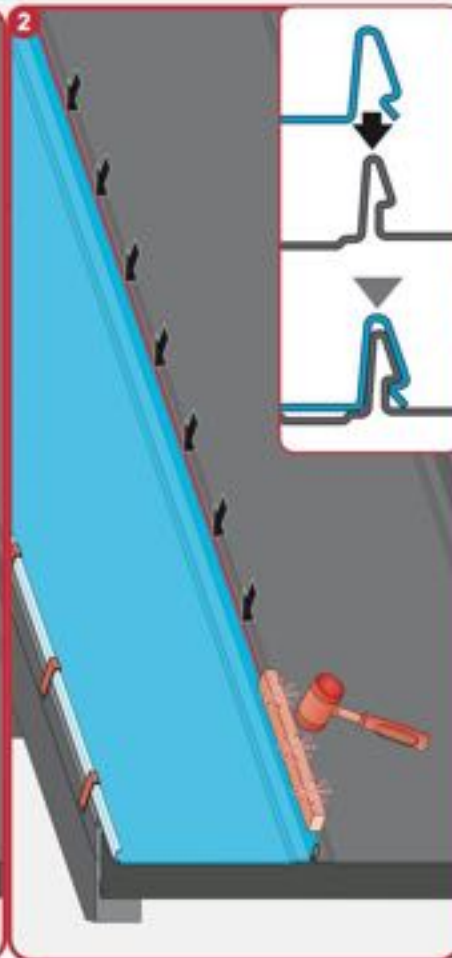
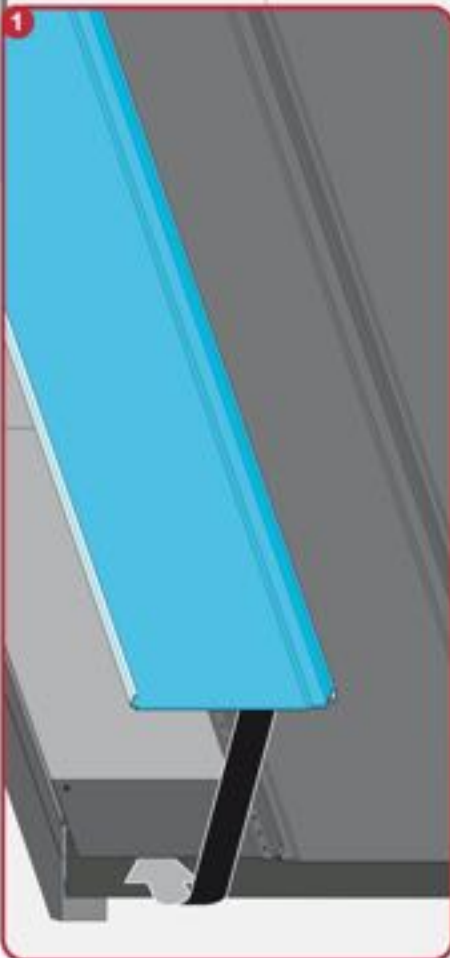
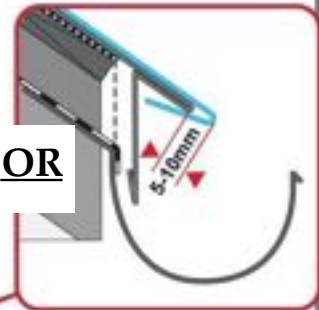

A. JOINING PANELS

8



JOINING
RETRO25 and
RETRO38

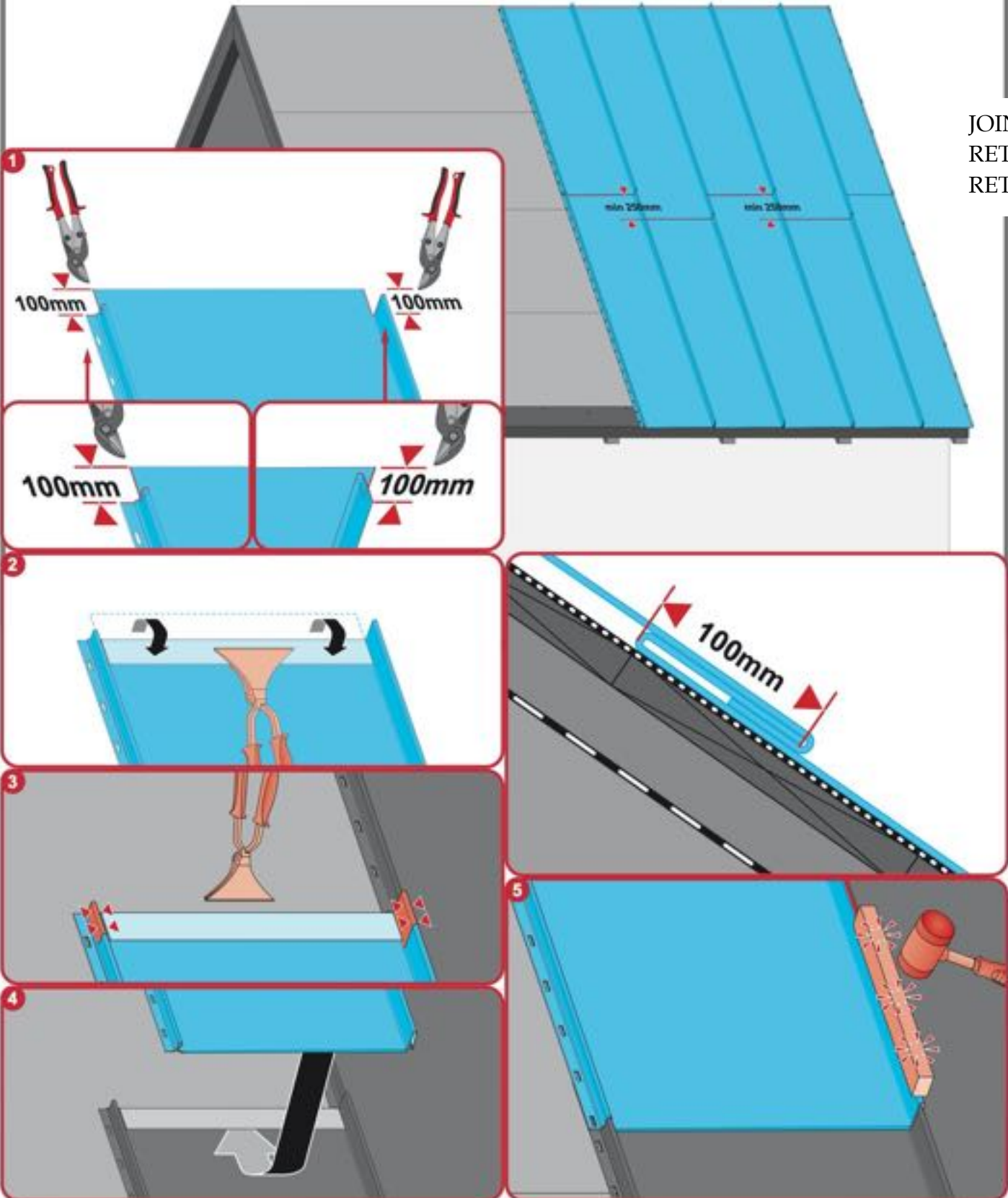

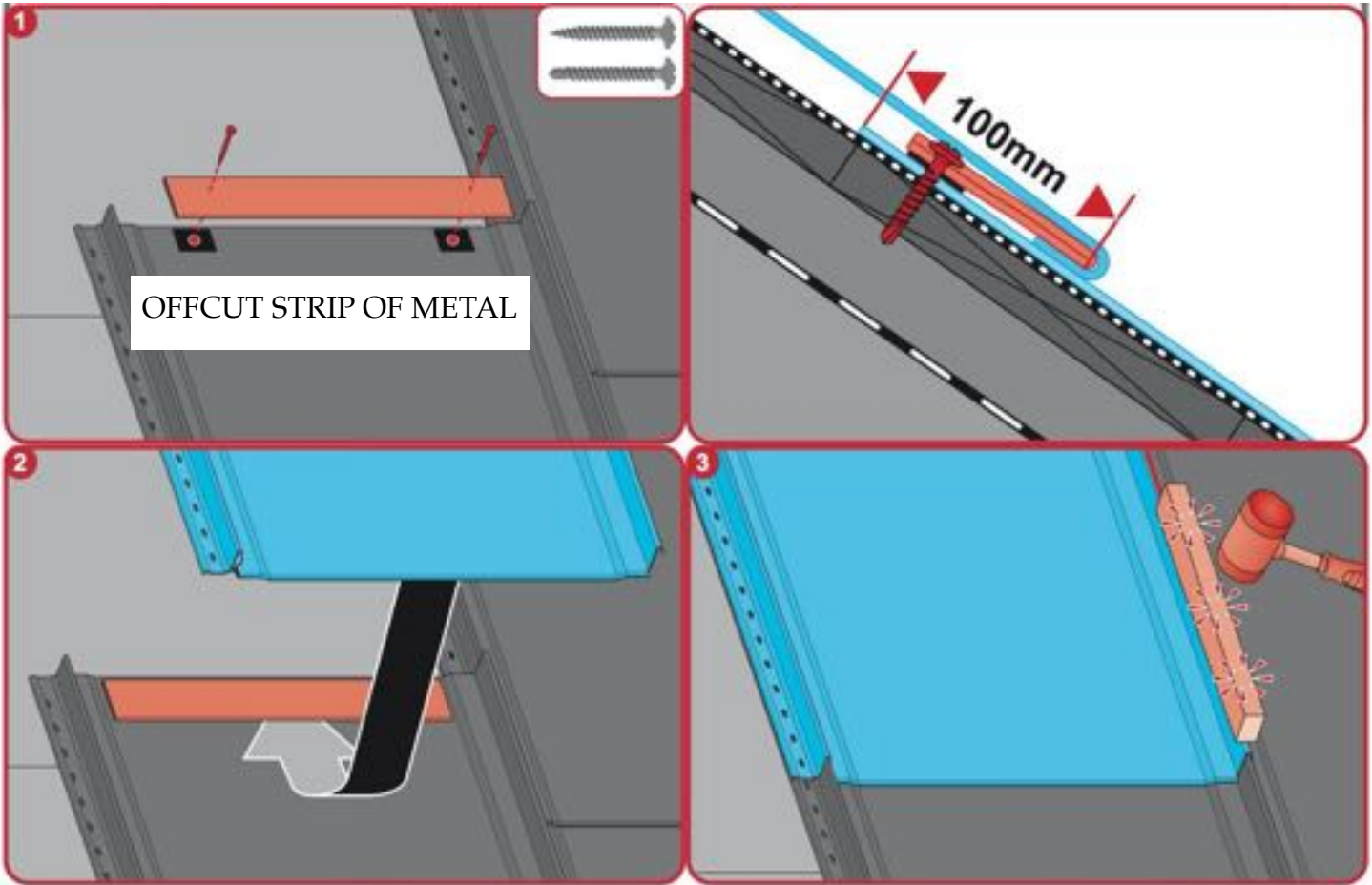

JOINING
HIGHTECH

4. JOINING DIFFERENT ROOF PARTS

with different pitch

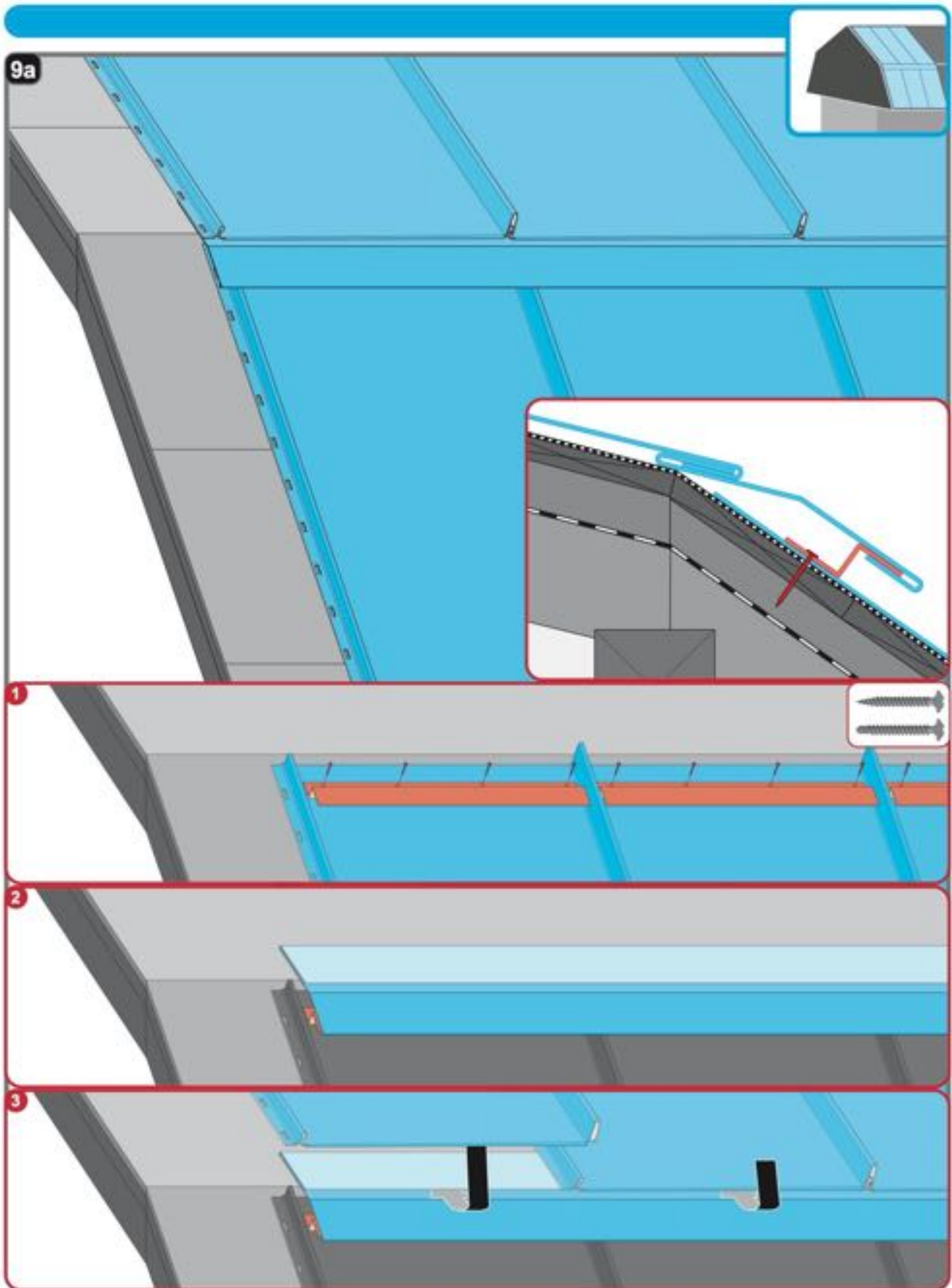

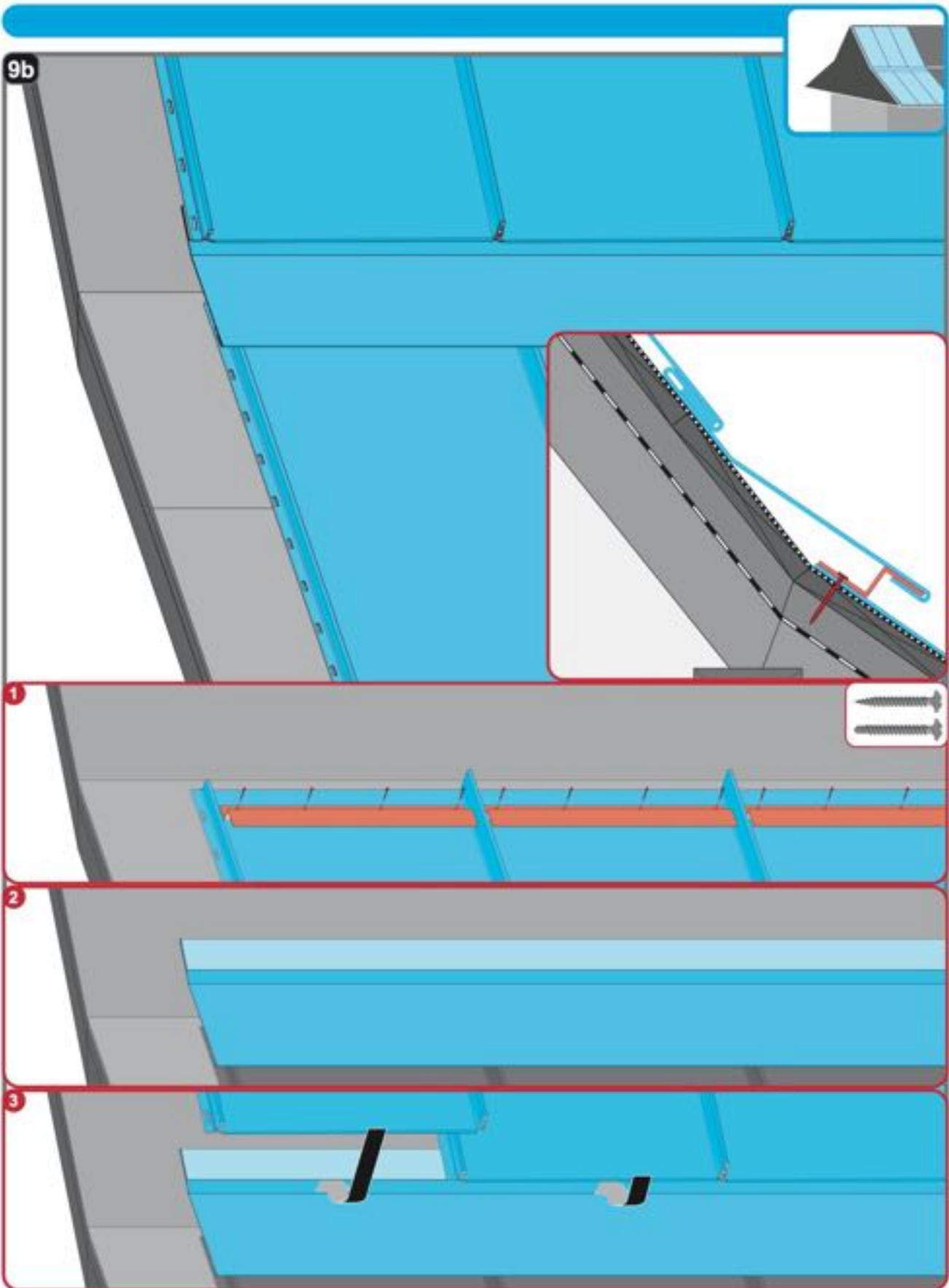

Custom
made
connector
box

With standard flashing kit attachment box

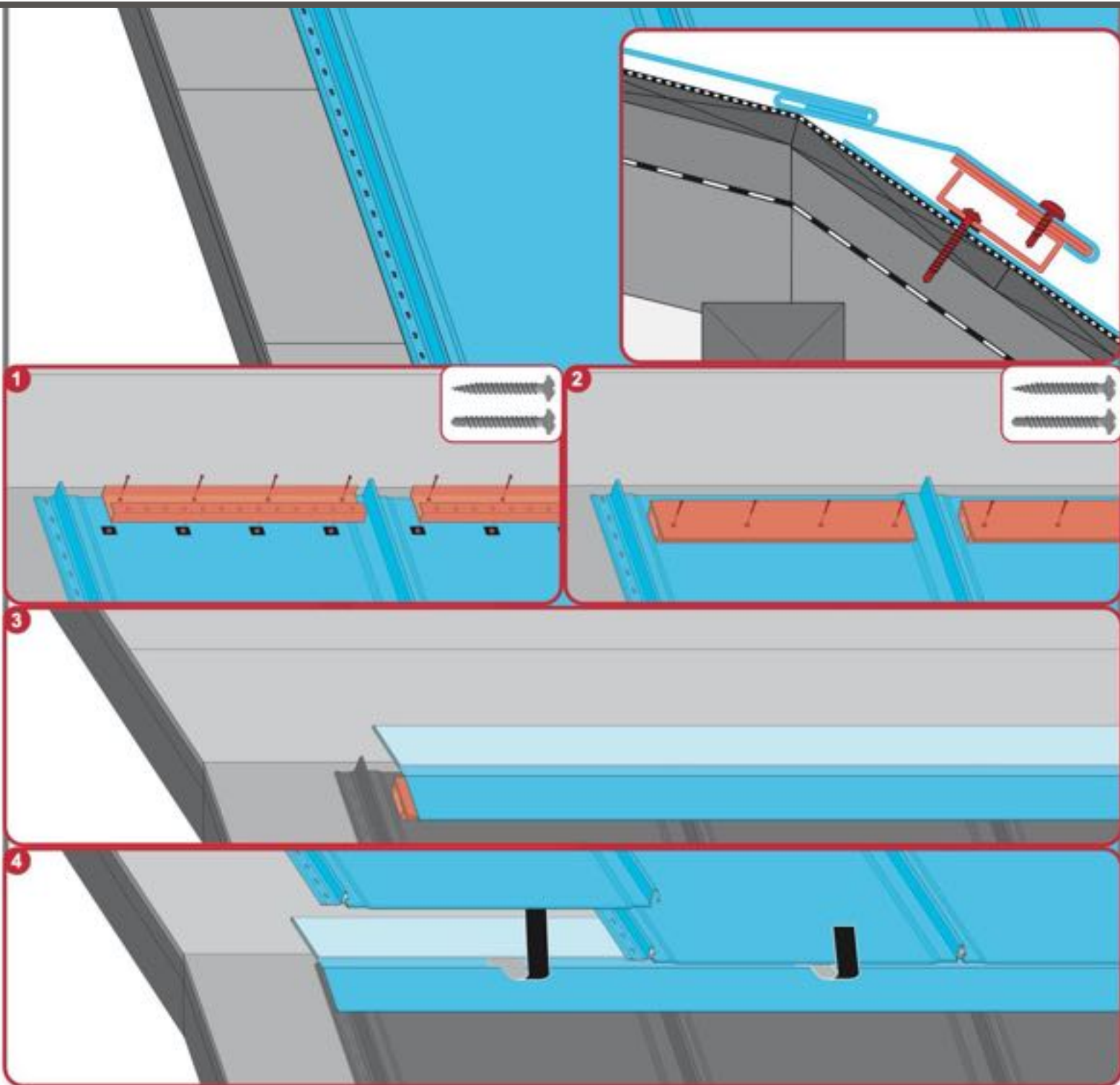

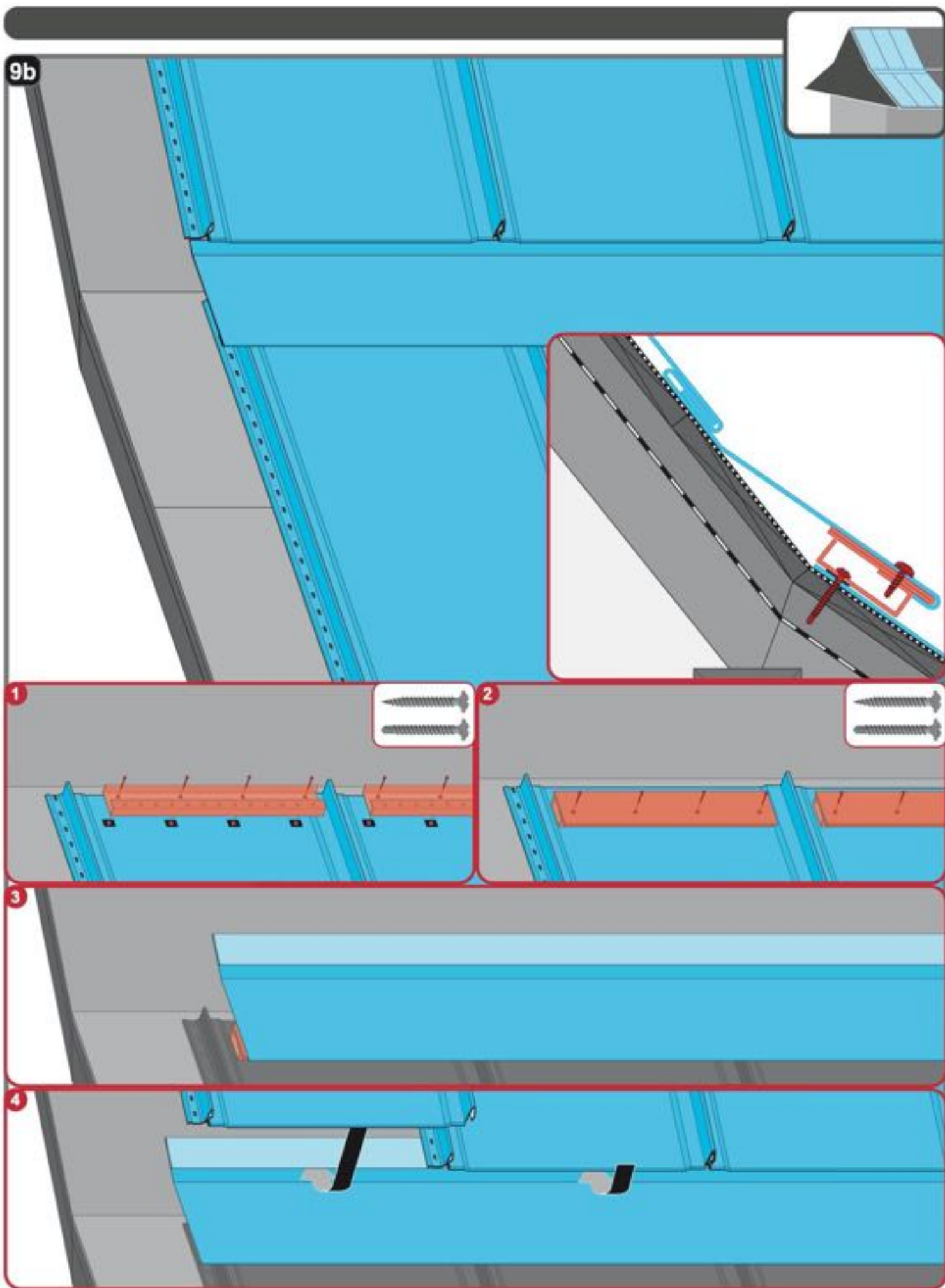

5.OPTIONS FOR FLASHING KIT

BARGE BOARD

10

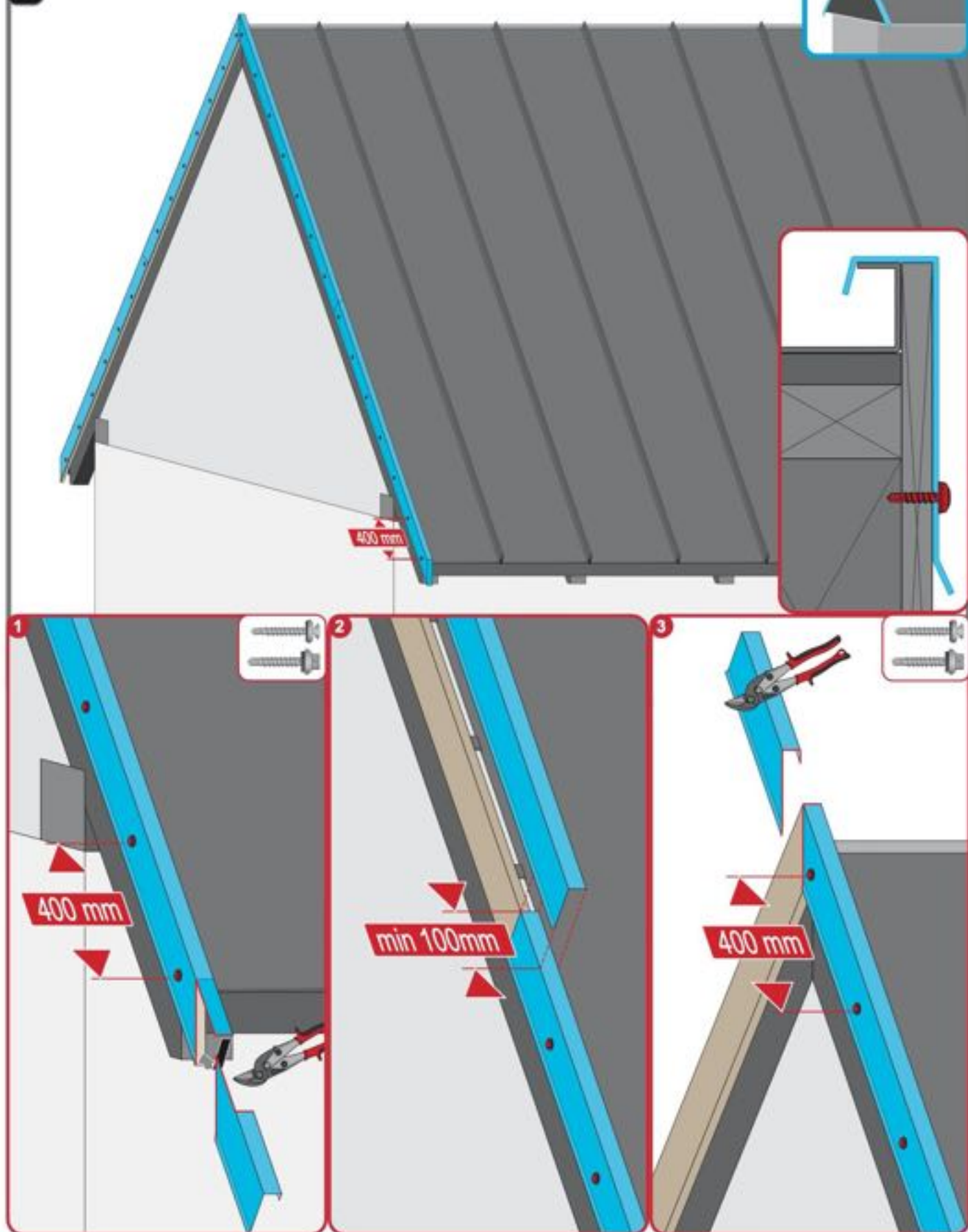

6.DORMER CONNECTION AND TROUGHS

11a

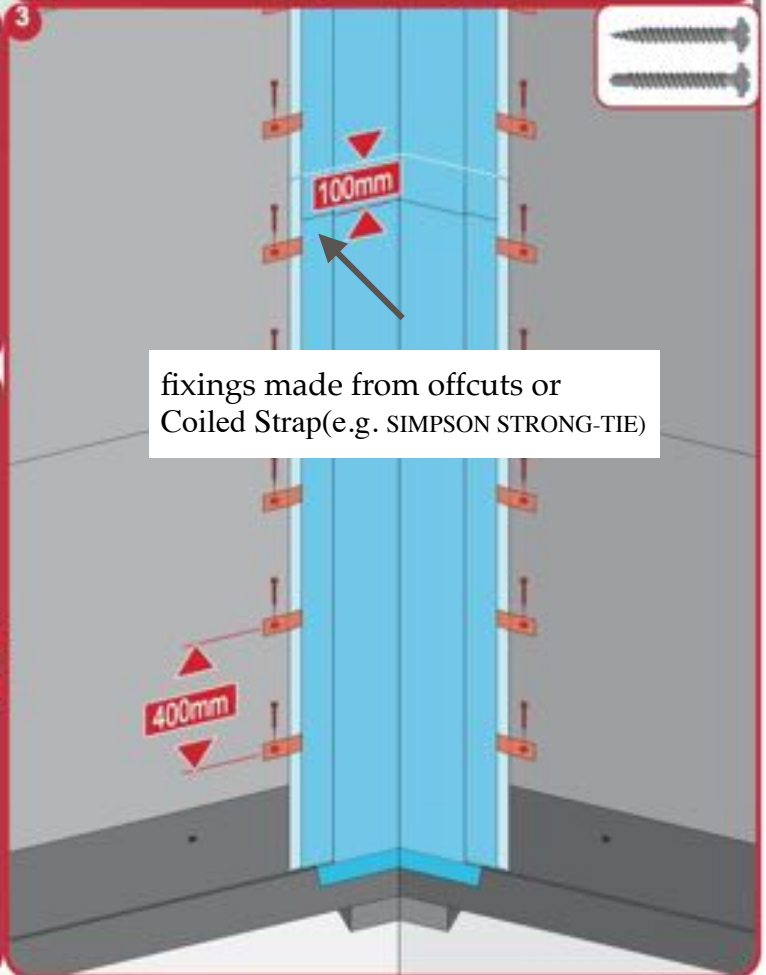
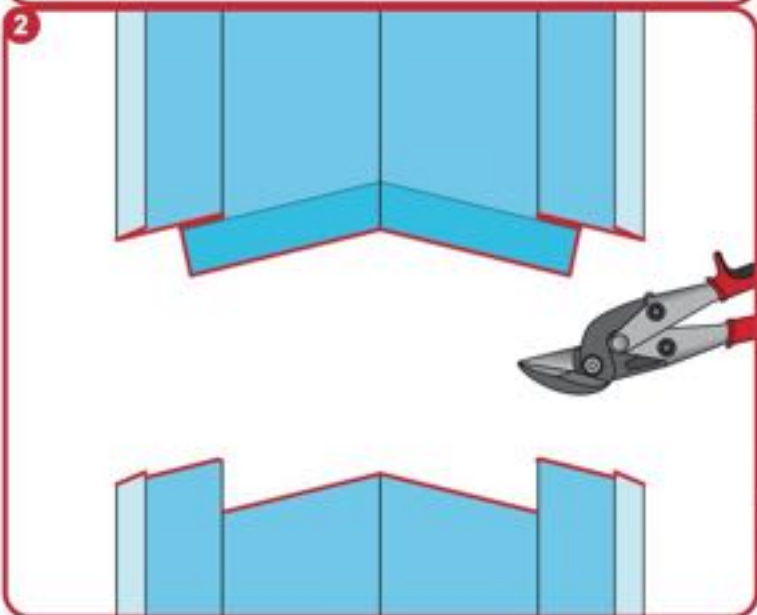
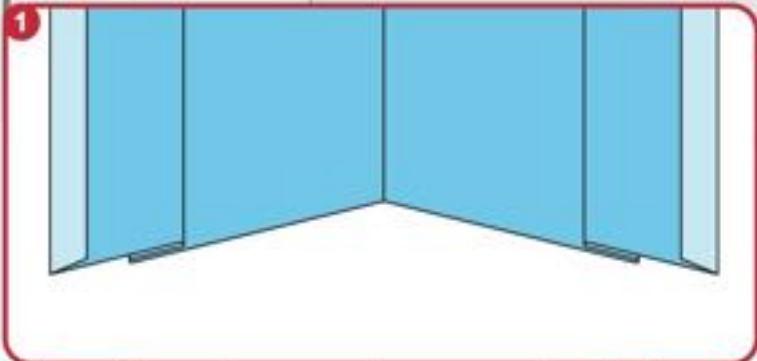
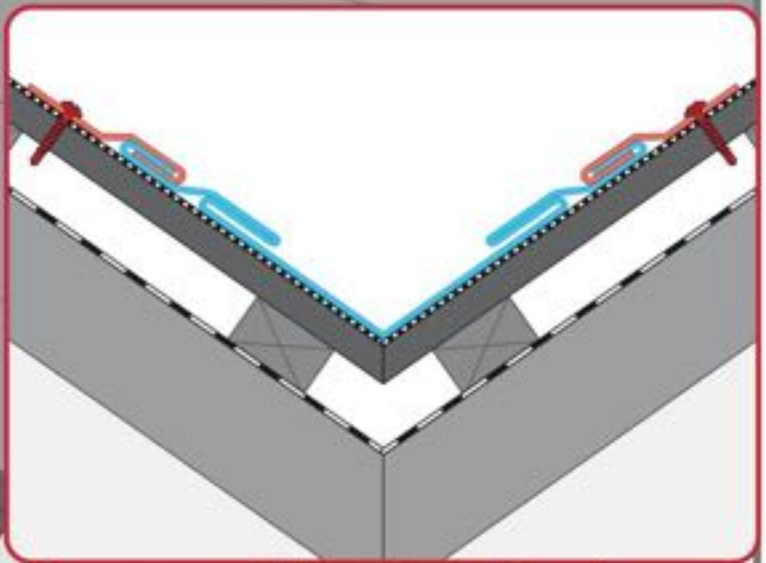
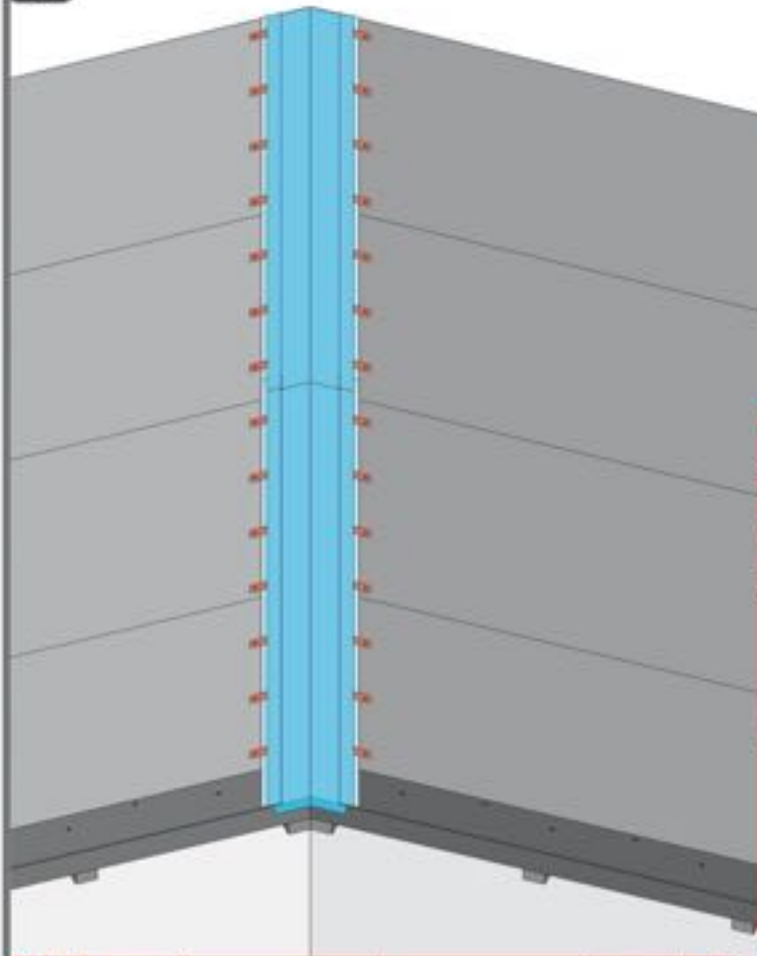

fixings made from offcuts or
Coiled Strap(e.g. SIMPSON STRONG-TIE)

11b

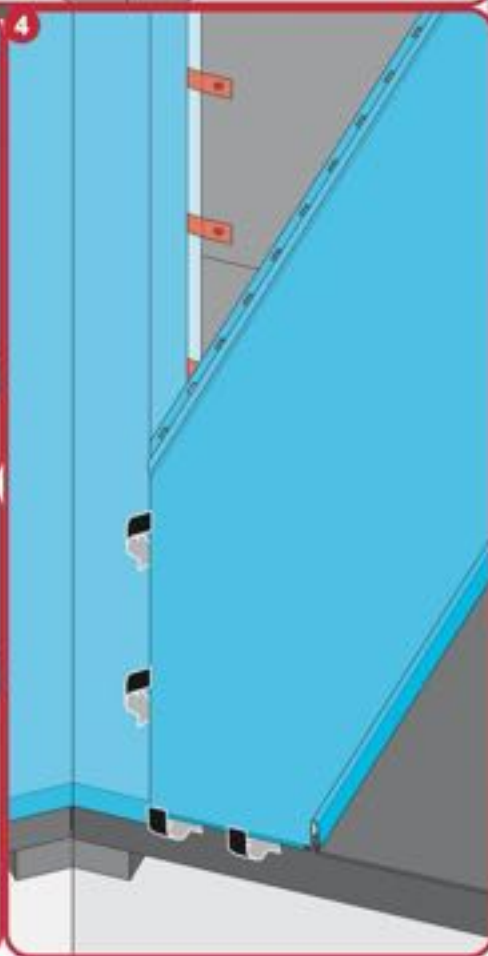
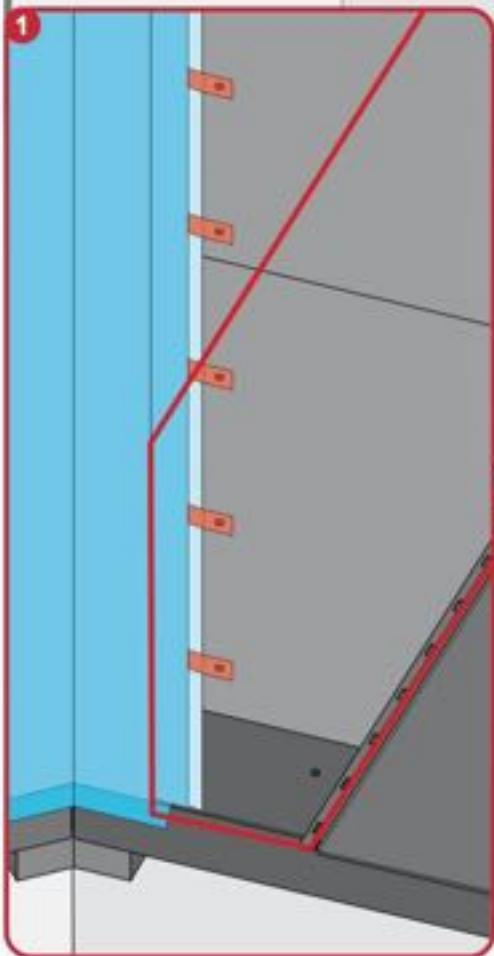
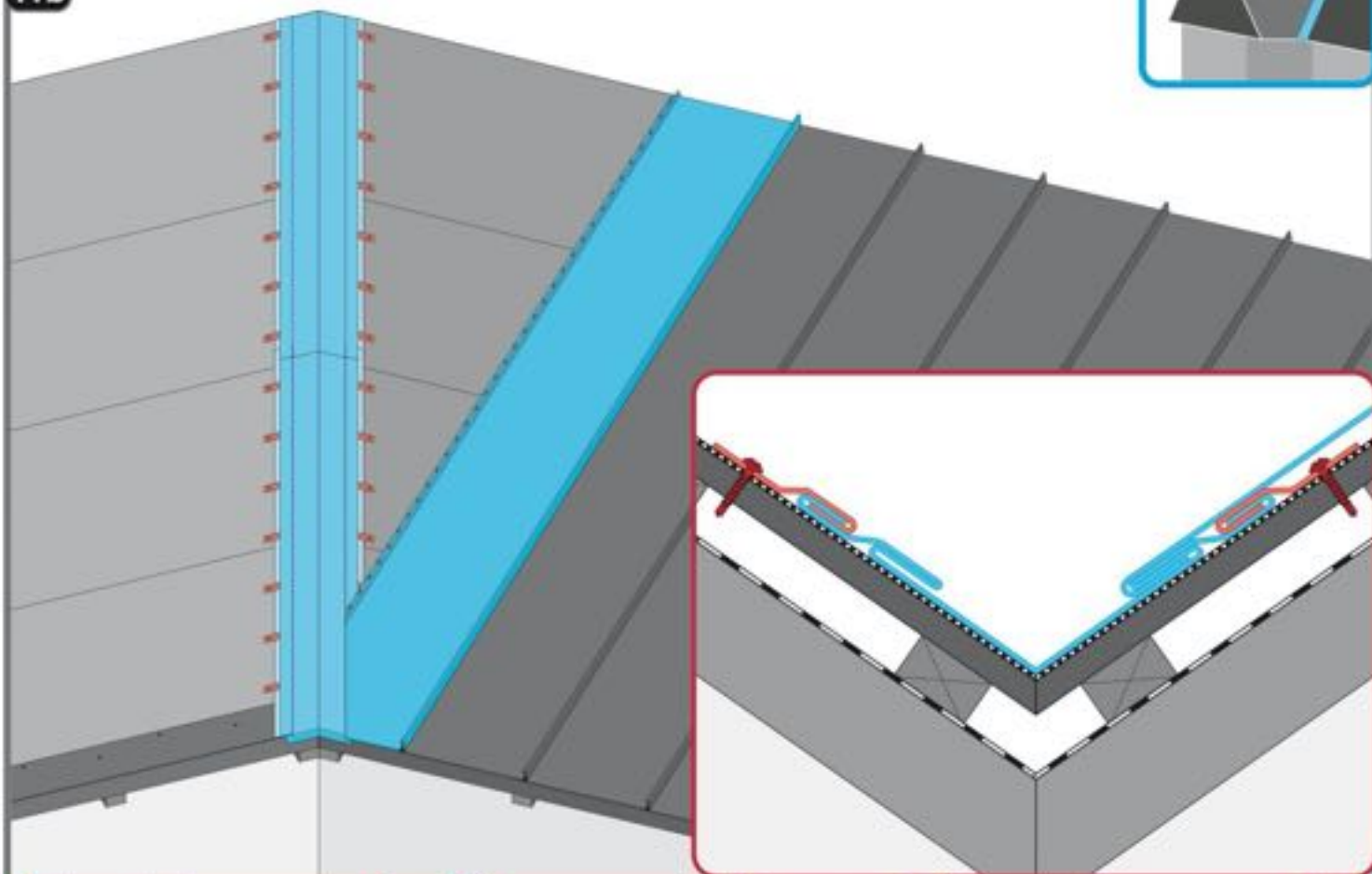

11c

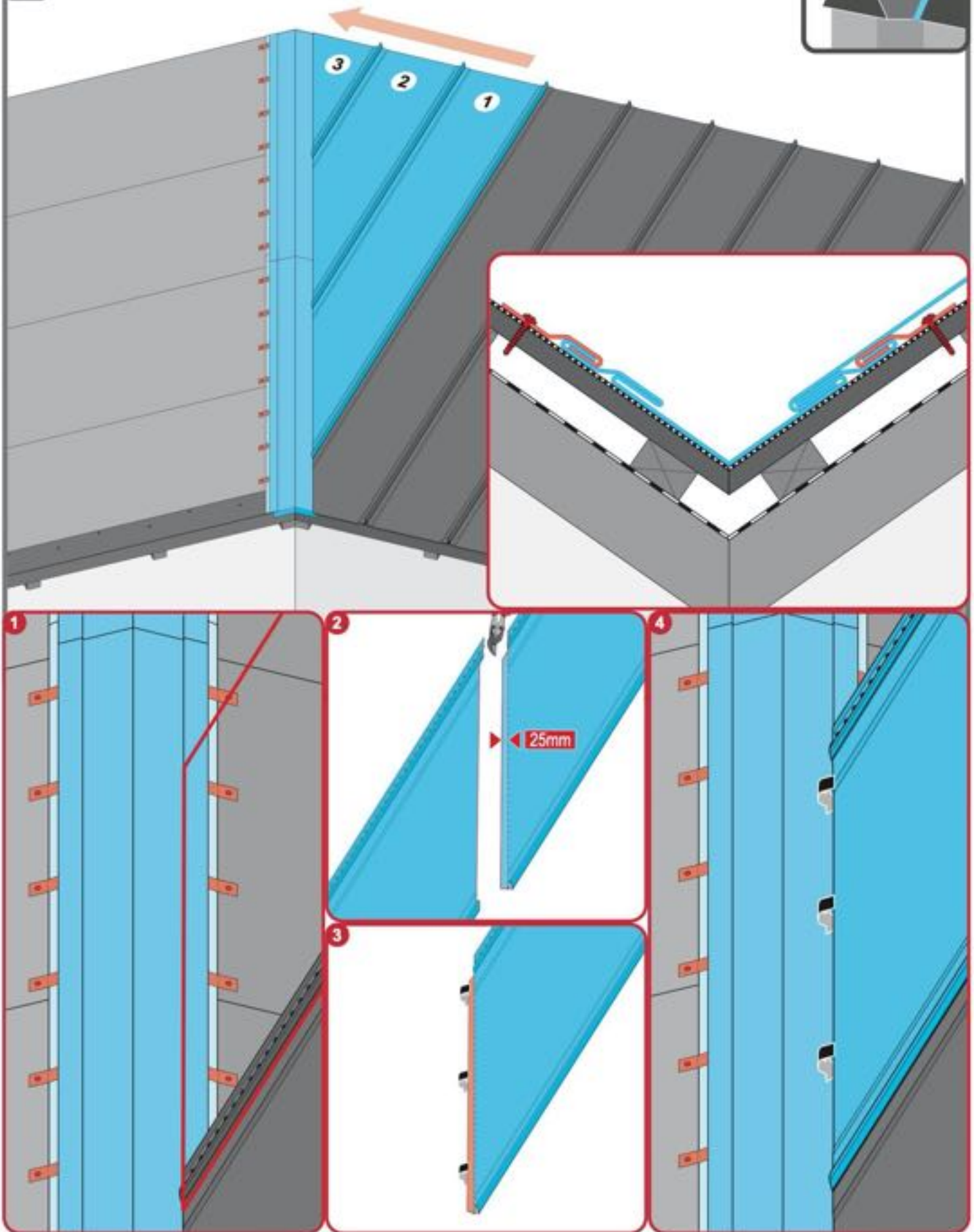

11d

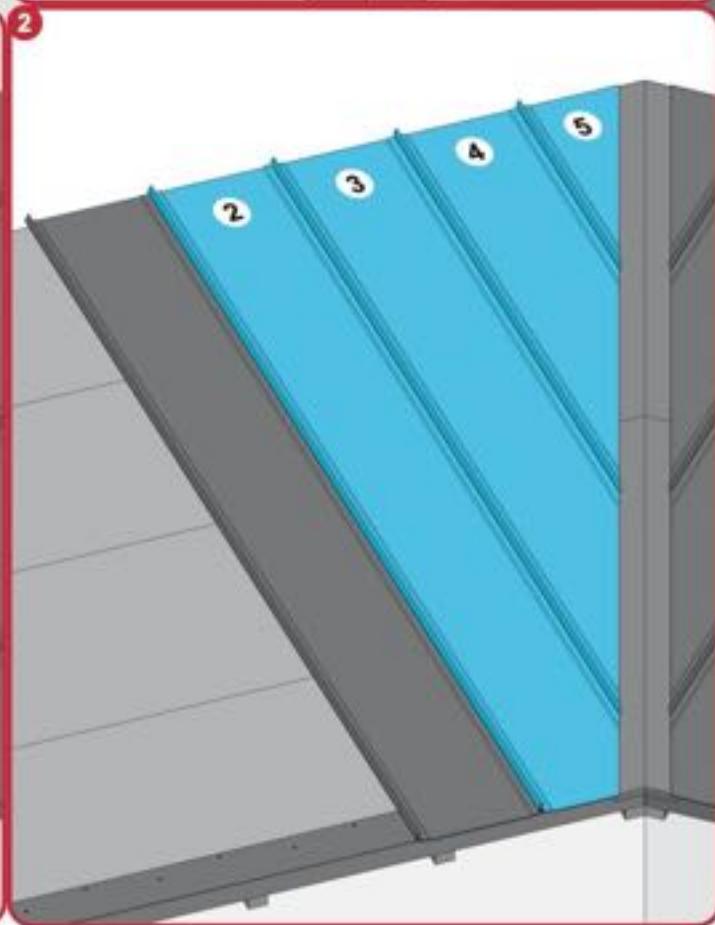
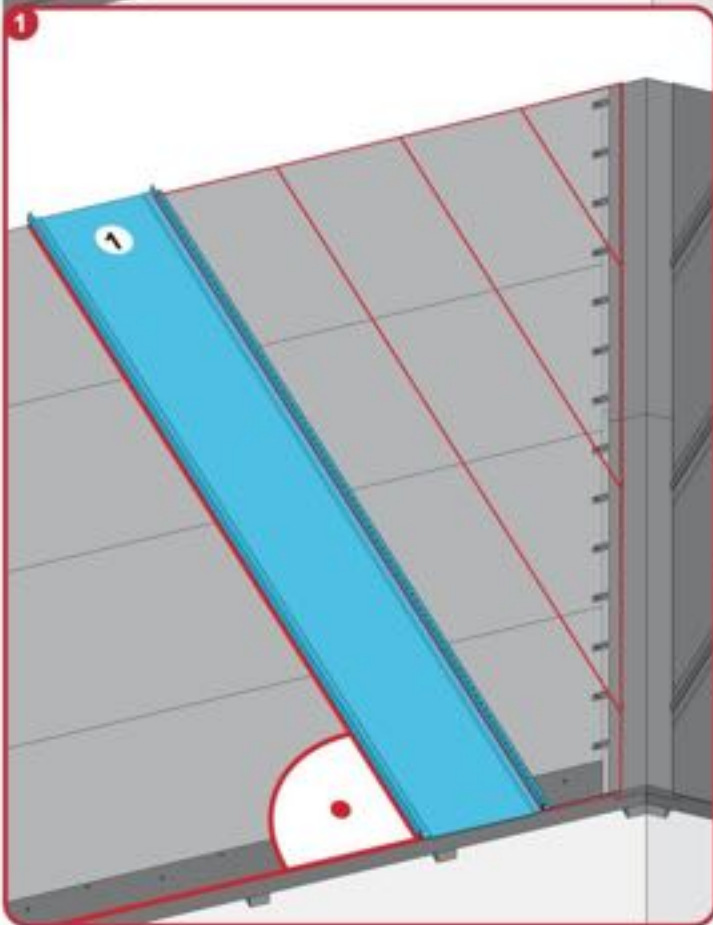
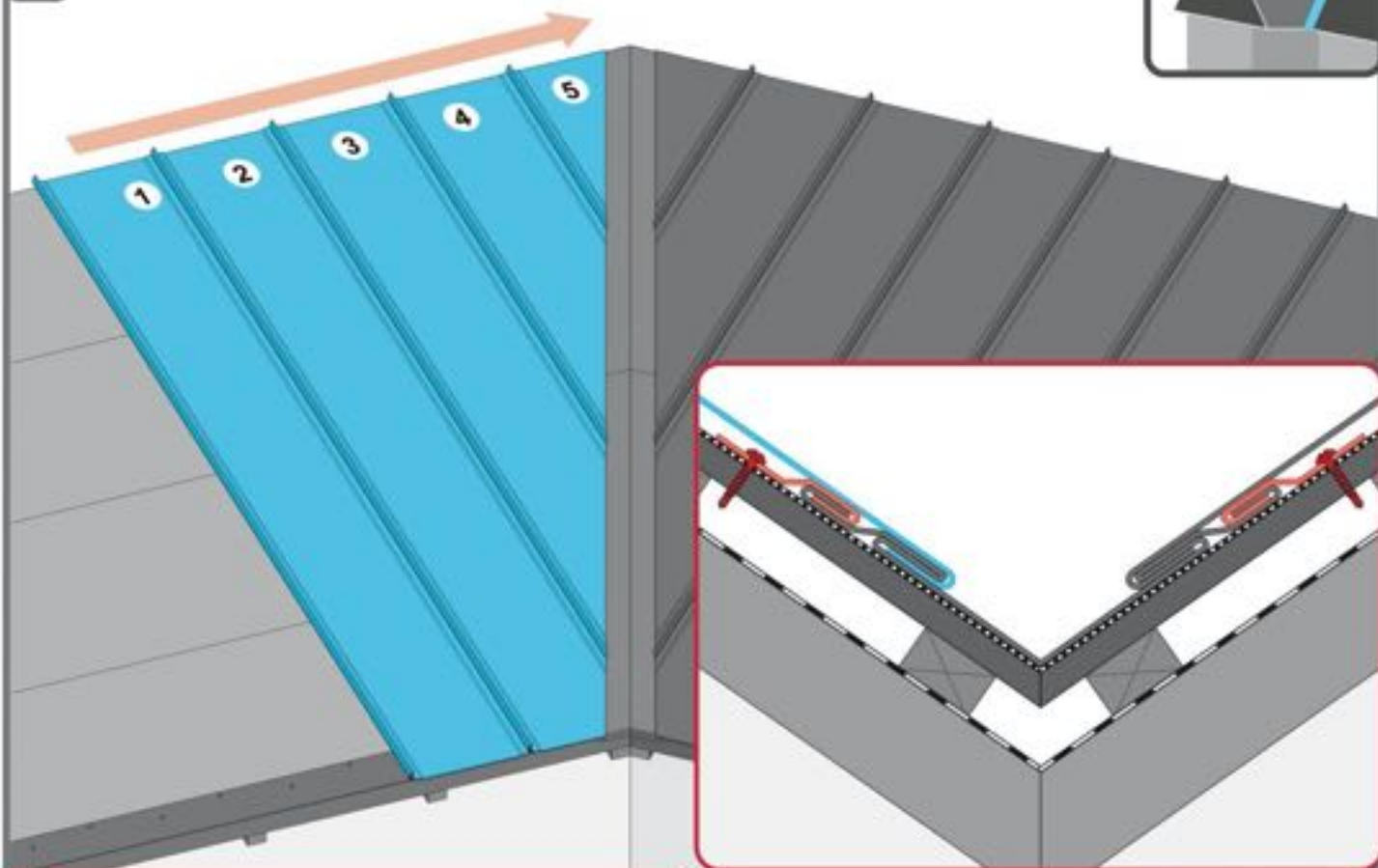

7. RIDGE TILE

12

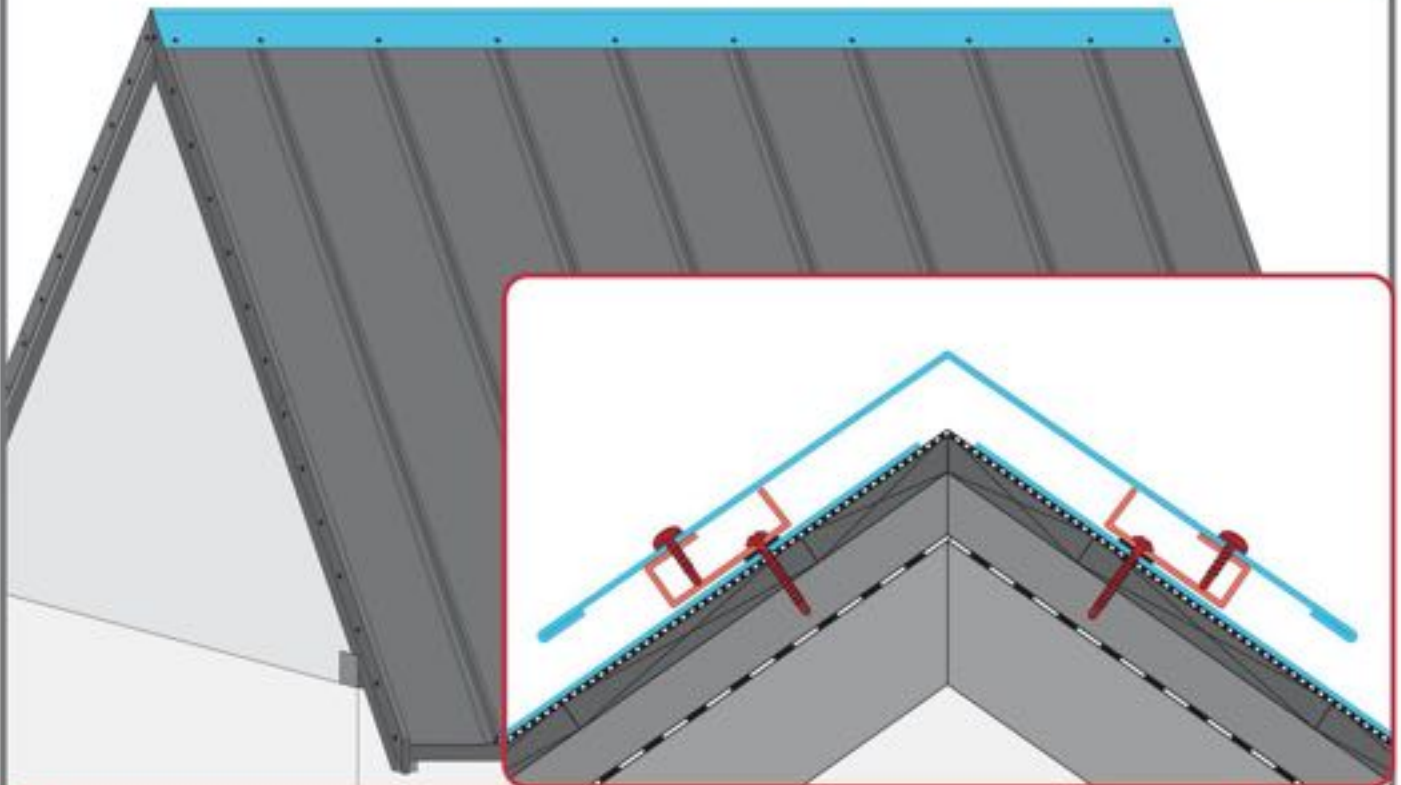
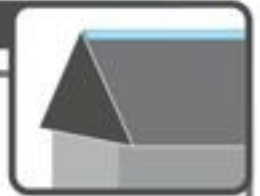

1

Standard flashing kit attachment box



2



max 500mm

max 500mm

8. CHIMNEY FLASHING

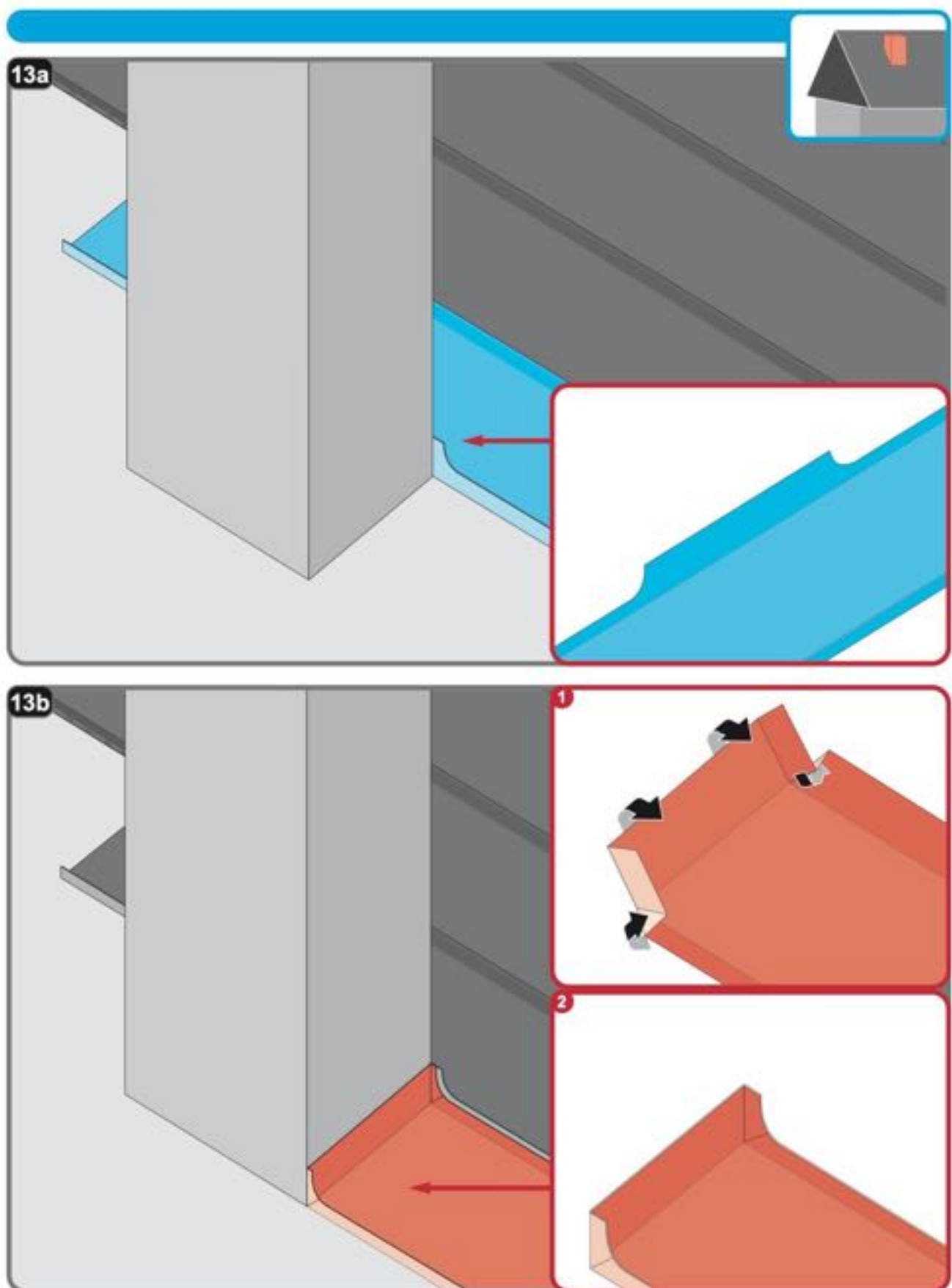

13c

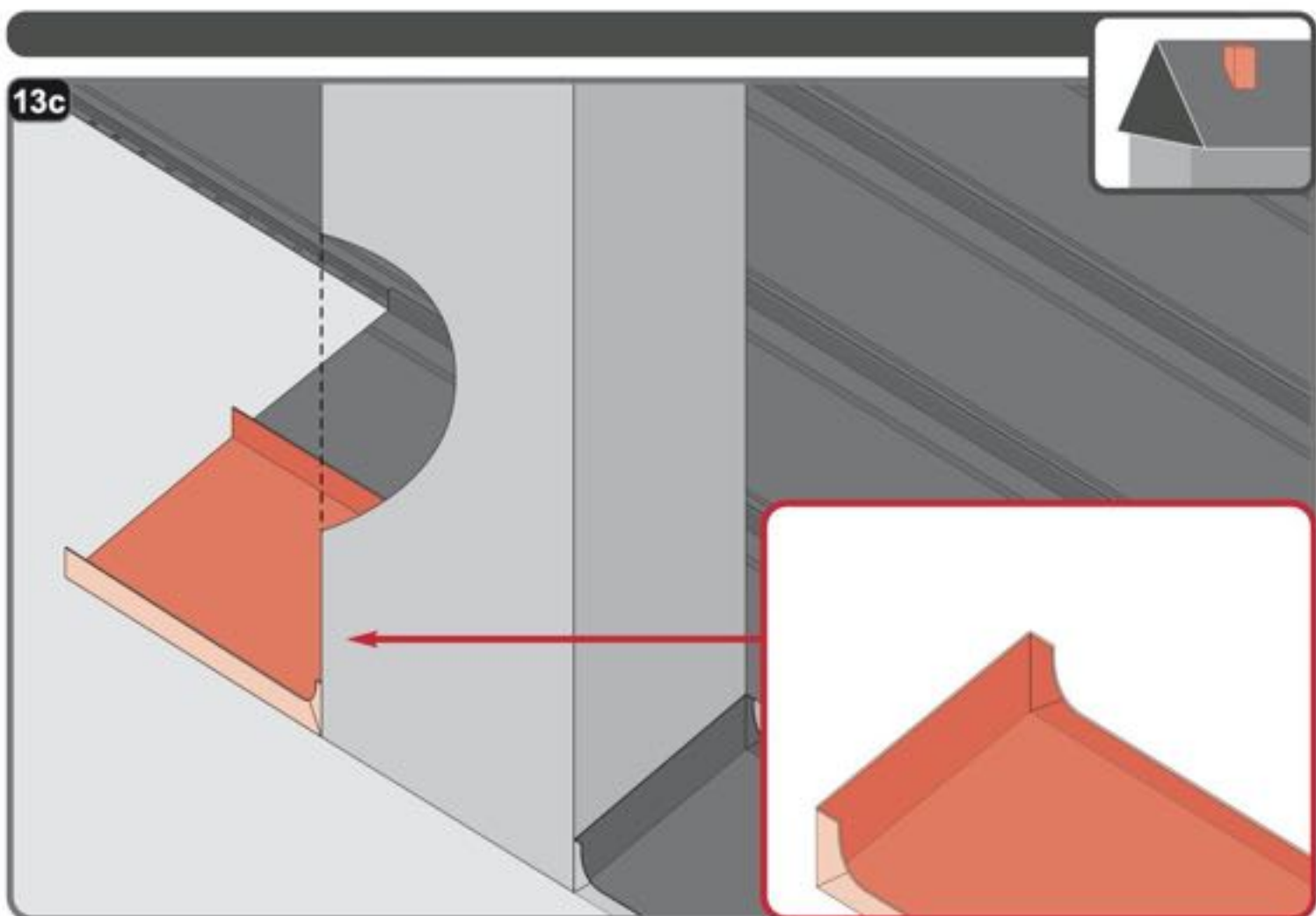

13d

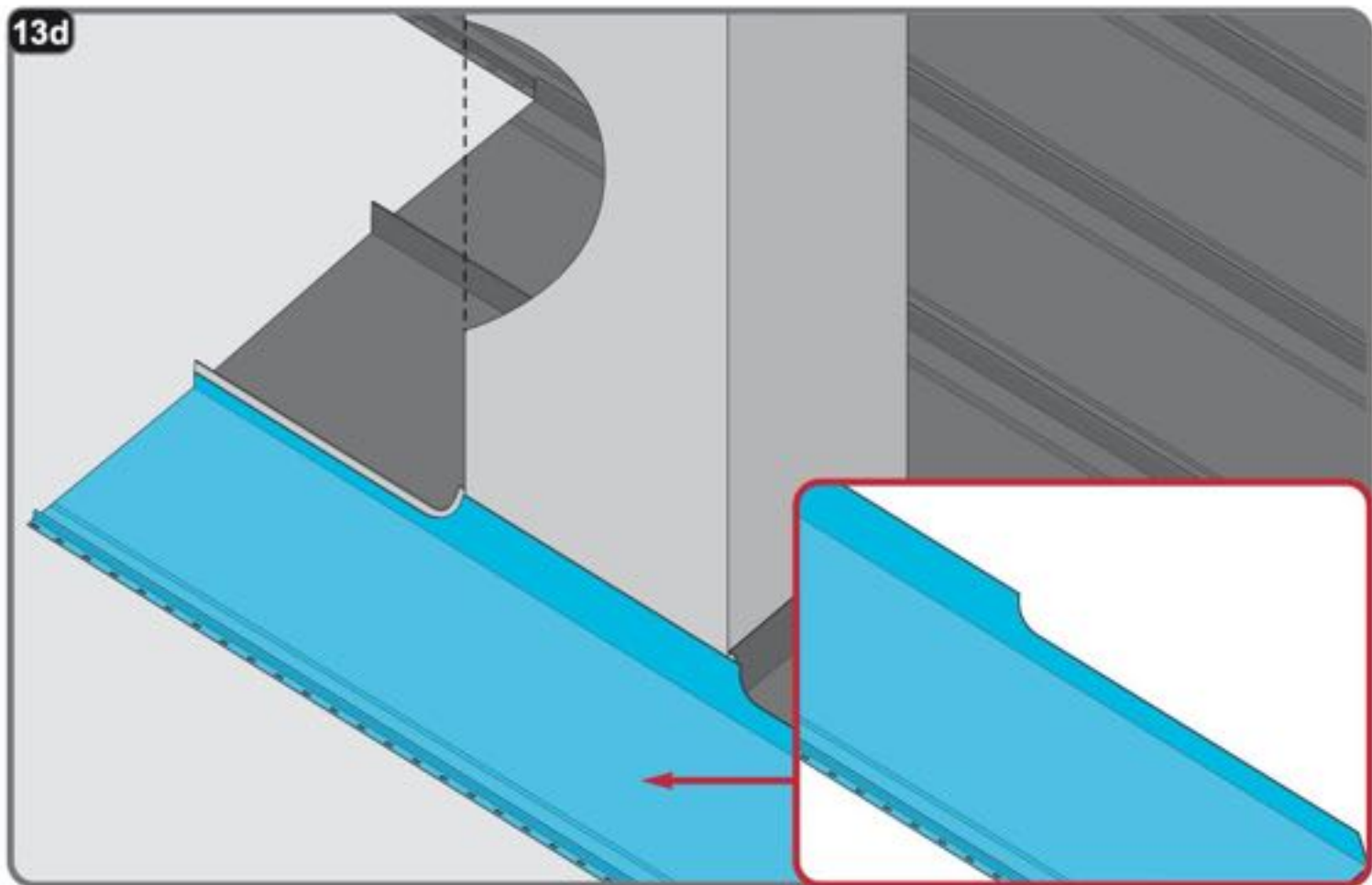

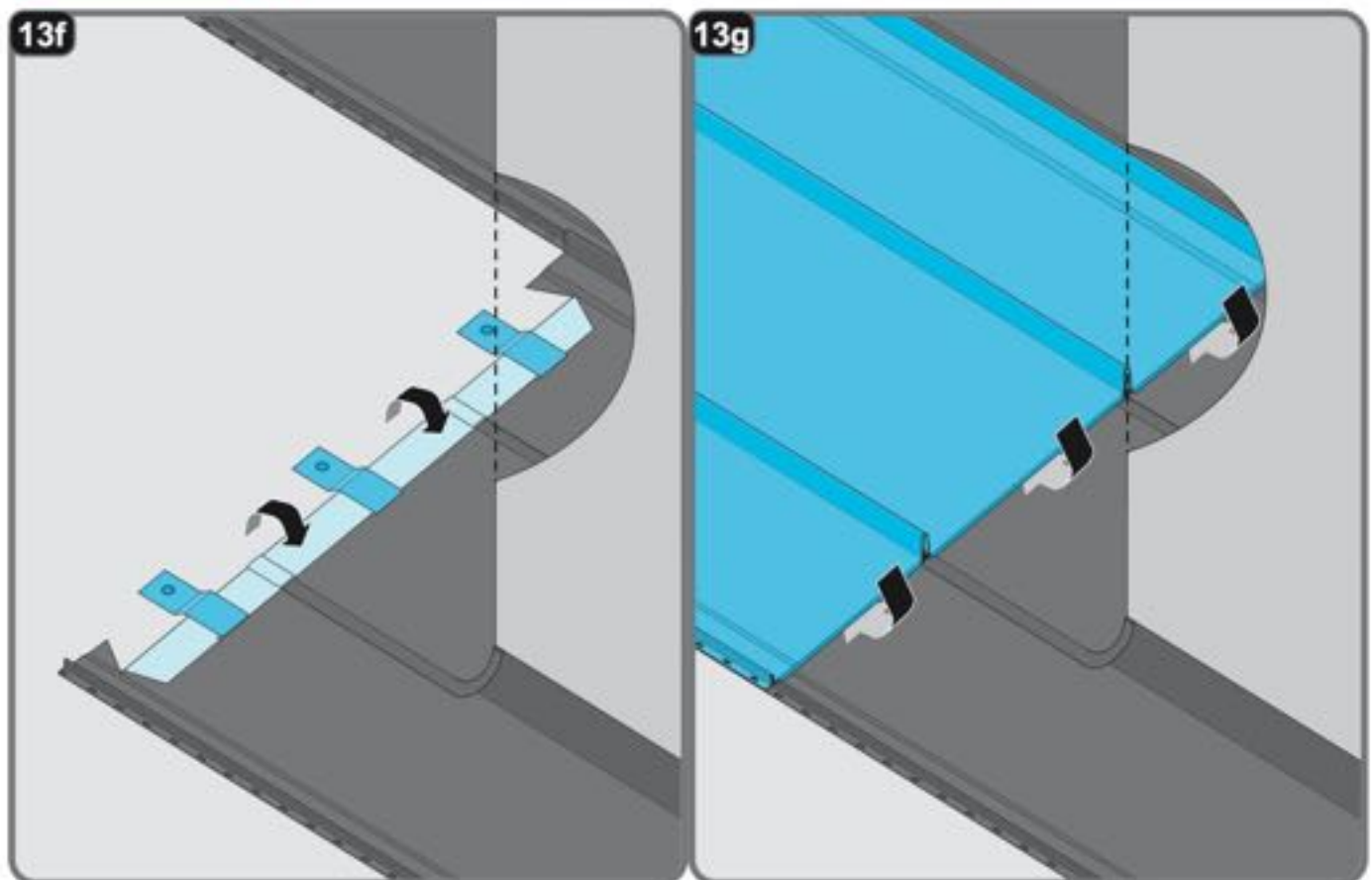
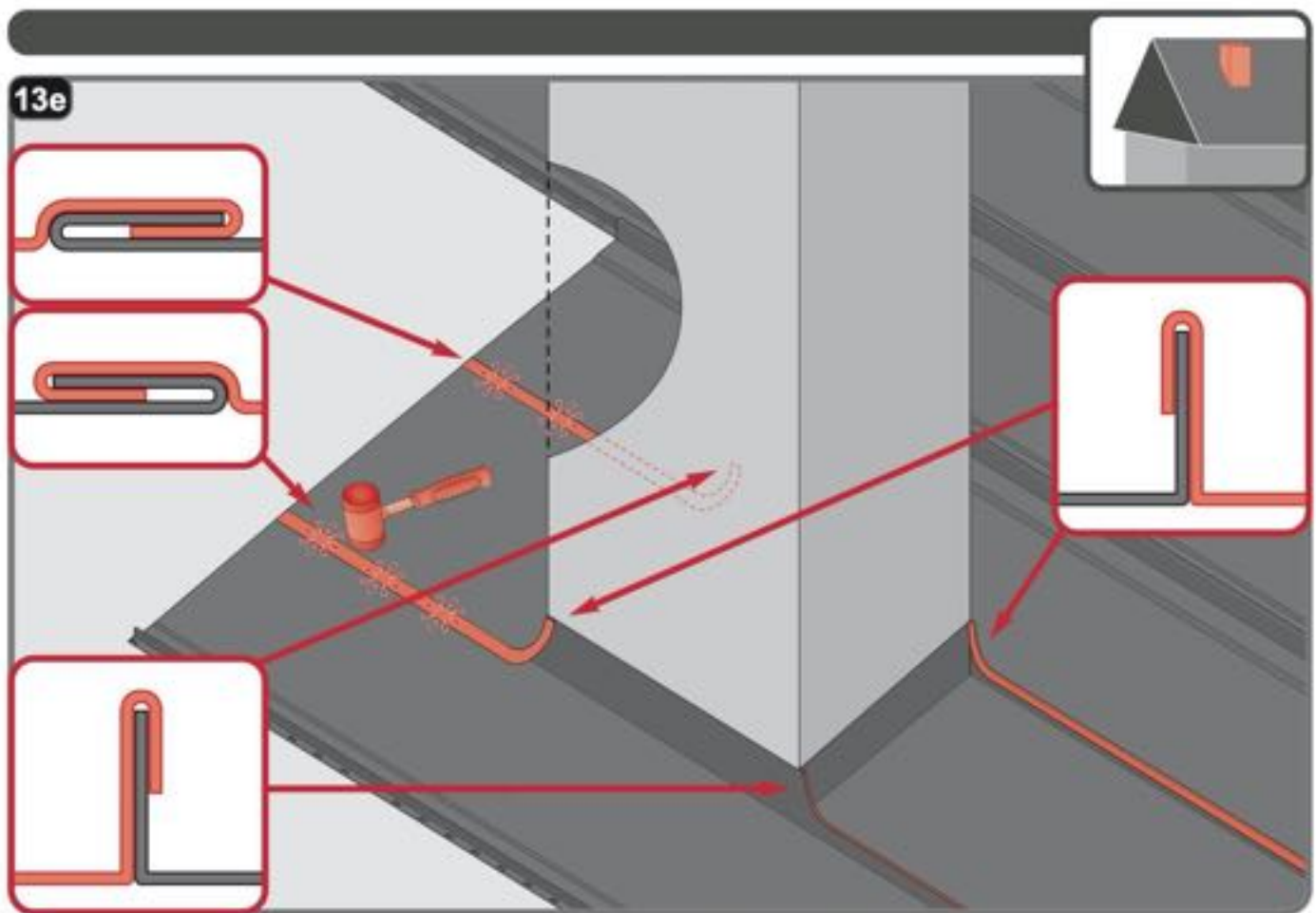

PAGUREK

METAL ROOFING SUPPLIES
METAL GUTTER SYSTEMS
PASSIVE HOUSE WINDOW
& DOORS
PREFAB I-BEAM SEGMENTS

0044 / 7586452405
PATRICK@PAGUREK.COM
PAGUREK.COM
ORLEBAR GARDENS, BRISTOL

