

WOODEN WINDOWS AND DOORS



Products for the Scandinavian market



DUDEK H&H



Dudek H&H woodworking company was established in 1984 by Dudek brothers. In 1987 a new production yard was built to accommodate increased production volume of doors and windows. High quality doors and windows have been displayed on numerous fairs in Poland as well as abroad. Investments in 1998 and 1999 resulted in extending production rooms.

Nowadays the factory can boast of modern, ecological and fully automated paint rooms, assembly rooms, production rooms, warehouses, boiler-room and drying rooms.

Efficient dust and chip suction systems equipped with filters that eliminate environmental pollution have been implemented.

At present the company employs over 80 members of staff in a modern, well-organized windows and doors production facility. Thanks to their skills, working methods as well as the applied technology (modern machines, top quality raw materials and ecological finishing materials) Dudek H&H quickly gained customers' recognition and attention both in Poland and abroad.

In 2012 Dudek H&H have started new investments which will increase the company product range.

From the very beginning the company's main goal is to supply customers with best quality products.

PRODUCTION



Dudek H&H products for the Scandinavian market

Dudek H&H export products to Scandinavian market since 2001. Until now there has been over 75 thousand pieces of Dudek H&H windows and doors installed in Norway and Sweden

Dudek H&H is focused on delivering the highest quality wooden windows and doors produced in accordance to the best production practice according to the CE and NDVK certificates.

Our products are annually tested in accredited laboratories for their air and rain tightness.

We are a NDVK certified producer of wooden windows and doors.

All materials installed in Dudek H&H products are high quality components supplied by European manufactures.

The hardware used in windows and doors are branded products of Assa, Fix or Spilka.

Our products have been installed on many different job sites in cooperation with the biggest Scandinavian builders and investors

Scandinavian market experience, high quality products and individual customer relationships connected with our flexibility give us good opportunity to become a strong partner for our customers.



OUTWARD OPENING WINDOWS

OUTWARD OPENING WINDOWS

TOP SWING

SIDE SWING

SIDE HINGE

TOP HUNG

Most popular Scandinavian opening windows, produced in four different opening types. Windows equipped in original Spilka hardware.

Could be produced in our windows U- value range :
 $U_w = 0,8 \text{ W/m}^2\text{K}$; $1,0 \text{ W/m}^2\text{K}$; $1,2 \text{ W/m}^2\text{K}$; $1,4 \text{ W/m}^2\text{K}$

WINDOWS SPECIFICATION

MATERIAL

Laminated pine

Meranti or Oak as option

GLAZING

2 layer or 3 layer glazing sets.

Available glass function: Hardened, Laminated, Self-cleaning, Sunreduction, Noisereduction, Stained glass, etc.
Swisspacer V hot edge in glazing available for request.

PAINTING

Painting system in accordance to SigmaKalon system

3-layer system: Impregnation, Primary and Top coat.

Available Painted in all colors in accordance to NCS or RAL color charts.

Could be painted in 2 colors for the special request

HARDWARE

Original SPILKA hardware

Top Swing windows equipped in Spilka Classic hinges

ESPAGNOLETT

Fix Sweden espagnolette lockboxes and rod system

CLOSING

Windows closed by the handles or casement fasteners

See page no. 9 for details.

GLAZING LISTS

PVC glazing beads in all windows painted in NCS S0502Y

Wooden list in all other window colors

GLAZING BEADS

Aluminium glazing beads

SEALING

Q-lon weather strip

Trelleborg glazing seals

CHILD SAFETY

Windows equipped in child safety restrictors which allow to open the sash in ventilation position.

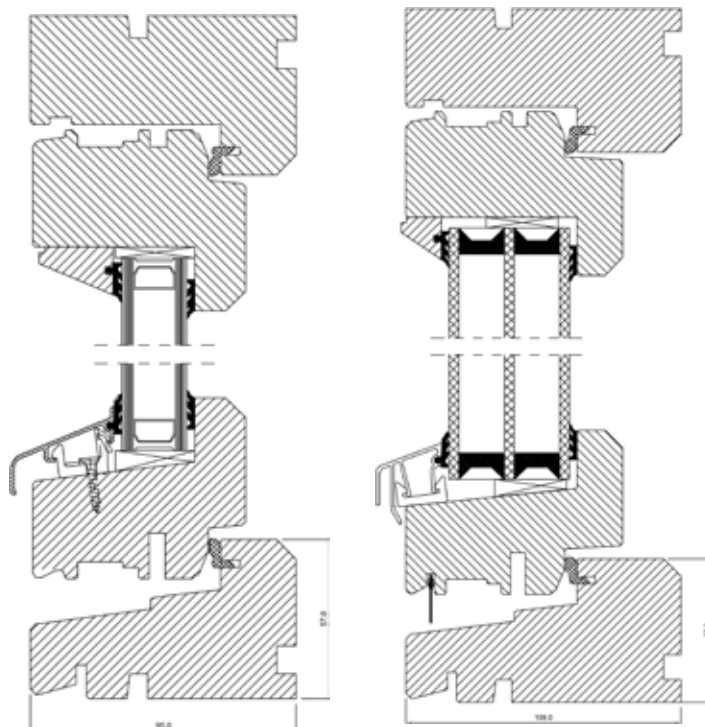

STANDARD

PASSIVE $U_w=0,8 \text{ W/m}^2\text{K}$

Drawing no. P-13-01

Drawing no. P-13-03

OUTWARD OPENNING WINDOWS

ALUMINIUM CLADDED OUTWARD OPENING WINDOWS



TOP SWING
SIDE SWING
SIDE HINGE
TOP HUNG

Aluminium cladded outward opening windows keep the advantages of wooden windows and add the maintenance free surface of aluminium cladding.

Aluminium on the outside of the windows increase the product life time and allow minimize influence of the weather condytions.

Could be produced in windows U-value range :

$U_w = 0,8 \text{ W/m}^2\text{K}$; $1,0 \text{ W/m}^2\text{K}$; $1,2 \text{ W/m}^2\text{K}$; $1,4 \text{ W/m}^2\text{K}$

WINDOWS SPECIFICATION

MATERIAL

Laminated pine

Meranti or Oak as option

ALUMINIUM CLADDING

Aluron Nordic aluminum cladding painted in RAL color.

GLAZING

2 layer or 3 layer glazing sets.

Available glass function: Hardened, Laminated, Self-cleaning, Sunreduction, Noisereduction, Stained glass, etc.

Swisspacer V hot edge in glazing avialable for request.

PAINTING

Painting system in accordance to SigmaKalon system

3-layer system: Impregnation, Primary and Top coat.

Available Painted in all colors in accordance to NCS or RAL color charts.

Could be painted in 2 colors for the special request

HARDWARE

Original SPILKA hardware

Top Swing windows equipped in Spilka Classic hinges

ESPAGNOLETT

Fix Sweden espagnolette lockboxes and rod system

CLOSING

Windows closed by the handles or casement fasteners

See page no. 9. for details.

SEALING

Q-lon weather strip

Trelleborg glazing seals

CHILD SAFTY

Windows equipped in child safety restrictors which allow to open the sash in ventilation position.

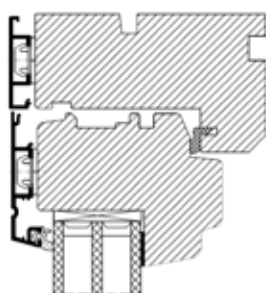

STANDARD

Drawing no. P-13-06

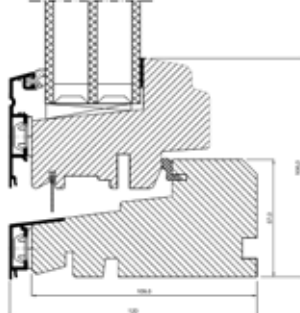
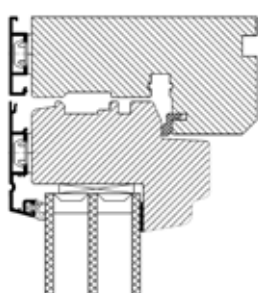

PASSIVE $U_w = 0,8 \text{ W/m}^2\text{K}$

Drawing no. P-13-07



OUTWARD OPENING BALCONY DOORS

OUTWARD OPENING BALCONY DOORS

Typical outward opening balcony doors with 3-point locking system espagnolette (bulgary protection hooks).

Doors equipped with sash brake, which stops in any opening position.

Balcony doors available with the panel in the bottom part of the doors or fully glazed.

Could be produced in product U-value range :

$U_w = 0,8 \text{ W/m}^2\text{K}$; $1,0 \text{ W/m}^2\text{K}$; $1,2 \text{ W/m}^2\text{K}$; $1,4 \text{ W/m}^2\text{K}$

BALCONY DOORS SPECIFICATION

MATERIAL

Laminated pine

Meranti or Oak as option

GLAZING

2 layer or 3 layer glazing sets.

Available glass function: Hardened, Laminated, Self-cleaning, Sunreduction, Noisereduction, Stained glass, etc.

Swisspacer V hot edge in glazing available for request.

PANEL

Special Poliurethane laminated sandwich panel

Panel with vertical rows or flush surface on outside

PAINTING

Painting system in accordance to SigmaKalon system

3-layer system: Impregnation, Primary and Top coat. Available Painted in all colors in accordance to NCS or RAL color charts.

Could be painted in 2 colors for the special request **HARDWARE**

Assa Abloy hinges with bulgary protection pins.

3D regulation hinges

ESPAÑOLETTE

Fix Sweden espagnolette system

CLOSING

Doors closed by the handles

Handles installed on the outside and inside of the door

Doors closed by the thumb knock (butterfly) on the inside

Cylinder locks available as option.

Available handles - see page no. 9. for details.

THRESHOLD

Four types of thresholds available for outward opening doors:

Wood threshold made in oak - not painted (57 mm high)

Aluminium threshold (35 mm high)

Fiberglass threshold in pine colour (25 mm) - meet TEK'10 requirements

Wood-alu threshold (25 mm) - meet TEK'10 requirements

All available thresholds presented on page no. 8.

GLAZING LISTS

PVC glazing beads in all windows painted in NCS S0502Y Wooden list in all other window colors

GLAZING BEADS

Aluminium glazing beads

SEALING

Q-Ion weather strip

Trelleborg glazing seals

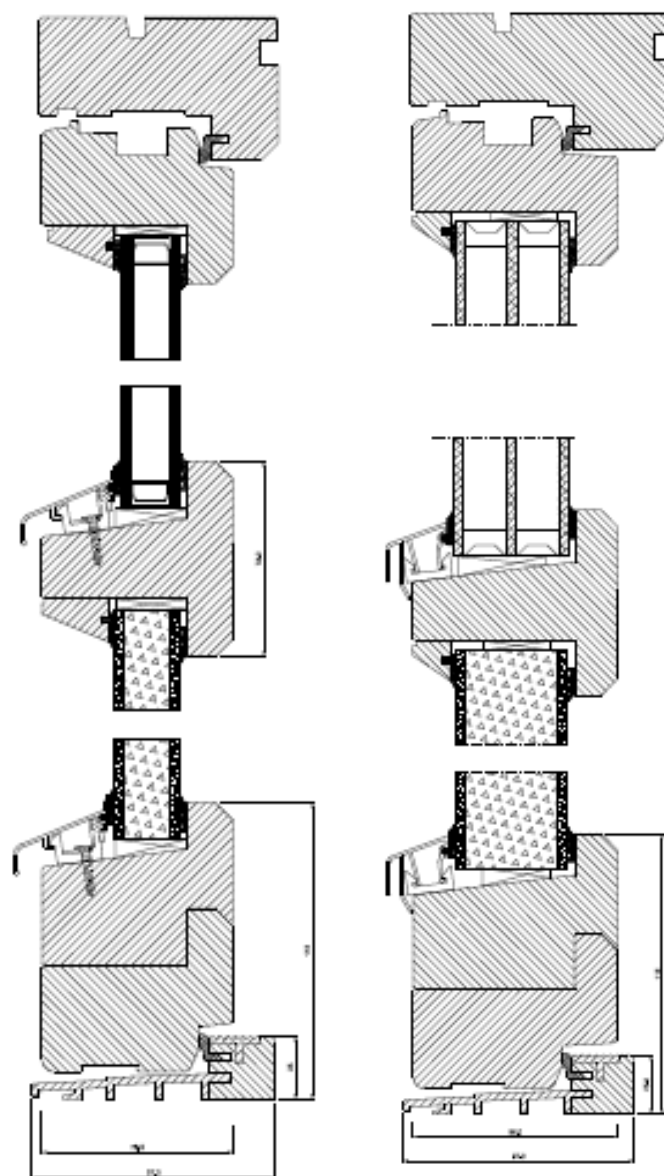

STANDARD
Drawing no. P-13-07

PASSIVE $U_w=0,8 \text{ W/m}^2\text{K}$
Drawing no. P-13-08

OUTWARD OPENING BALCONY DOORS

ALUMINUM CLADDED OUTWARD OPENING BALCONY DOORS

Outward opening balcony doors with 3-point locking system espagnolette (bulgary protection hooks). Doors equipped with sash brake, which stops in any opening position. Aluminium cladding installed on the outside of the door to increase the product life time - maintenance free surface on the outside of the doors, resistant to any weather condytions. Balcony doors available with the panel in the bottom part of the doors or fully glazed. Could be produced in product U-value range :
 $U_w = 0,8 \text{ W/m}^2\text{K}; 1,0 \text{ W/m}^2\text{K}; 1,2 \text{ W/m}^2\text{K}; 1,4 \text{ W/m}^2\text{K}$

BALCONY DOORS SPECIFICATION

MATERIAL

Laminated pine
 Meranti or Oak as option

ALUMINIUM CLADDING

Aluron Nordic aluminum cladding painted in RAL color.

GLAZING

2 layer or 3 layer glazing sets.

Available glass function: Hardened, Laminated, Self-cleaning, Sunreduction, Noisereduction, Stained glass, etc.

Swisspacer V hot edge in glazing available for request.

PANEL

Special Poliurethane laminated sandwich panel

Panel with vertical rows or flush surface on outside

PAINTING

Painting system in accordance to SigmaKalon system

3-layer system: Impregnation, Primary and Top coat. Available Painted in all colors in accordance to NCS or RAL color charts.

Could be painted in 2 colors for the special request

Assa Abloy hinges with bulgary protection pins.

3D regulation hinges

ESPAGNOLETTE

Fix Sweden espagnolette system

CLOSING

Doors closed by the handles

Handles installed on the outside and inside of the door

Doors closed by the thumb knock (butterfly) on the inside

Cylinder locks available as option.

Available handles - see page no.9 for details.

THRESHOLD

Four types of treshols available for outward opening doors:

Wood treshold made in oak - not paited (57 mm high)

Aluminium treshold (35 mm high)

Fiberglass threshold in pine colour (25 mm) - meet TEK'10 requirements

Wood-alu threshold (25 mm) - meet TEK'10 reuirements

All available tresholds presented on page no. 8.

SEALING

Q-lon weather strip

Trelleborg glazing seals

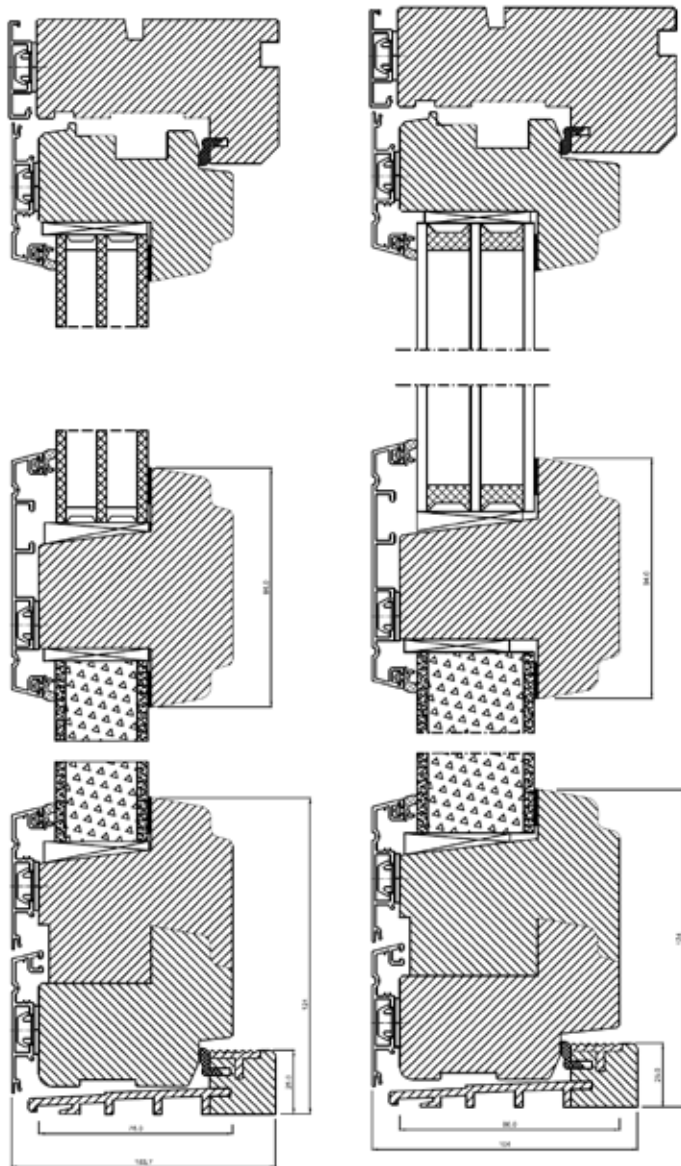

Balcony doors
 $U_w = 1,0 \text{ W/m}^2\text{K}$

Drawing no. P-13-09

PASSIVE $U_w = 0,8 \text{ W/m}^2\text{K}$

Drawing no. P-13-10



THRESHOLDS TO OUTWARD OPENING B.DOORS

AVAILABLE THRESHOLDS TO OUTWARD OPENING BALCONY DOORS

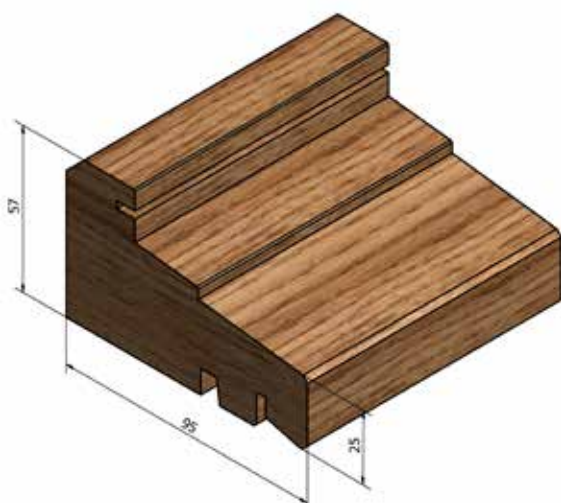

Wood threshold made in oak - not painted (57 mm high)

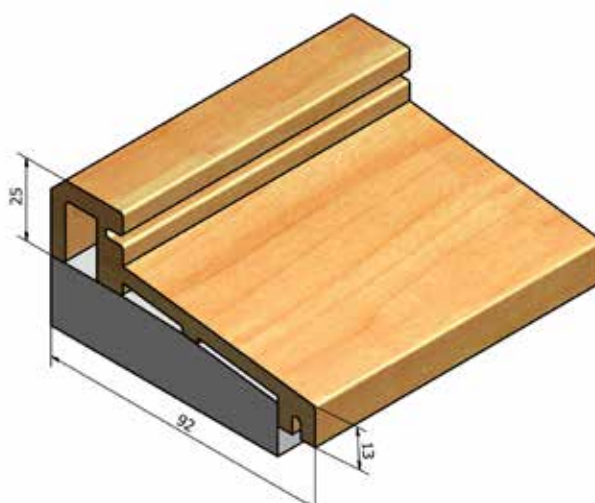

Fiberglass threshold (25+ mm) - meet TEK'10 requirements

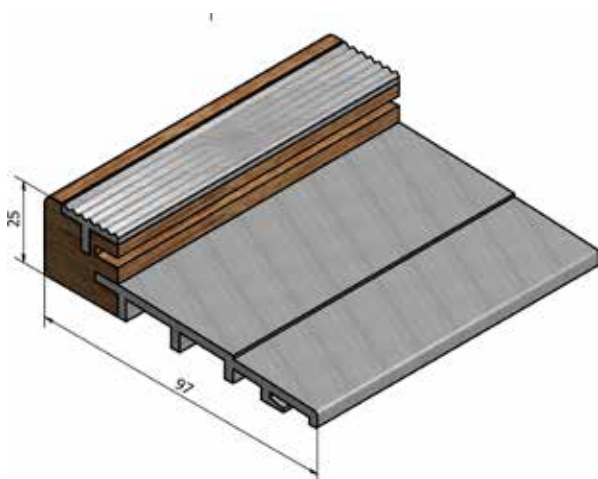

Wood-alu threshold (25 mm) - meet TEK'10 requirements

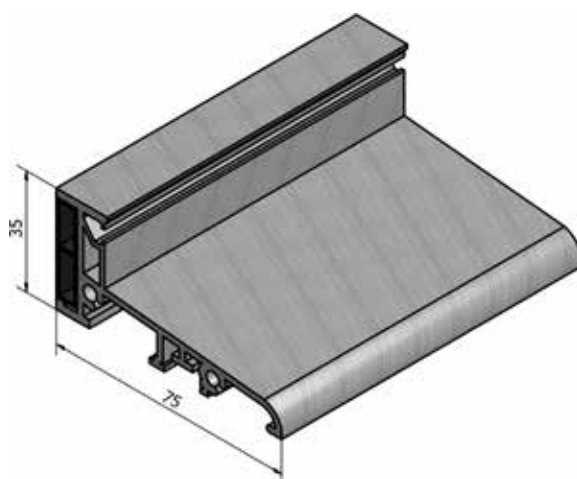

Aluminium threshold (35 mm high)

Four types of thresholds available for outward opening doors:

1) Wood threshold made in oak - not painted (57 mm high)

High threshold which do not meet requirements for handicap users.

This threshold is mostly used for private houses. Known as best thermal resistance threshold available for the doors.

2) Fiberglass threshold in pine colour (25 mm) - meet TEK'10 requirements

Threshold which is popular as a solution which follow TEK'10 requirements.

Required to be correctly installed because of the outside drip going down from the edge of the construction which it is placed on.

3) Wood-alu threshold (25 mm) - meet TEK'10 requirements

Most popular traditional threshold suitable for handicap users.

Threshold produced in connection of oak wood and aluminum

4) Aluminium threshold (35 mm high).

HANDLES FOR OUTWARD OPENING WINDOWS AND DOORS

AVAILABLE HANDLES FOR OUTWARD OPENING WINDOWS



HANDLE FIX 3161



HOPPE TOKYO MINI



HOPPE TOKYO LOCKABLE



HABO COPENHAGEN



FIX VINGA

AVAILABLE CLOSERS FOR OUTWARD OPENING WINDOWS



STANDARD LUKKER



HABO COPENHAGA LUKKER



CASEMENT FASTENER



STYLISH CASEMENT FASTENER

AVAILABLE HANDLES FOR OUTWARD OPENING BALCONY DOORS



HABO COPENHAGEN



HOPPE TOKYO



FIX VINGA

CHILD SAFTY SECURITY HARDWARE



HOPPE KISI



INWARD OPENING WINDOWS

INWARD OPENING WINDOWS

DREHKIP - TILT & TURN

Inward opening windows, produced in accordance to Euro window profile. One handle window with two functions: Tilt function for ventilating where sash open inward aprox. 8 cm and Turn function for full opening position.

Could be produced in windows U-value range :
 $U_w = 0,8 \text{ W/m}^2\text{K}$; $1,2 \text{ W/m}^2\text{K}$; $1,4 \text{ W/m}^2\text{K}$

WINDOWS SPECIFICATION

MATERIAL

Laminated pine

Meranti or Oak as option

FRAME THICKNESS

Frame 68 mm ($U_w = 1,4 \text{ W/m}^2\text{K}$) - 2 layer glass

Frame 68 mm ($U_w = 1,2 \text{ W/m}^2\text{K}$) - 3 layer glass

Frame 68 mm ($U_w = 0,8 \text{ W/m}^2\text{K}$) - 3 layer glass

GLAZING

2 layer or 3 layer glazing sets.

Available glass function: Hardened, Laminated, Self-cleaning, Sunreduction, Noisereduction, Stained glass, etc.
Swisspacer V hot edge in glazing available for request.

PAINTING

Painting system in accordance to SigmaKalon system

3-layer system: Impregnation, Primary and Top coat.

Available Painted in all colors in accordance to NCS or RAL color charts.

Could be painted in 2 colors for the special request

HARDWARE and ESPAGNOLETT

ROTO or SIEGIENIA - German tilt & turn window hardware systems

CLOSING

Windows closed by the handles

See page no. 15. for details.

GLAZING LISTS

Windows glazed from outside or inside (for request)

PVC glazing beads in all windows painted in NCS S0502Y

Wooden list in all other window colors

GLAZING BEADS

Aluminium glazing beads

SEALING

Trelleborg gaskets

CHILD SAFETY

Windows could be equipped in Hoppe KISI child safety security device or equipped in lockable handle

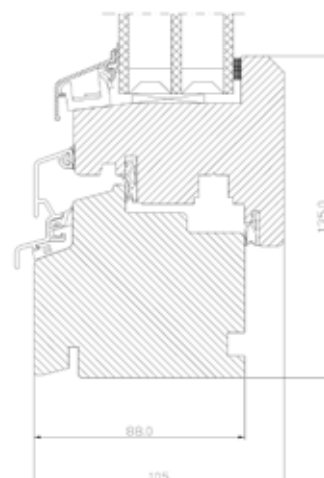
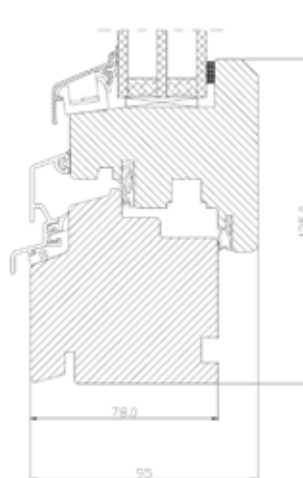
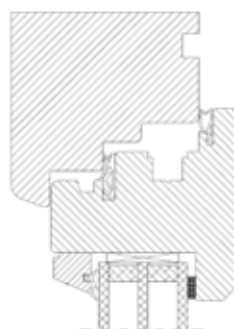
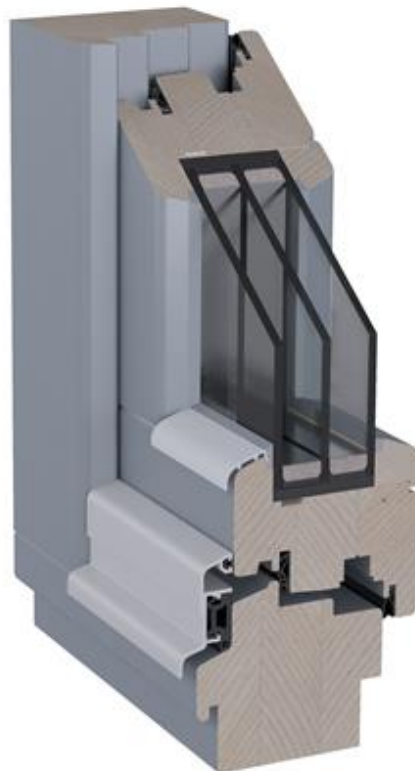

Window $U_w = 1,2 \text{ W/m}^2\text{K}$

Drawing no. P-13-15

PASSIVE $U_w = 0,8 \text{ W/m}^2\text{K}$

Drawing no. P-13-14



ALUMINIUM CLADED INWARD OPENING WINDOWS

DREHKIP - TILT & TURN

Aluminium Cladded Inward opening windows.
Tilt function for ventilating where sash open inward approx. 8 cm and Turn function for full opening position.

Could be produced in windows U-value range :
 $U_w = 0,8 \text{ W/m}^2\text{K}$; $1,2 \text{ W/m}^2\text{K}$; $1,4 \text{ W/m}^2\text{K}$

WINDOWS SPECIFICATION

MATERIAL

Laminated pine

Meranti or Oak as option

FRAME THICKNESS

Frame 68 mm ($U_w = 1,4 \text{ W/m}^2\text{K}$) - 2 layer glass

Frame 68 mm ($U_w = 1,2 \text{ W/m}^2\text{K}$) - 3 layer glass

Frame 68 mm ($U_w = 0,8 \text{ W/m}^2\text{K}$) - 3 layer glass

ALUMINIUM CLADDING

Windows with aluminium cladding available in 3 different

Aluminium cladding versions: Classic, Linear, Quadro

See page X for aluminium version pictures

GLAZING

2 layer or 3 layer glazing sets.

Available glass function: Hardened, Laminated, Self-cleaning, Sunreduction, Noisereduction, Stained glass, etc.
Swisspacer V hot edge in glazing available for request.

PAINTING

Painting system in accordance to SigmaKalon system

3-layer system: Impregnation, Primary and Top coat.

Available Painted in all colors in accordance to NCS or RAL color charts.

Could be painted in 2 colors for the special request

HARDWARE and ESPAGNOLETT

ROTO or SIEGIENIA - German tilt & turn window hardware systems

CLOSING

Windows closed by the handles

See page no. 15. for details.

SEALING

Aluron/Primo gaskets

Trelleborg glazing seals

CHILD SAFETY

Windows could be equipped in Hoppe KISI child safety security device or equipped in lockable handle

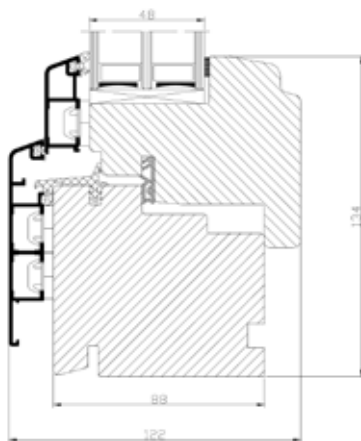
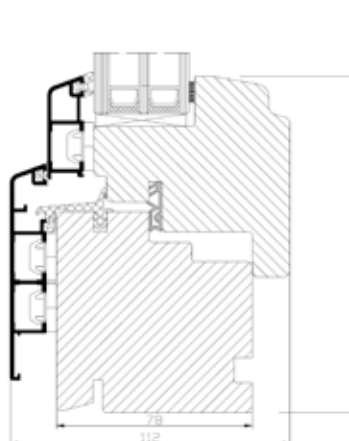
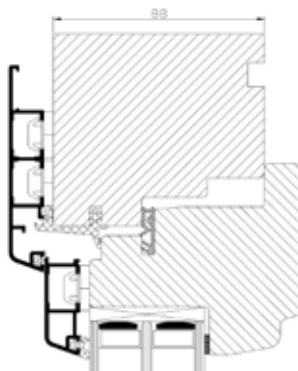
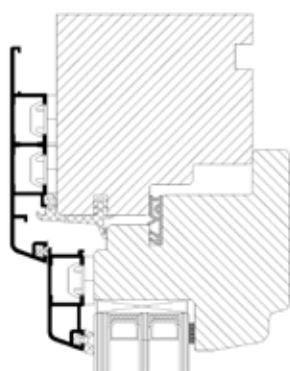

Window $U_w = 1,2 \text{ W/m}^2\text{K}$

Drawing no. P-13-18

PASSIVE $U_w = 0,8 \text{ W/m}^2\text{K}$

Drawing no. P-13-19

INWARD OPENING BALCONY DOORS (FRENCH DOORS)

INWARD OPENING BALCONY DOORS

Inward opening balcony doors with 3-point locking system espagnolette.

Doors equipped with sash brake, which stops in any opening position.

Balcony doors available with the panel in the bottom part of the doors or fully glazed.

Could be produced in product U-value range:

$U_w = 0,8 \text{ W/m}^2\text{K}; 1,2 \text{ W/m}^2\text{K}; 1,4 \text{ W/m}^2\text{K}$

BALCONY DOORS SPECIFICATION

MATERIAL

Laminated pine

Meranti or Oak as option

GLAZING

2 layer or 3 layer glazing sets.

Available glass function: Hardened, Laminated, Self-cleaning,

Sunreduction, Noisereduction, Stained glass, etc.

Swisspacer V hot edge in glazing available for request.

PANEL

Special Poliurethane laminated sandwich panel

Panel with vertical rows or flush surface on outside

PAINTING

Painting system in accordance to SigmaKalon system

3-layer system: Impregnation, Primary and Top coat. Available Painted in all colors in accordance to NCS or RAL color charts.

Could be painted in 2 colors for the special request

HARDWARE

Fix Sweden espagnolette system

CLOSING

Doors closed by the handles

Handles could be installed on the outside and inside of the door

Doors closed by the thumb knock (butterfly) on the inside

Cylinder locks available as option.

Available handles - see page no.15. for details.

THRESHOLD

Four types of treshols available for outward opening doors:

Wood treshold made by oak - not paited

Aluminium treshold

All available tresholds presented on page no. 14.

GLAZING LISTS

PVC glazing beads in all windows painted in NCS S0502Y Wooden list

in all other window colors

GLAZING BEADS

Aluminium glazing beads

SEALING

Trelleborg gaskets

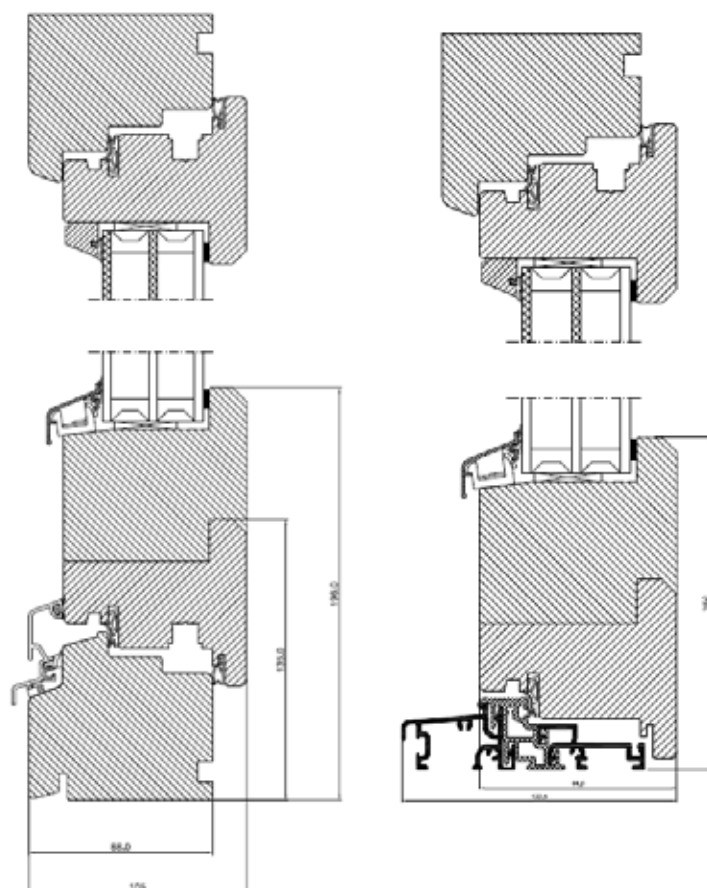

Window $U_w=1,0 \text{ W/m}^2\text{K}$

Drawing no. P-13-16

PASSIVE $U_w=1,0 \text{ W/m}^2\text{K}$

Drawing no. P-13-17

INWARD OPENING BALCONY DOORS (FRENCH DOORS)

ALUMINUM CLADDED INWARD OPENING BALCONY DOORS

Inward opening balcony doors with 3-point locking system espagnolette.
Doors equipped with sash brake, which stops in any opening position. Aluminium cladding installed on the outside of the door to increase the product life time - maintenance free surface on the outside of the doors, resistant to any weather conditions. Balcony doors available with the panel in the bottom part of the doors or fully glazed.
Could be produced in product U-value range :
 $U_w = 0,8 \text{ W/m}^2\text{K}$; $1,2 \text{ W/m}^2\text{K}$; $1,4 \text{ W/m}^2\text{K}$

BALCONY DOORS SPECIFICATION

MATERIAL

Laminated pine
Meranti or Oak as option

ALUMINIUM CLADDING

Aluron Nordic aluminum cladding painted in RAL color.

GLAZING

2 layer or 3 layer glazing sets.
Available glass function: Hardened, Laminated, Self-cleaning, Sunreduction, Noisereduction, Stained glass, etc.
Swisspacer V hot edge in glazing available for request.

PANEL

Special Poliurethane laminated sandwich panel
Panel with vertical rows or flush surface on outside

PAINTING

Painting system in accordance to SigmaKalon system
3-layer system: Impregnation, Primary and Top coat. Available Painted in all colors in accordance to NCS or RAL color charts.
Could be painted in 2 colors for the special request

HARDWARE

Fix Sweden espagnolette system

CLOSING

Doors closed by the handles
Handles could be installed on the outside and inside of the door
Doors closed by the thumb knock (butterfly) on the inside
Cylinder locks available as option.
Available handles - see page no. 15.

THRESHOLD

Four types of thresholds available for outward opening doors:
Wood threshold made by oak - not painted
Aluminium threshold
All available thresholds presented on page no. 14.

SEALING

Trelleborg gaskets.

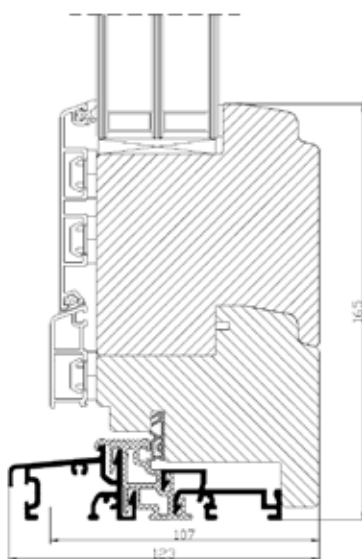
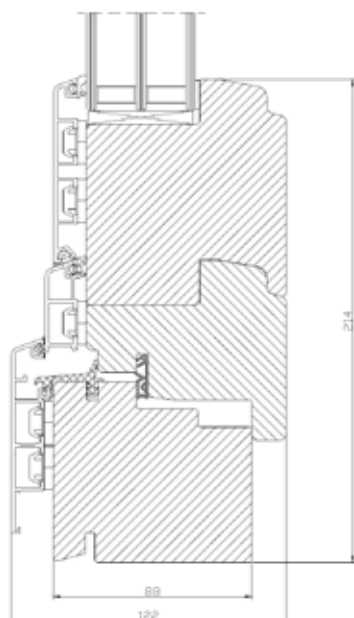
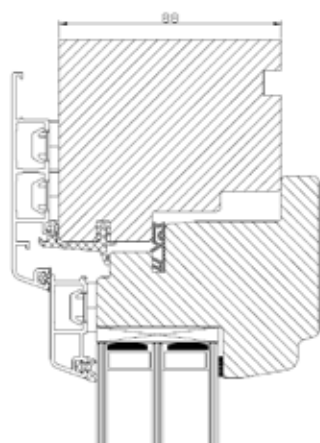
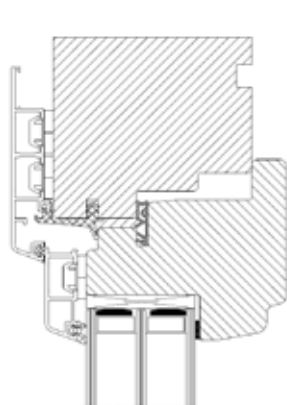

Window $U_w = 1,0 \text{ W/m}^2\text{K}$

Drawing no. P-13-20

PASSIVE $U_w = 1,0 \text{ W/m}^2\text{K}$

Drawing no. P-13-21

THRESHOLDS TO INWARD OPENING B.DOORS

AVAILABLE THRESHOLDS FOR INWARD OPENING BALCONY DOORS

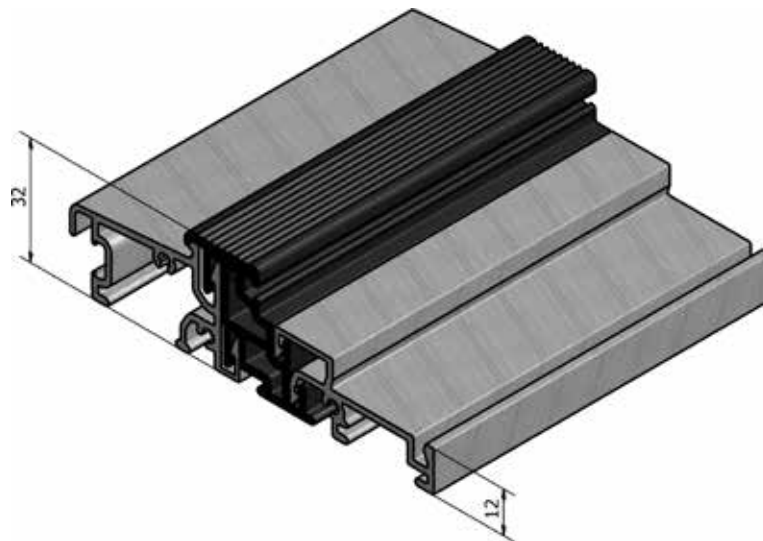

Guttman aluminium treshold

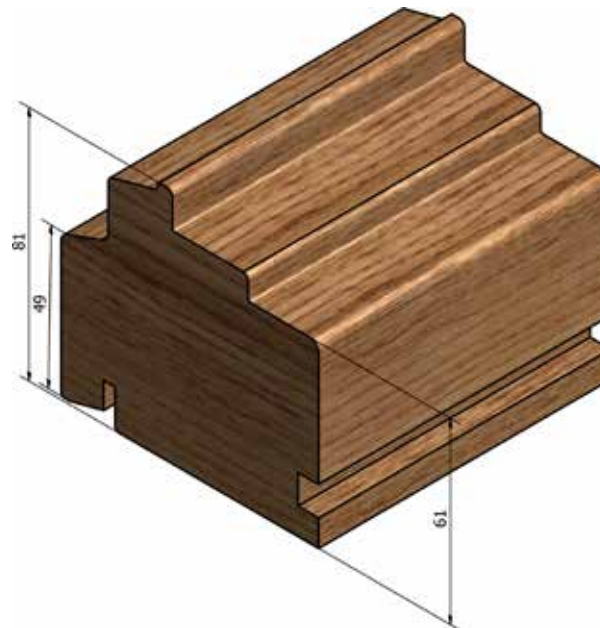

Wood treshold dedicated for French Balcoby Doors

Two types of tresholds available for inward opening doors:

1) Aluminium Guttman Treshold - 32 mm

The lowest treshold for inward opening doors.

Could be instaled deep into the floor what allow to reduce the hight difference between inside and outside (to meet TEK 10 requiremants)

2) Wood treshold made by oak - not paited

Threshold which is typically user for the French balcony doors whrer there is no need to provide very low step for handicap users.

Wood treshold with very good thermal performace.

AVAILABLE HANDLES FOR INWARD OPENING WINDOWS AND FRENCH BALCONY DOORS



FKS 1005



FKS 1005A



FKS 1030



FKS 1030A



FKS 1030



FKS 1030



FKS 1050



FKS 1050A



FKS 1010
Stainless steel handle

BALCONY DOORS HANDLES SETS (handle inside and outside)



outside handle



inside handle

HOPPE TOKYO HANDLE SET

CHILD SAFTY SECURITY HARDWARE



HOPPE KISI



AVAILABLE ALUMINIUM CLADDING FOR INWARD OPENING WINDOWS AND DOORS



ALURON GEMINI CLASSIC



ALURON GEMINI LINEAR



ALURON GEMINI QUADRAT

SIEGIENIA SLIDING DOORS

SIEGIENIA HS PORTAL - SLIDING DOORS

Siegenia HS (Hebeschlebe) doors is high end sliding doors available on the market. Popular solution in western europe which allow to build the doors up to 10 metres long with different sliding schema (picture below).

Although its weight or size the Siegenia hardware allow to gently operate the doors sash, and be very comfortable in operation.

Siegenia HS doors is projected that the sash slides on the inside of the house.

Aluminium threshold which is highly resistant for the damages allow to keep the perfect sash movement. Threshold have been equipped in thermal brake areas which helps to achieve correct thermalbrake performance.

The project of the threshold allow to build it into the floor/ construction which stand on and achieve the lowest floor difference available for sliding doors - 19 mm (pictures below).

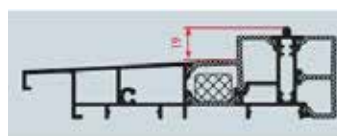
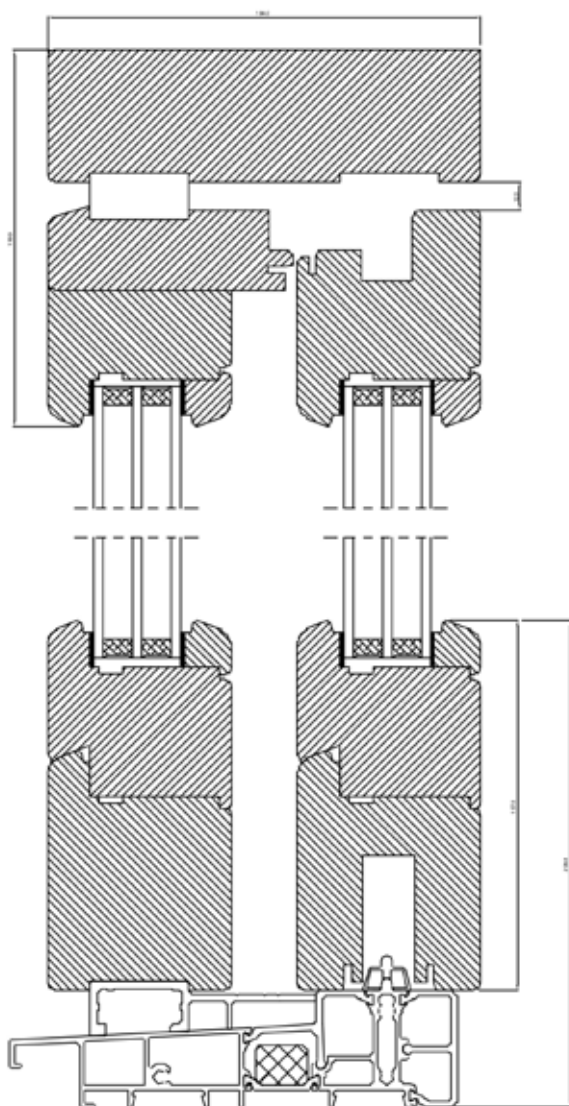

Sliding door threshold



Door threshold installation

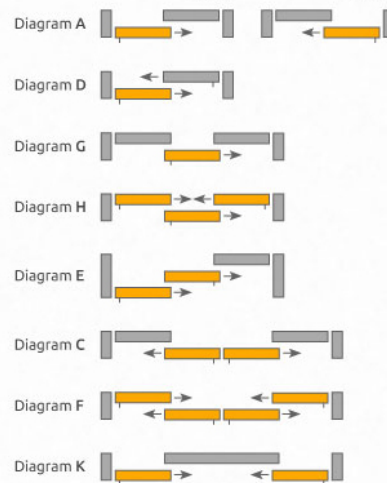

Available opening solutions



Siegenia handle for HS-Portal

Drawing no. P-13-12

SPIILKA TANGO SLIDING DOORS

SPIILKA TANGO SLIDING DOORS



Typical Scandinavian sliding door solution where sash slides on the outside of the door.

Tango sliding doors are equipped in original Spilka hardware. Technical solution of the tightening lines in Spilka Tango doors allow to achieve the best air and rain tightness in sliding doors available in the market.

The project of the doors allow to produce sliding doors which is up to 3,5 metre wide.

The doors are available only in one sash opening scheme.

Tango Sliding doors are available in two different options:

Low wood aluminium threshold -25 mm

Wood threshold made in oak - 57 mm



Hoppe handle set for Sliders

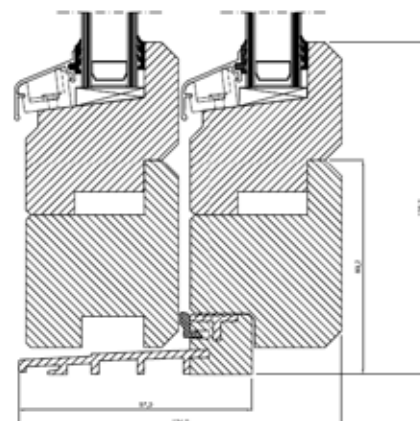
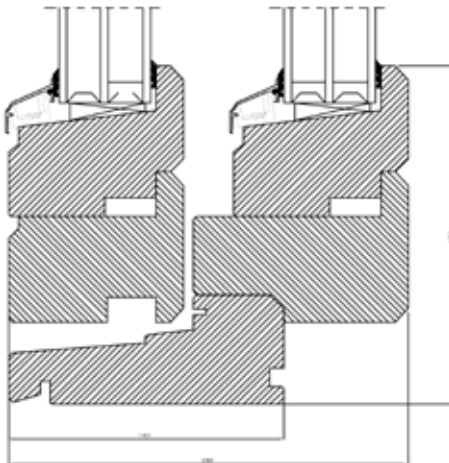
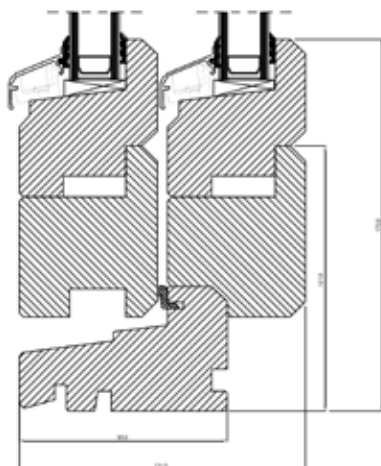
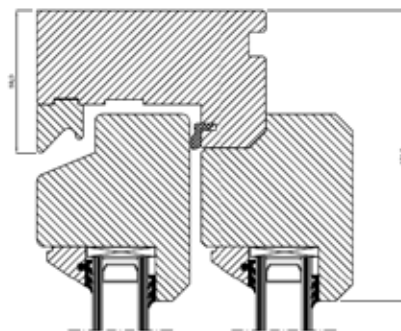
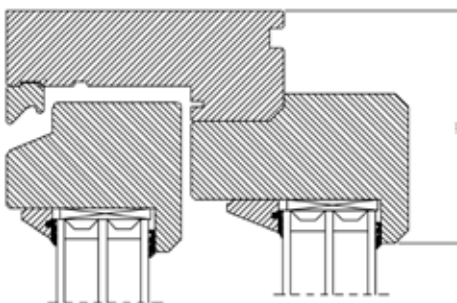
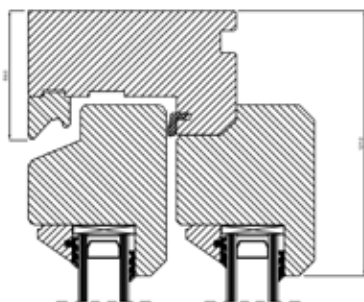

Drawing no. P-13-11

Drawing no. P-13-13

Drawing no. P-13-22

DUDEK H&H PROJECTS



Kværnerbyen, Oslo



Lillohagen, Oslo



Nytt østfoldsykehus , Norway



Norway



Poland



Poland



Norway



Norway



Norway



Ireland



Norway



Ireland



Wrocław



Hanover, Deutschland



Opole



Warszawa



Wrocław



Opole



www.PAGUREK.COM

