

METAL GUTTER INSTALLATION

PAGUREK



KROP

STAL

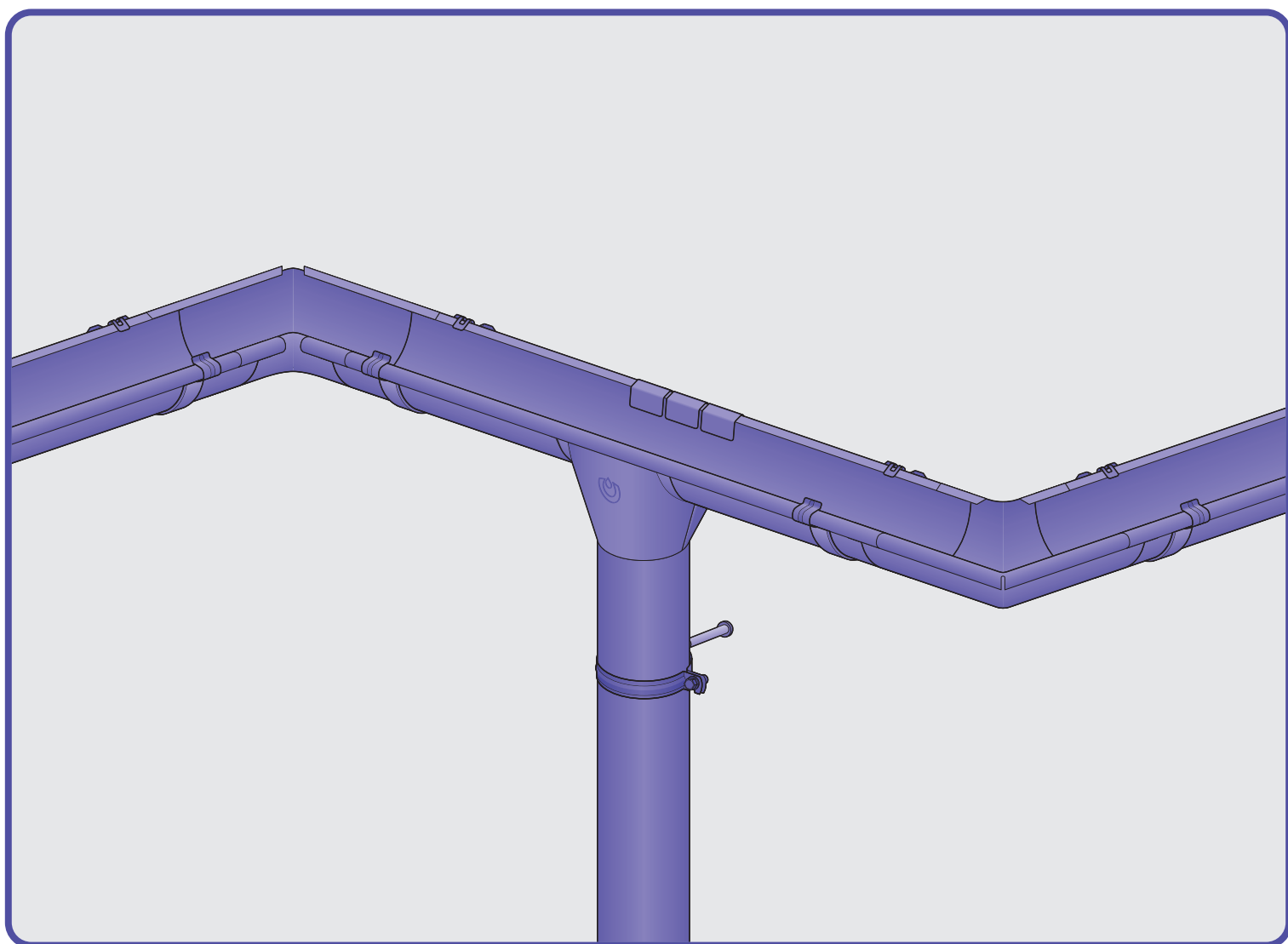

System elements description

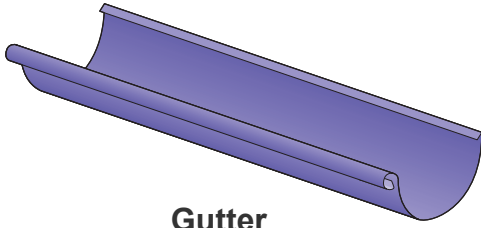

Gutter

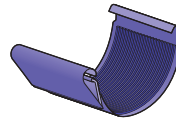

Gutter connector



Universal Stopend

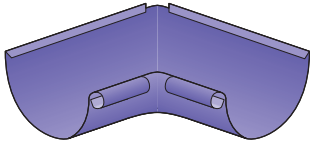

Internal Corner

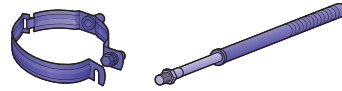

Pipe Clamp

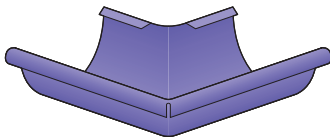

External Corner

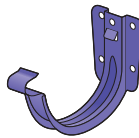

Bracket

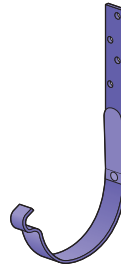

Bracket long

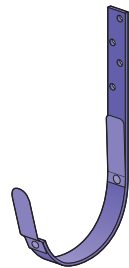

Bracket long BB

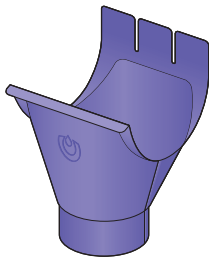

Drain funnel

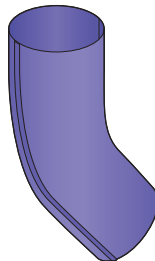

Knee

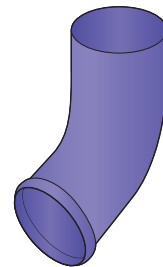

Spout

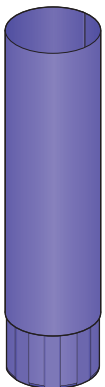

Downpipe

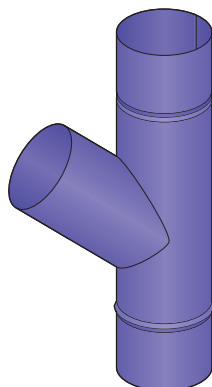

Tee

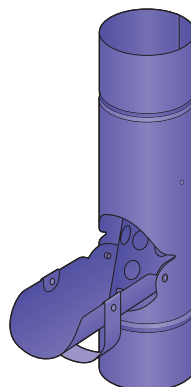

Rain catcher

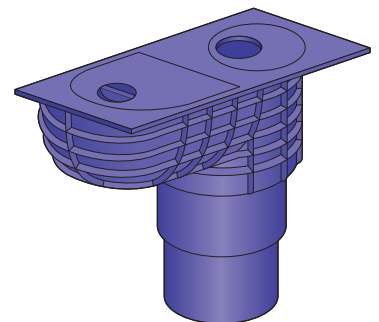

Leaf/debris gully

System elements

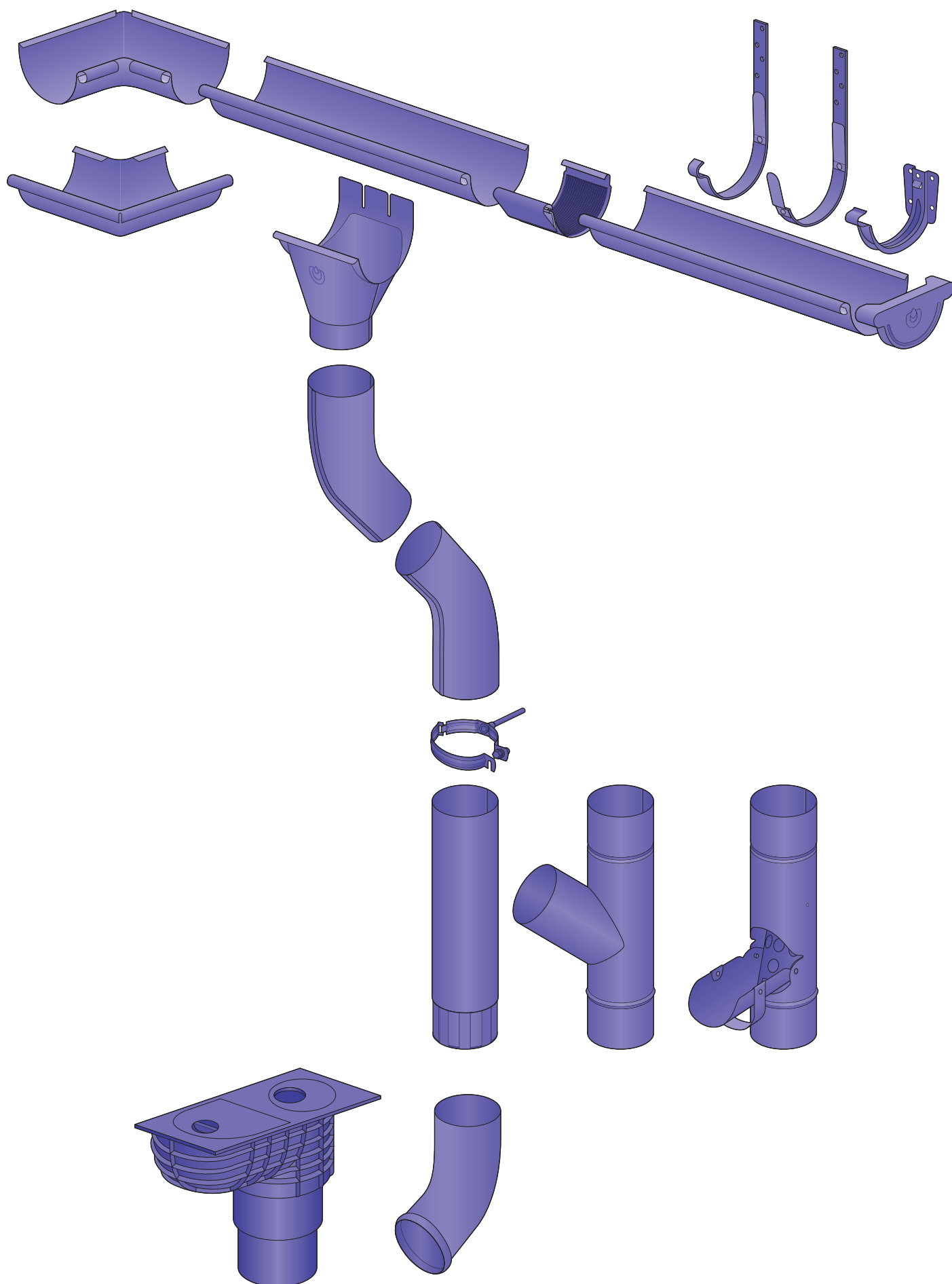

Assembly tools(optional)

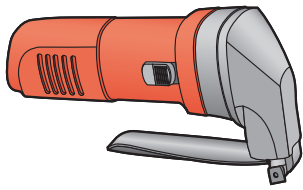

Nibbler

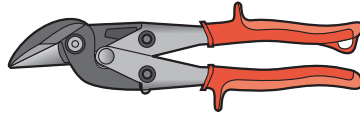

Tin Snips

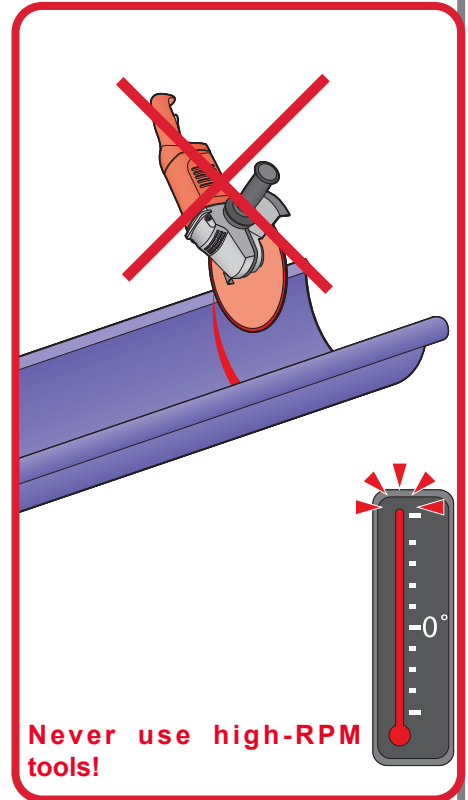

Dril

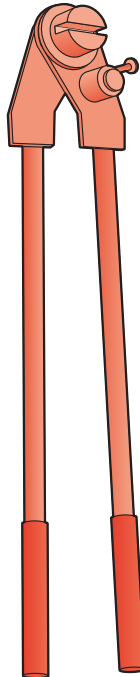

Hook Bender

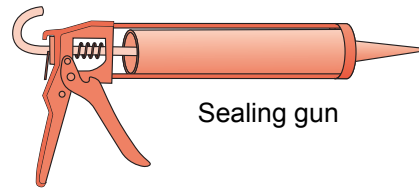

Sealing gun

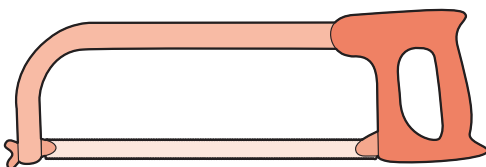

Metal saw

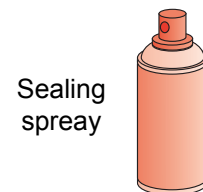

Sealing
spreay

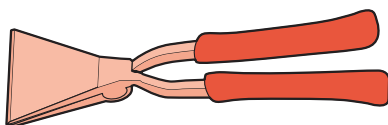

Roofing Pliers

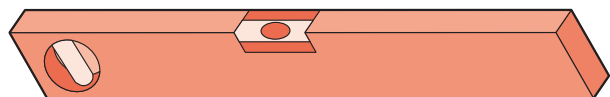

Level

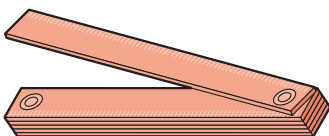

Measurement



Pencil

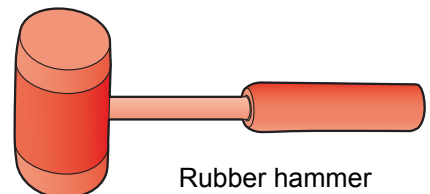

Rubber hammer

Only nibbler or hand tools may be used to cut gutters or downpipes!

1

Roof measurement

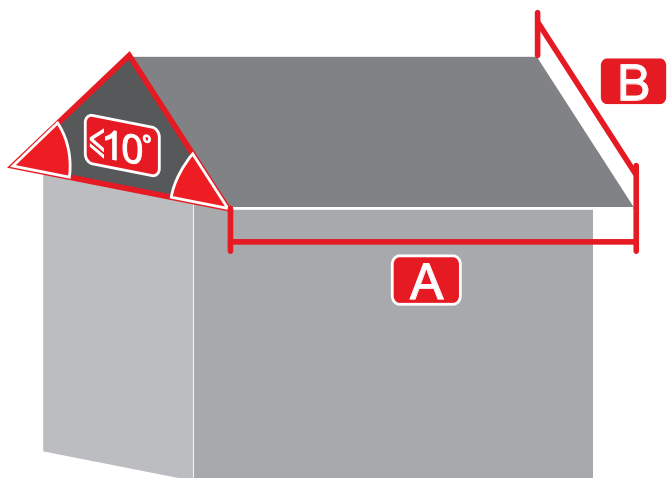

$$E_p = A \times B$$

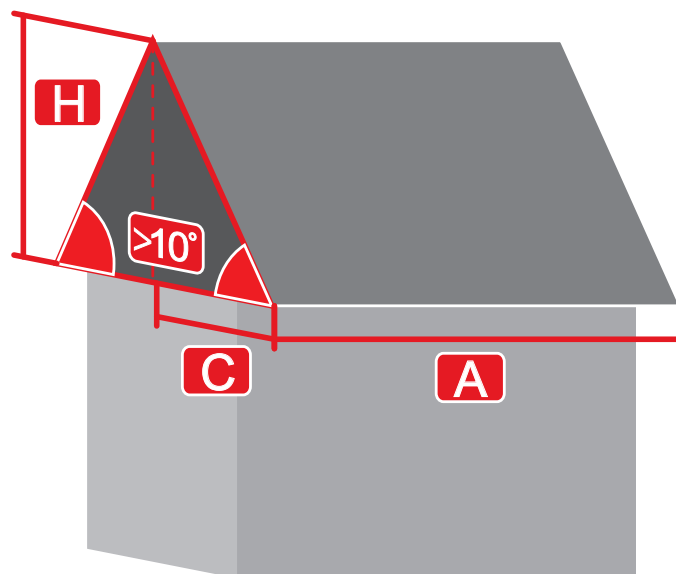

$$E_p = (C + H/2) \times A$$

2

System selection

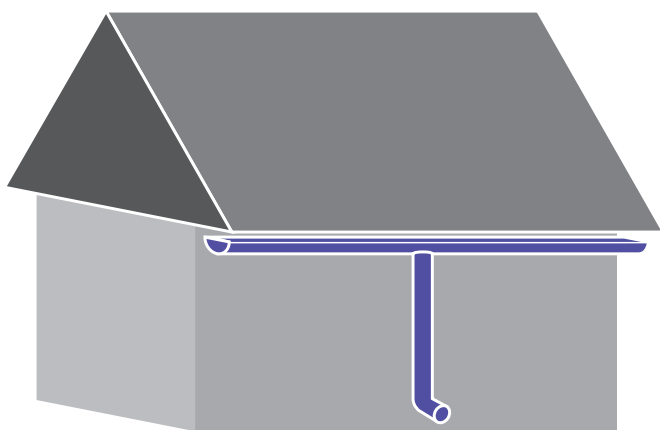

System 125/90 in case of $E_p \leq 100m_2$

System 130/90 in case of $E_p \leq 110m_2$

System 150/100 in case of $E_p \leq 200m_2$

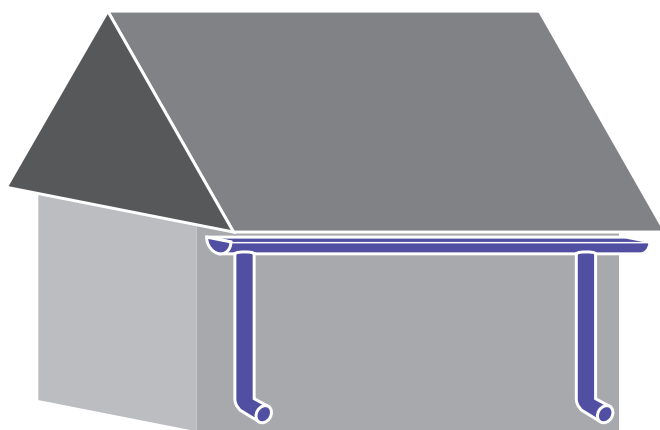

System 125/90 in case of $E_p \leq 200m_2$

System 130/90 in case of $E_p \leq 220m_2$

System 150/100 in case of $E_p \leq 300m_2$

3

Hook bending

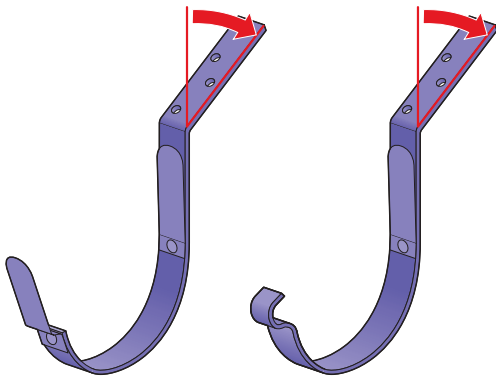
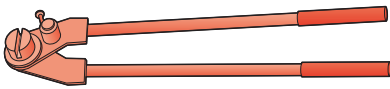
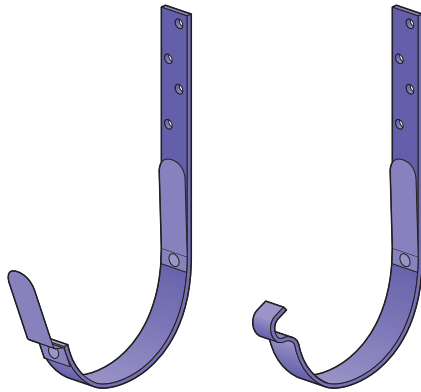

Installation hook at the highest point

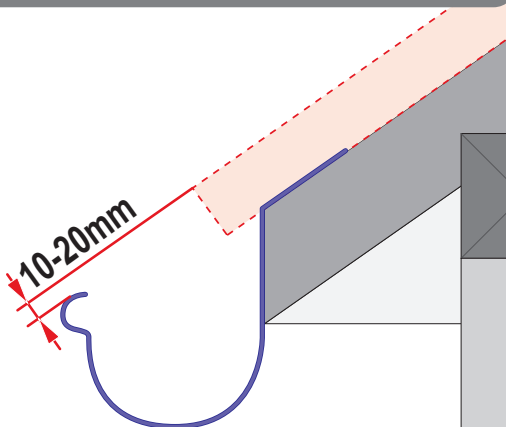

Gutter tilt min 0.3% / 1m

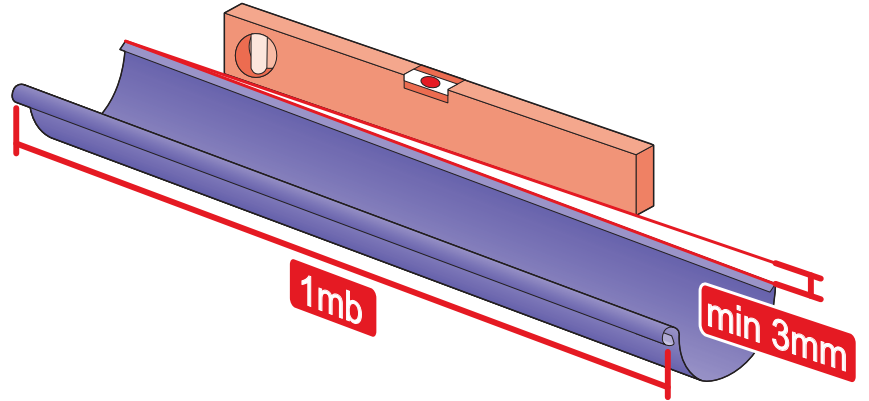

Spacing of hooks

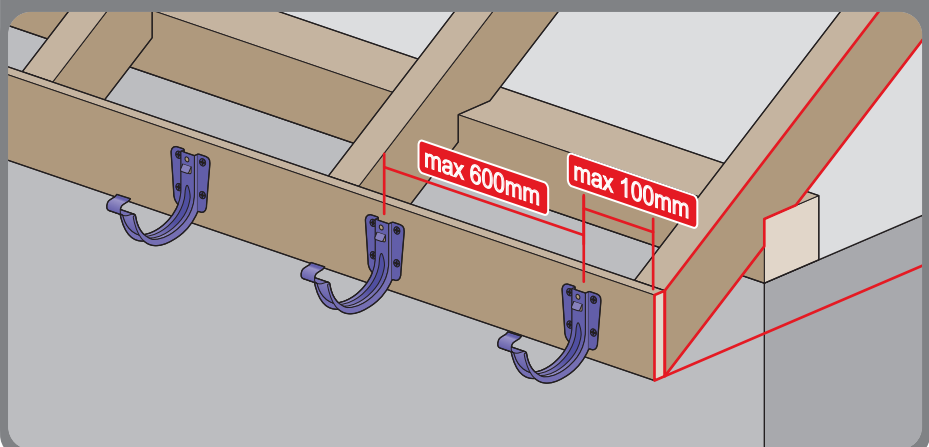
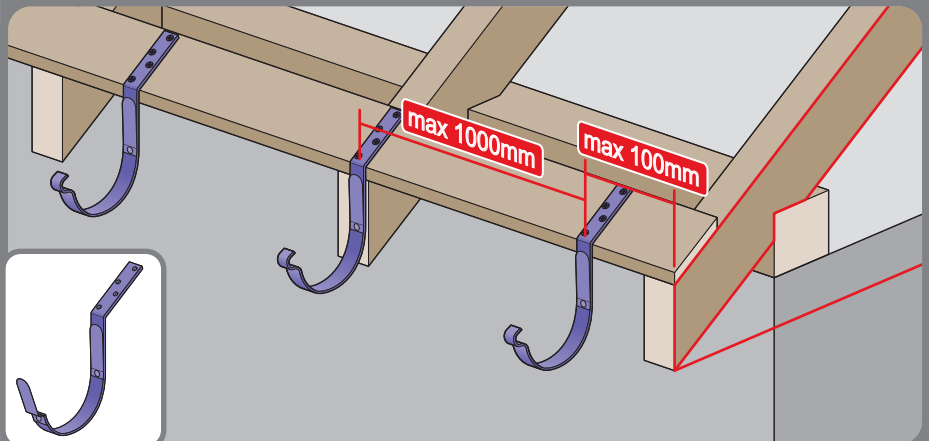
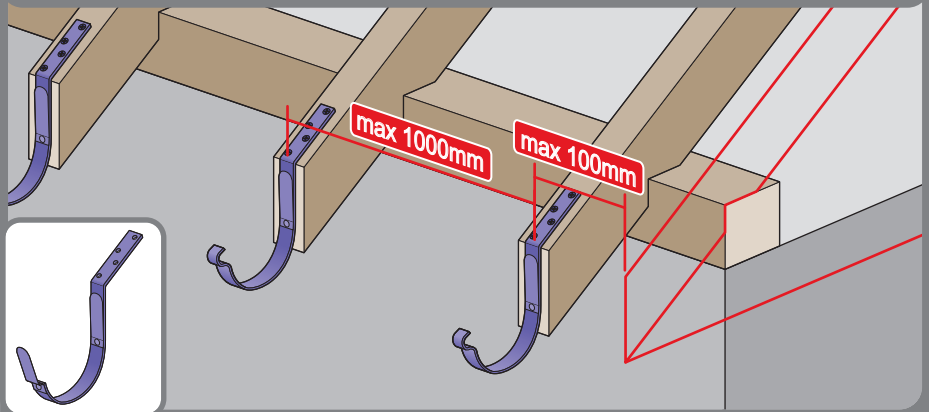

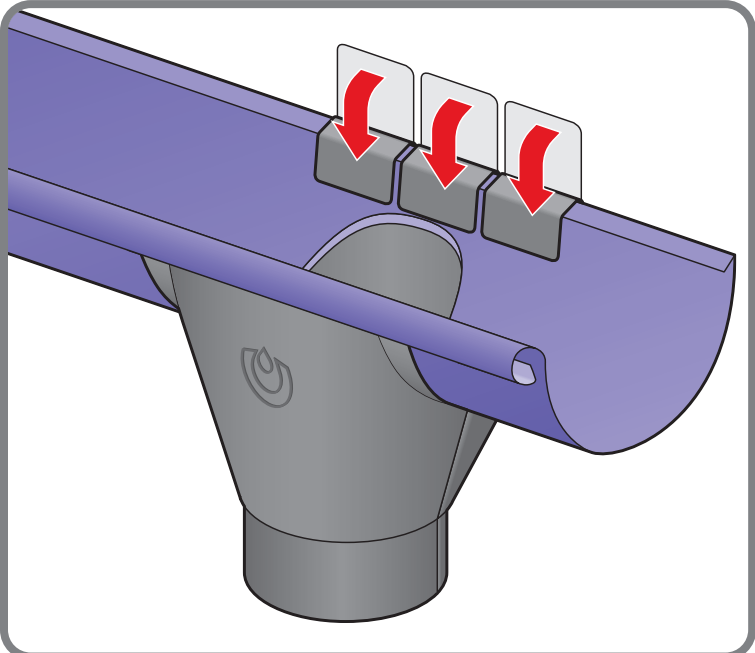
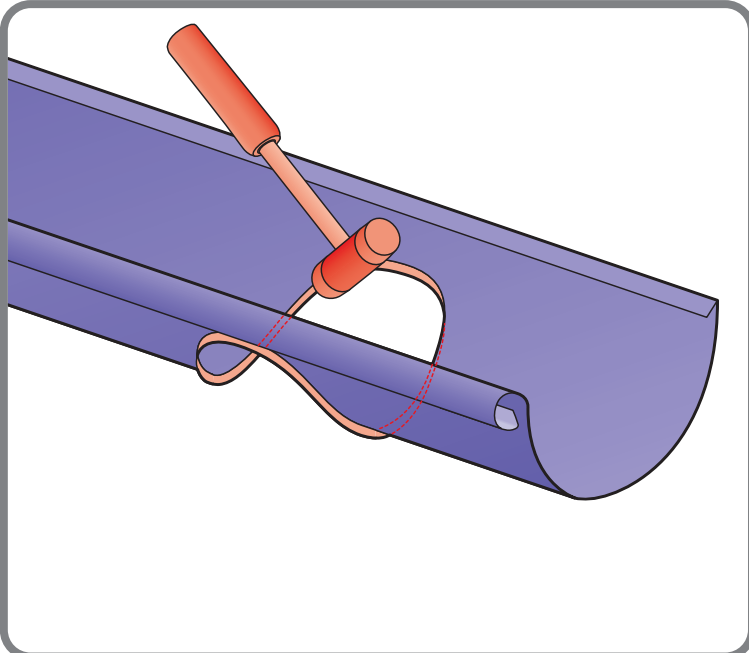
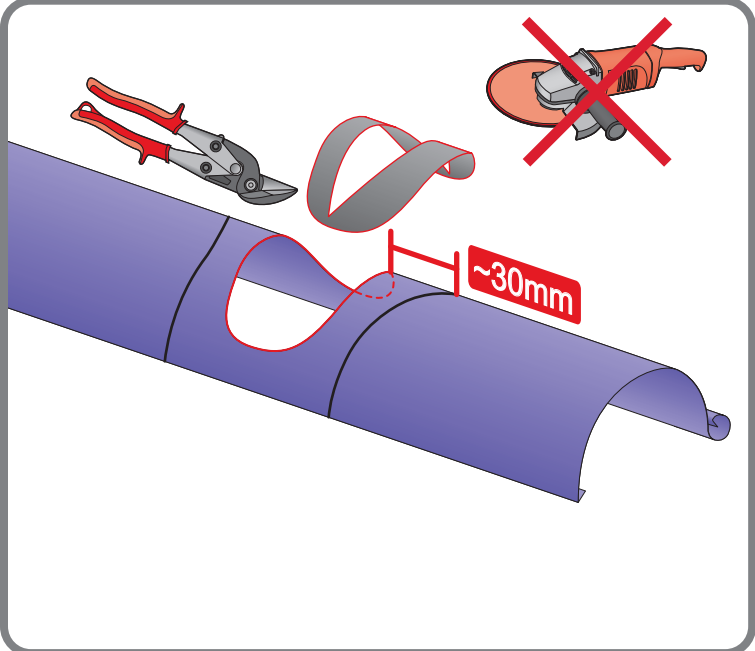
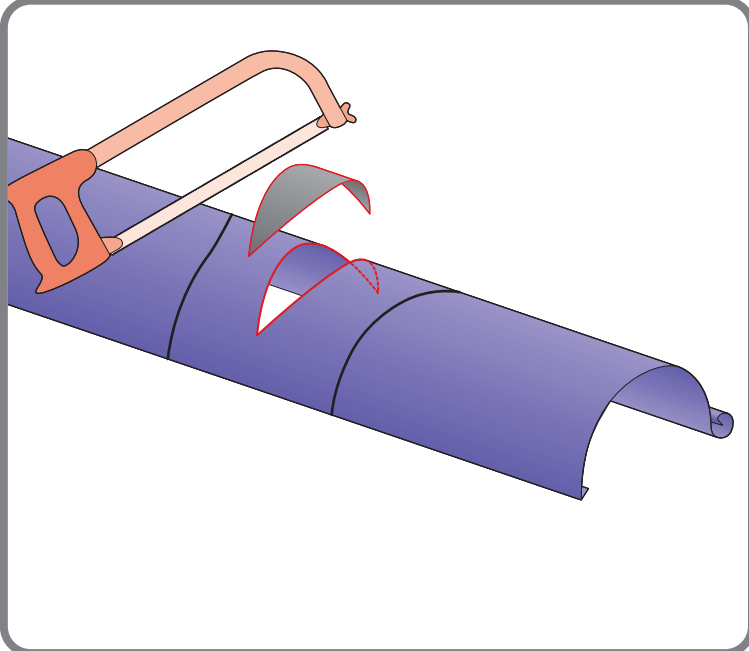
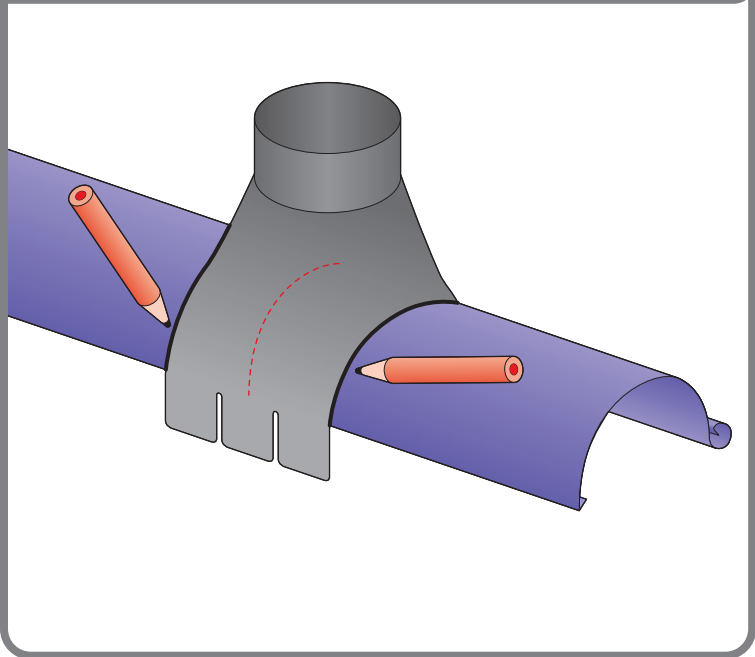
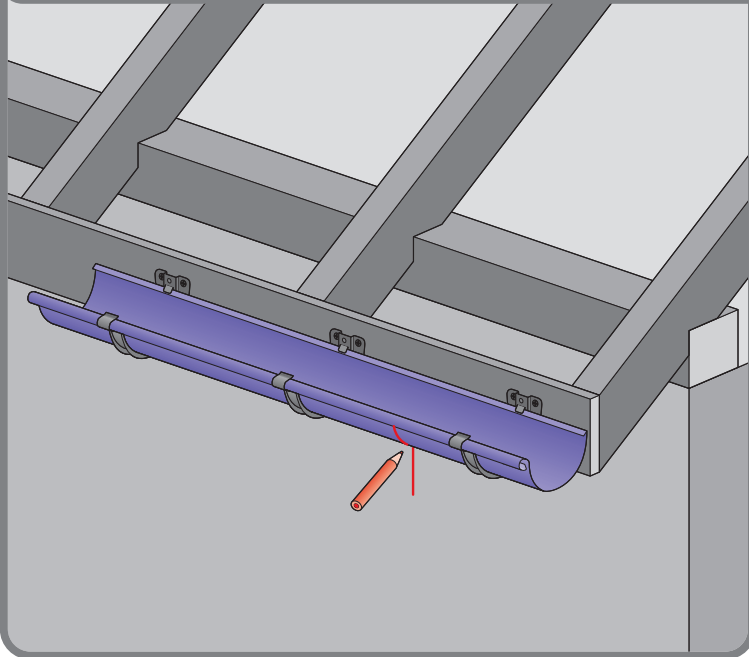

5

Connection of Gutters with a clamp.

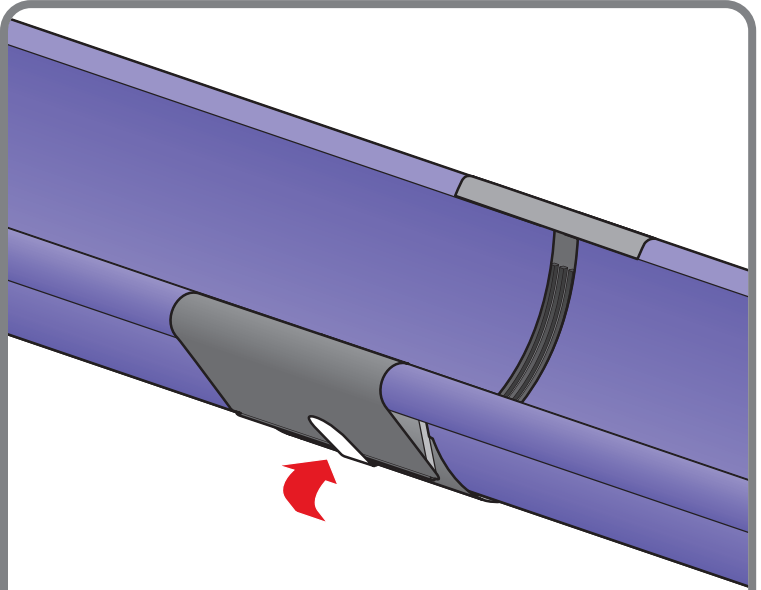
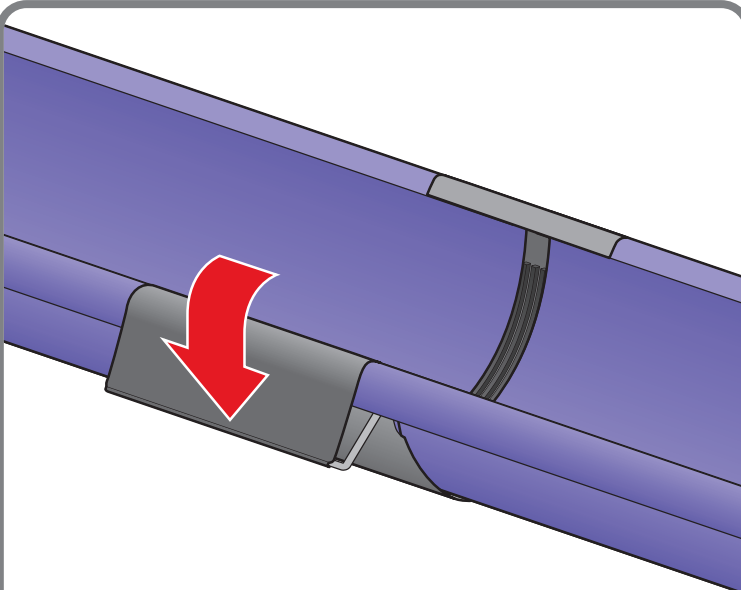
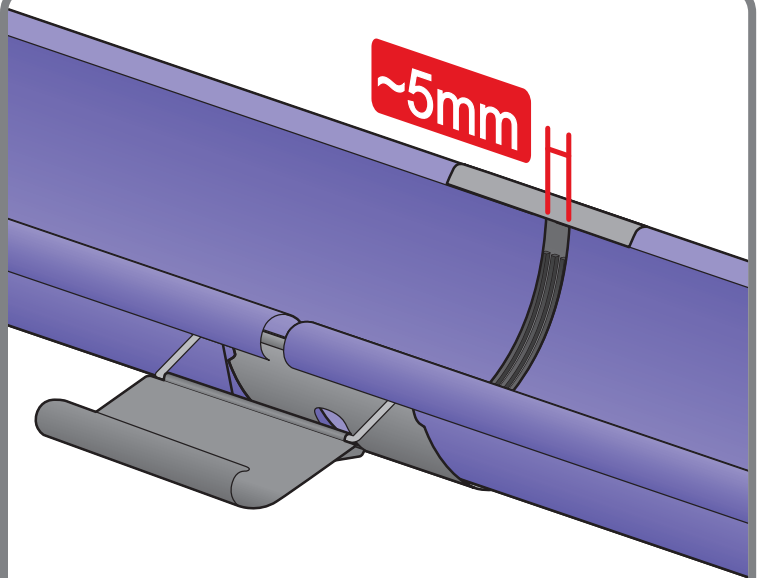
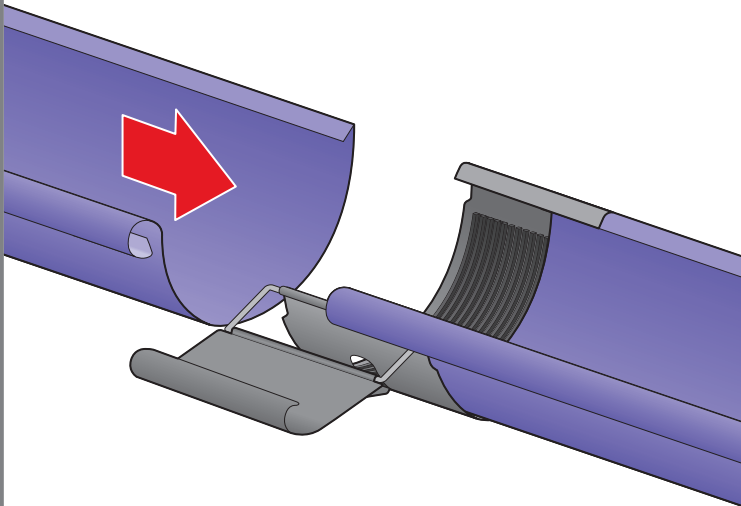
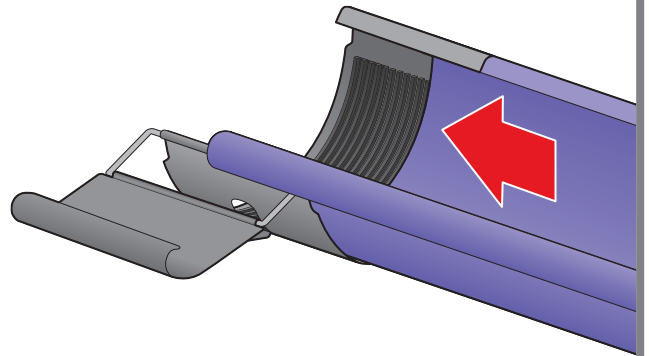
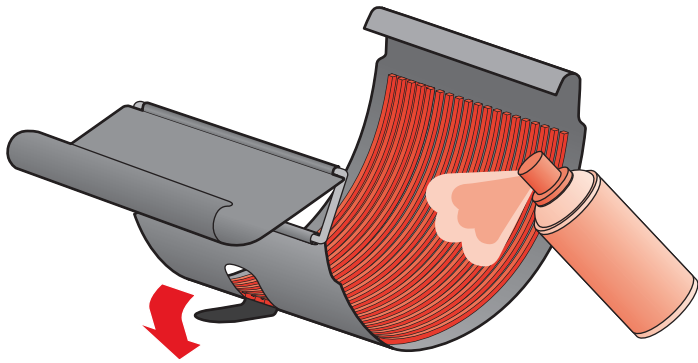

6

Stopend assembly.

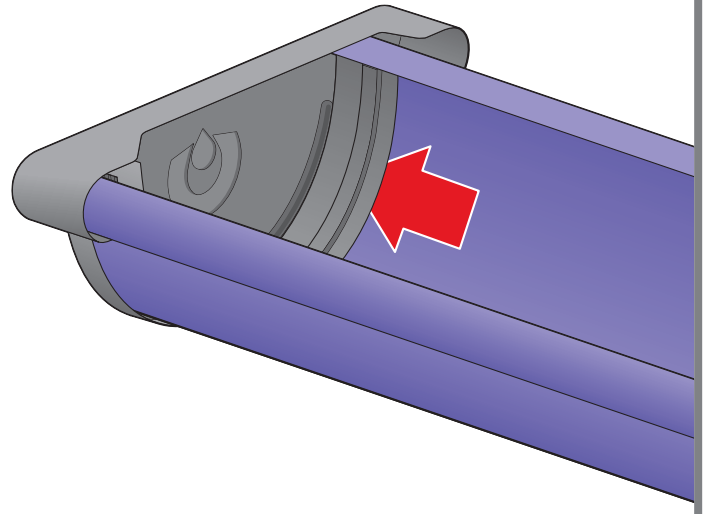
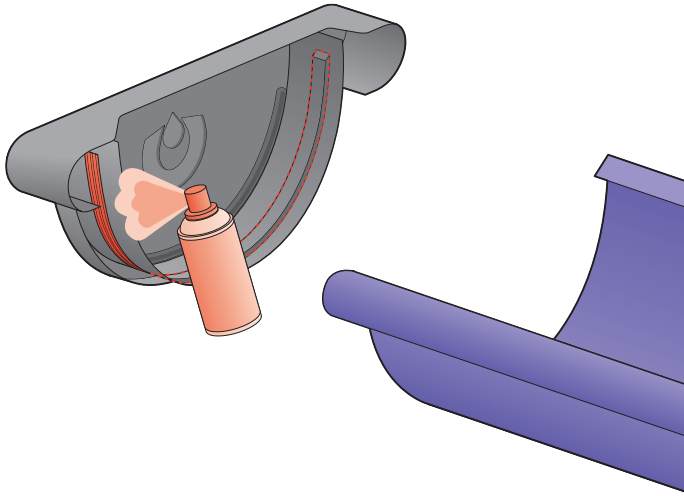

7

Clamp mounting

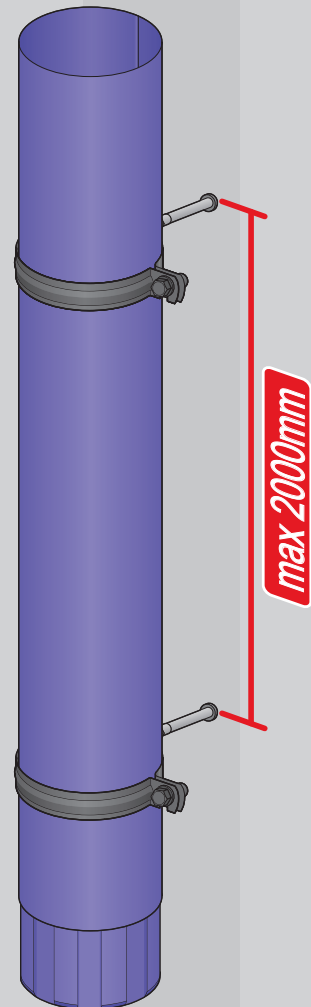
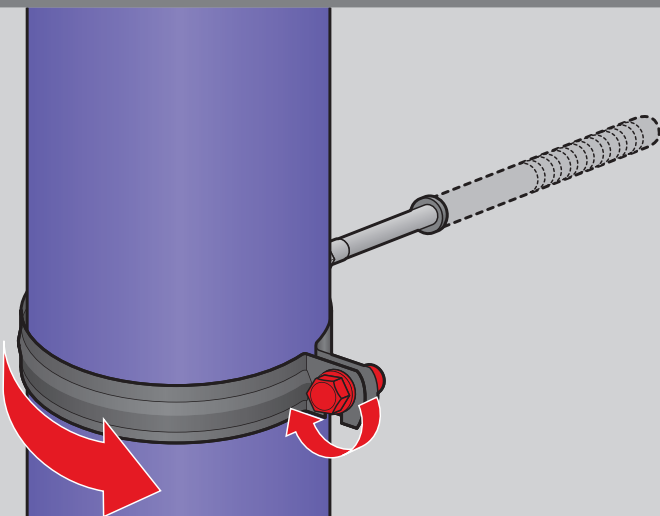
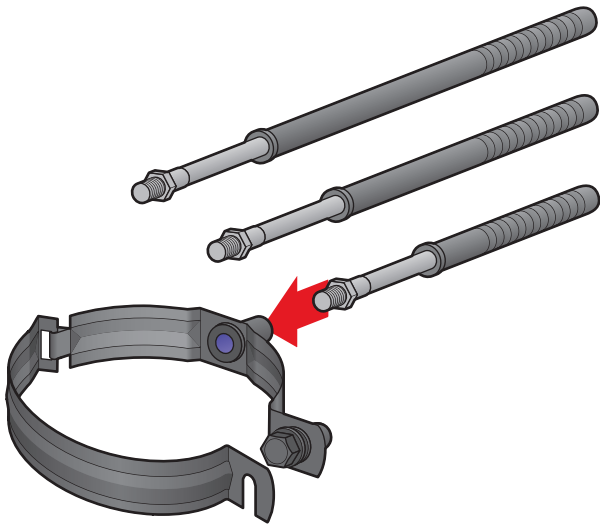

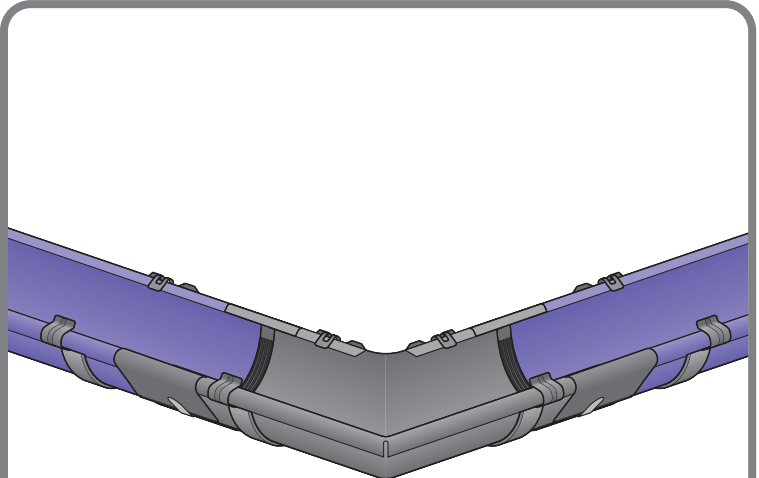
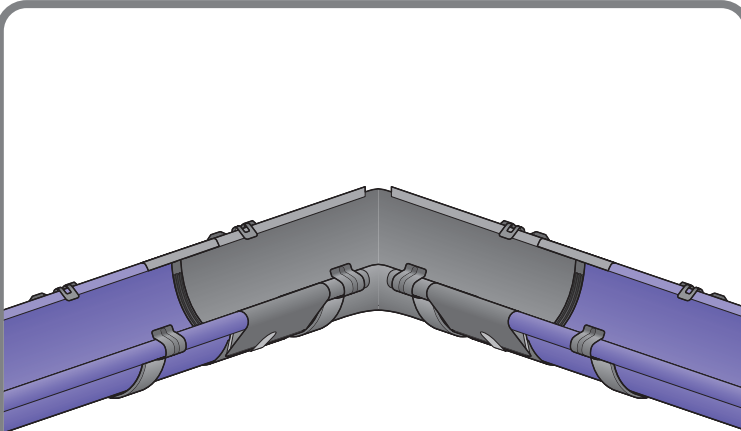
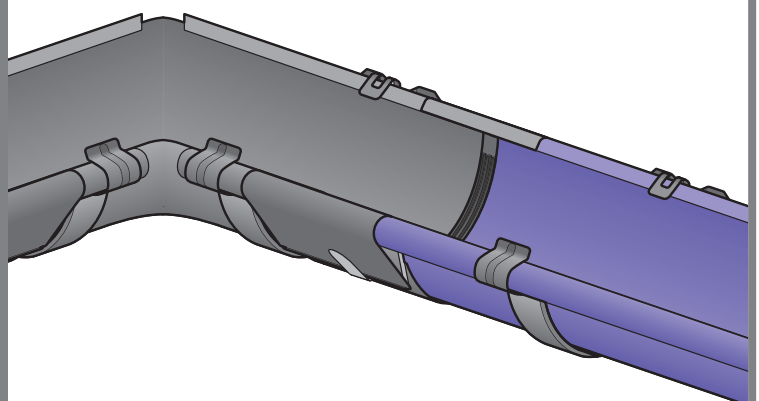
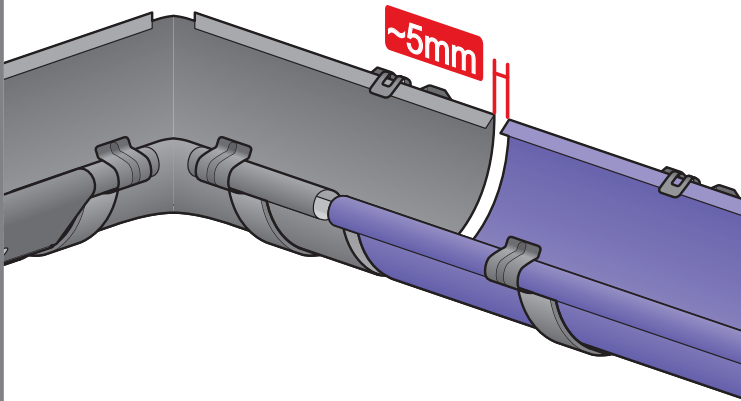
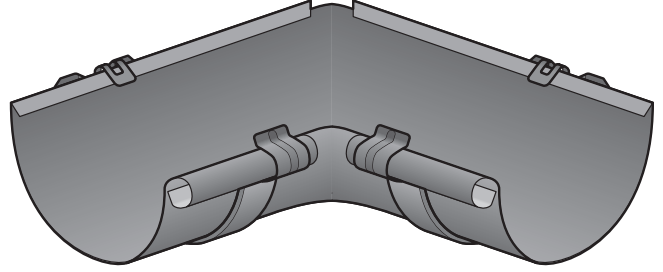
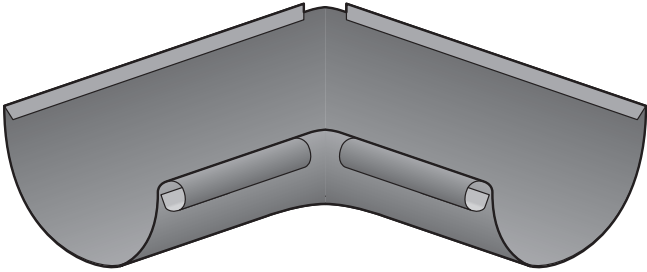

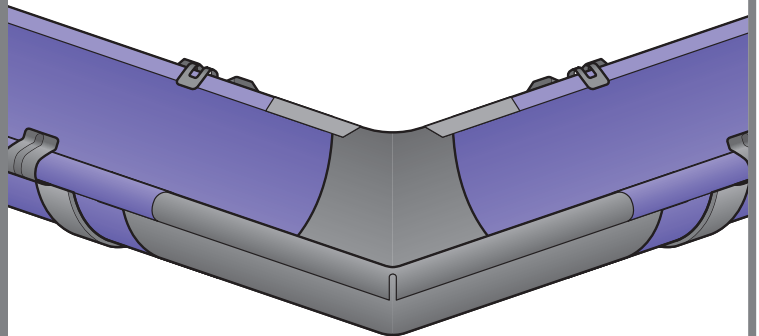
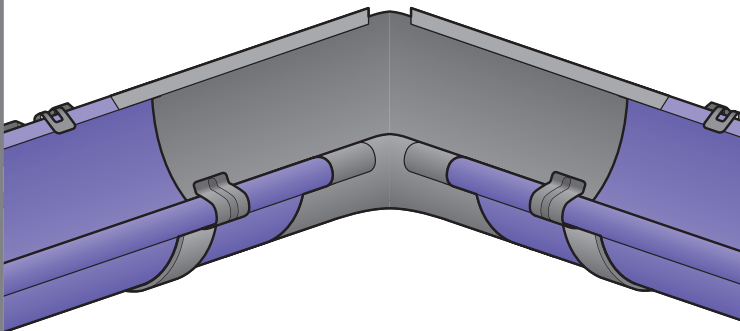
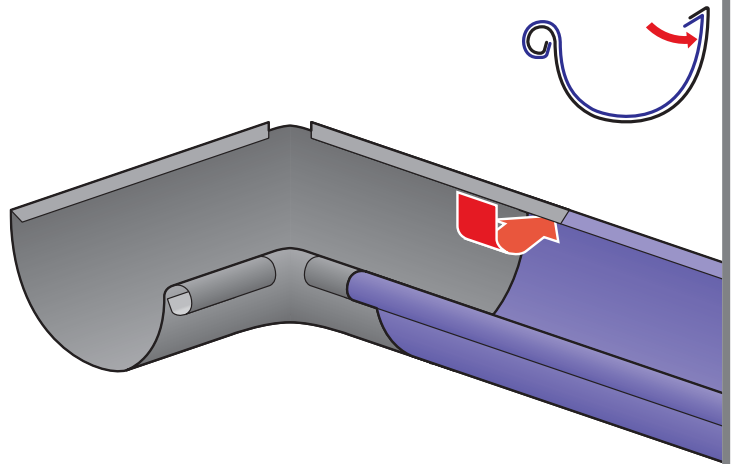
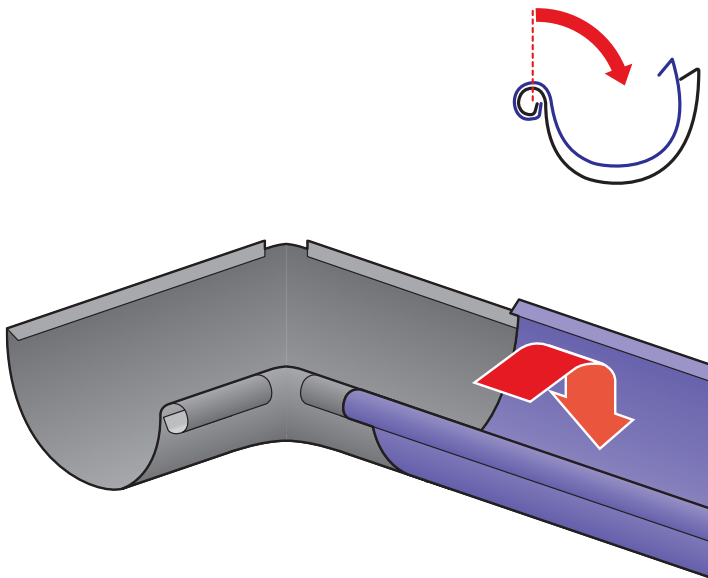
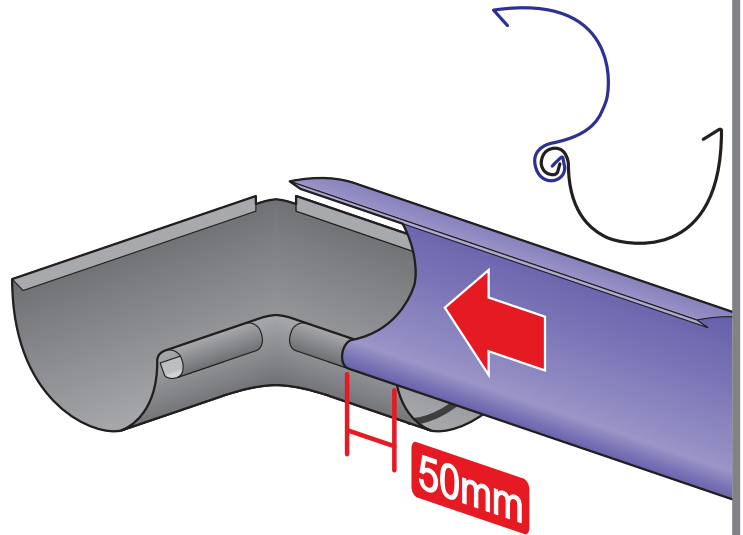
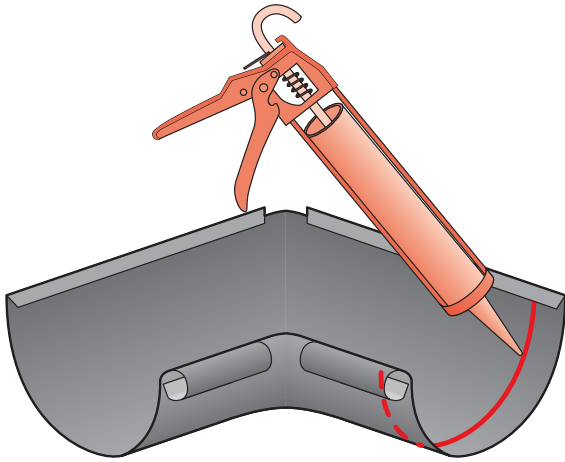

10

Downpipe connection

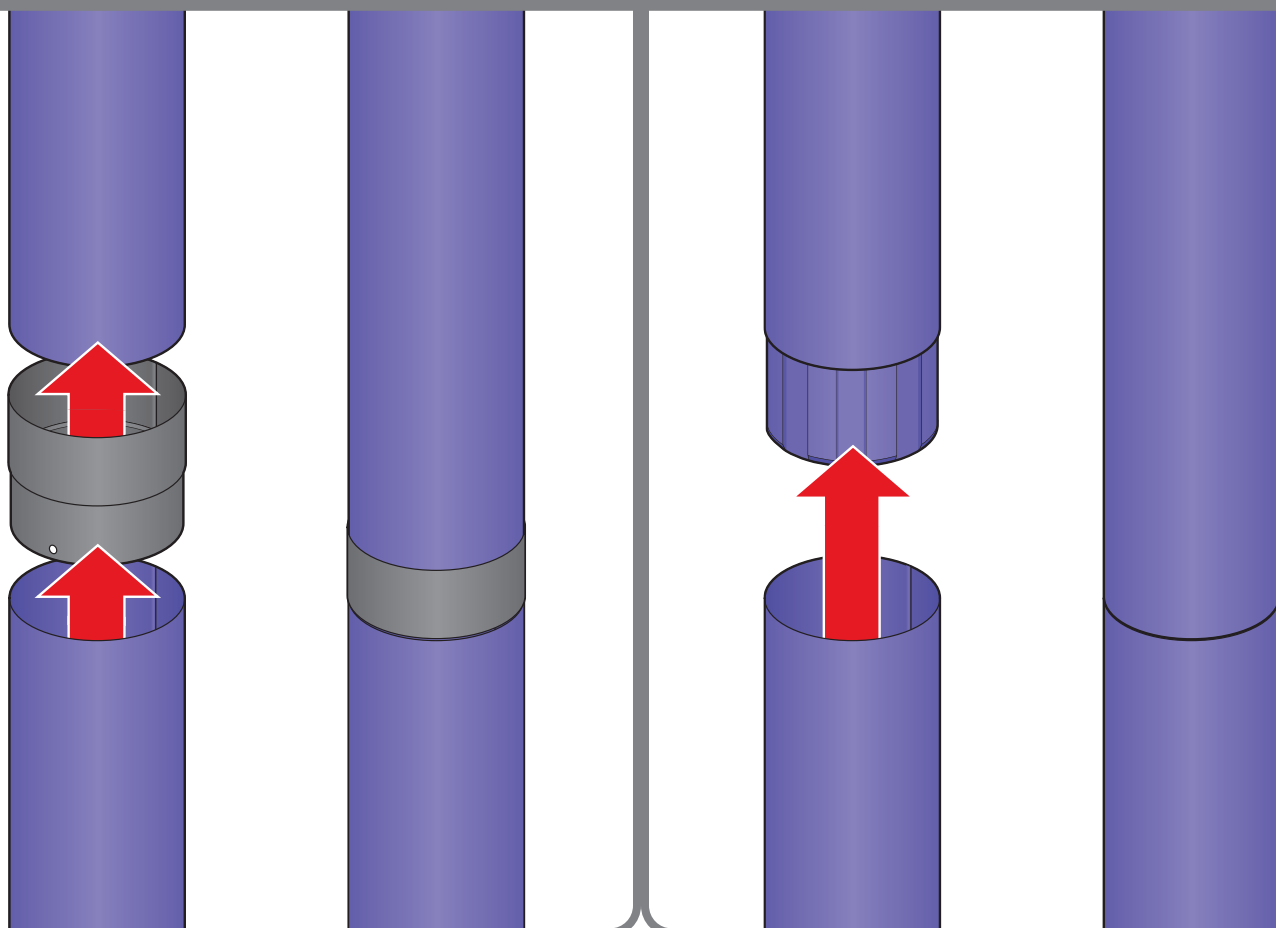

11

Spout assembly

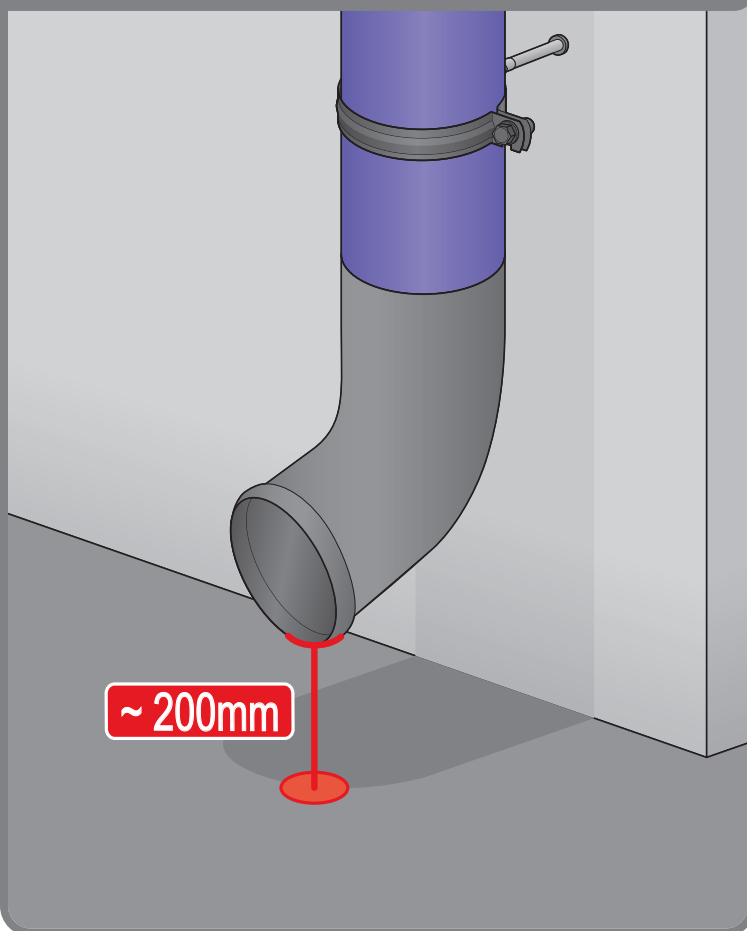
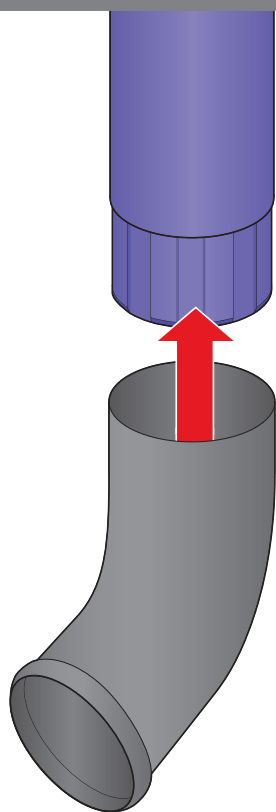

12

Settler assembly

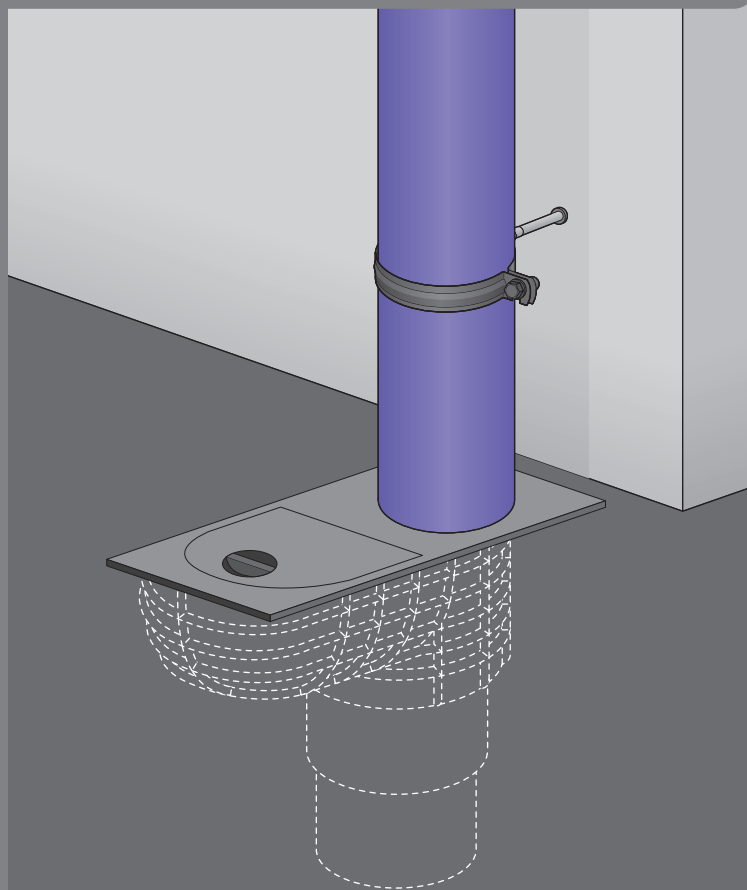
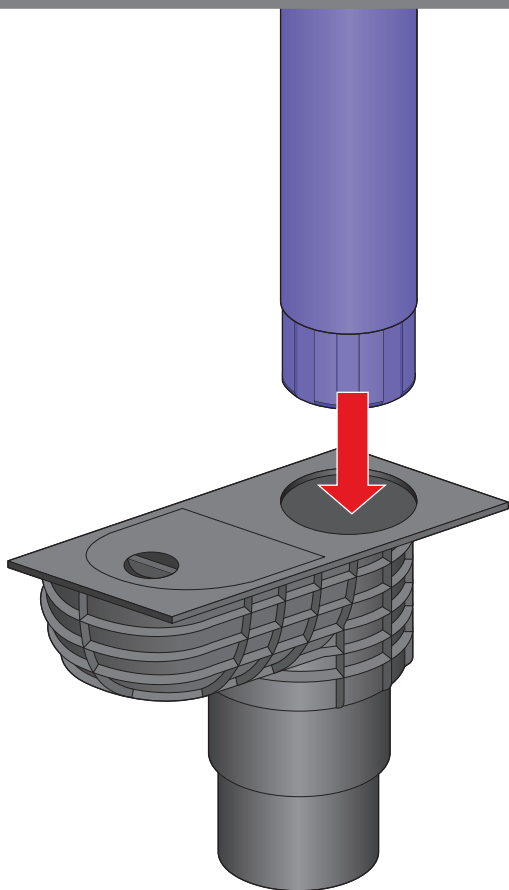

13

Cut the pipe with the hood extended

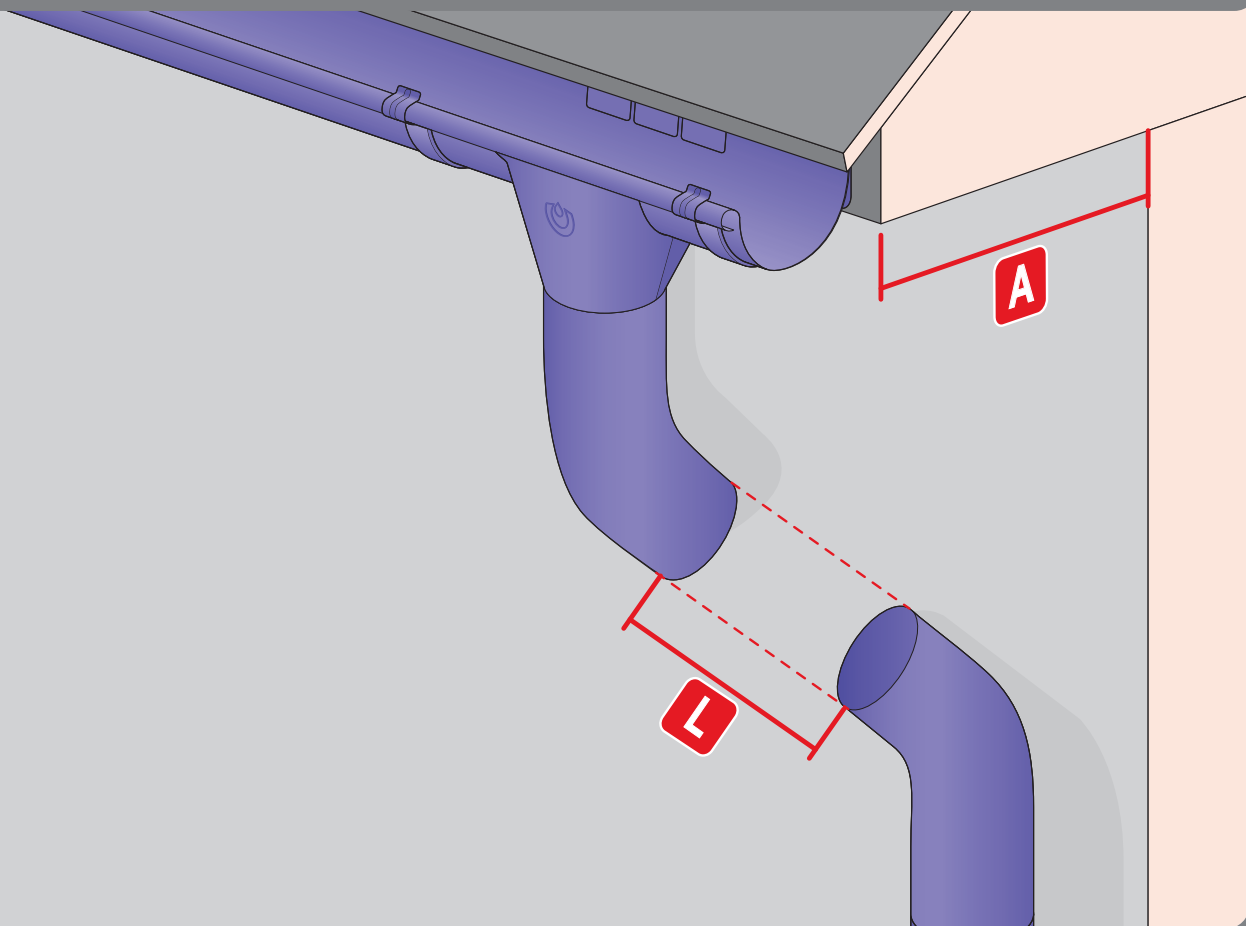



www.kropsystem.eu